

LAND CORNER RECORDATION CERTIFICATE
Filing Requirement of Act 74, Mich. P.A. 1970

Liber **000003** Page **0143**

For corners in "ECHO TWP"

<u>ANTRIM</u> (County)	Located In:	Corner Code #
1. Public Land Survey	<u>T 31N R 7W</u>	<u>G-7</u>
	T <u> </u> R <u> </u>	<u> </u>
	T <u> </u> R <u> </u>	<u> </u>
	T <u> </u> R <u> </u>	<u> </u>
2. Property Controlling in Section	S <u> </u> T <u> </u> R <u> </u>	<u> </u>
	S <u> </u> T <u> </u> R <u> </u>	<u> </u>
3. Miscellaneous Property in Sec.	S <u> </u> T <u> </u> R <u> </u>	<u> </u>
	S <u> </u> T <u> </u> R <u> </u>	<u> </u>

ANTRIM COUNTY MI.
 Register of Deeds
 Recorded

12-21-2000 11:07:40

Manda R. Conway
 REGISTER OF DEEDS

Register of Deeds Stamp & File Number

4. Lot No. _____, Recorded Plat _____

5. Private Claims _____

I, NEIL L. WAY, in a field survey on DEC. 18, 2000 do hereby state that under requirements of P.A. 74, Michigan P.A. of 1970, the corner points mentioned in lines 1 and 2 above were in conformance with regulations and rules therefore as required in the current manual of survey instructions of the United States Department of the Interior, Bureau of Land Management or by a decree of a Court of Law and for that the corner points mentioned in lines 3, 4 and 5 above were in conformance with the rules of the Michigan Board of Land Surveyors or by a Decree of a Court of Law, established, re-established, monumented, recovered, found as expressed below:

NOTE: Not more than 2 corners, all in the same town and range, may be recorded on this certificate.

	A	B	C	D	E	F	G	H	I	J	K	L	M
1													
2	6		5		4		3		2		1		
3													
4	7		8		9		10		11		12		
5													
6	18		17		16		15		14		13		
7							●						
8	19		20		21		22		23		24		
9													
10	30		29		28		27		26		25		
11													
12	31		32		33		34		35		36		
13													

A. Description of original monument and accessories and/or subsequent restoration:

G-7 SE CORNER SEC. 16
 GLO SET HEMLOCK 6" CORNER POST 1857
 BEECH 9 N11 1/2 E 27L
 BEECH 5 S10 1/2 W 17L
 OSTLING #12026, LCR. L 1, P 104, FEB. 7, 1973 FOUND A 3/4" I.P.I.PE.

3. Description of corner evidence found and/or method applied in restoring or reestablishing corner:

G-7 SE CORNER SEC. 16
 FOUND 1" I.P.I.PE AS STATED ABOVE. CORNER IS ON A OLD FENCE LINE TO NORTH AND SOUTH.

**SURVEY &
 REMONUMENTATION**

JAN 28 2001

SECTION

2. Description of monument for corner and accessories established to perpetuate locating the position of the corner:

G-7 SE CORNER SEC. 16
 ACCEPTED 1" I.P.I.PE AS CORNER, REMOVED AND REPLACED WITH COUNTY MONUMENT.
 N15E 20.85' BEECH 20"
 S50E 22.70' W.PINE 14"
 S80W 5.83' MAPLE 14"
 S10W 27.87' MAPLE 12" TRIP
 SOUTH 2.34' I.ROD (HOOKED AT TOP)

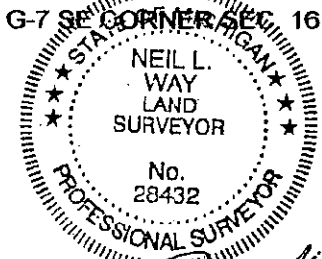

Ratified by Peer Group
 In accordance with
 P.A. 345
 Antrim Co. Chairman

(Signature)

Arthur L. Lennox, P.E., P.S.
 Nov. 28, 2000

Signed by *(Signature)*
 Surveyor's Michigan License No. 28432

Date DEC. 18, 2000