

**SURVEY & REMONUMENTATION**

**FEB 11 1998**

Liber **00002** Page **0421**

**LAND CORNER RECORDATION CERTIFICATE**  
Filing Requirement of Act 74, Mich. P.A. 1970

For corners in **SECTION** CENTRAL LAKE TWP.  
ANTRIM

(County)	Located In:	Corner Code #
1. Public Land Survey $W\frac{1}{4}$ S 15	T <u>31</u> N R <u>8</u> W	<u>G-6</u>
	T <u>   </u> R <u>   </u>	<u>   </u>
	T <u>   </u> R <u>   </u>	<u>   </u>
	T <u>   </u> R <u>   </u>	<u>   </u>
2. Property Controlling in Section	S <u>   </u> T <u>   </u> R <u>   </u>	<u>   </u>
	S <u>   </u> T <u>   </u> R <u>   </u>	<u>   </u>
3. Miscellaneous Property in Sec.	S <u>   </u> T <u>   </u> R <u>   </u>	<u>   </u>
	S <u>   </u> T <u>   </u> R <u>   </u>	<u>   </u>

ANTRIM COUNTY MI.  
Register of Deeds  
Recorded

12-15-1997 08:51:02

Wanda R. Conway  
REGISTER OF DEEDS

Register of Deeds Stamp & File Number

135

4. Lot No. \_\_\_\_\_, Recorded Plat \_\_\_\_\_  
5. Private Claims \_\_\_\_\_

I, NEIL L. WAY, in a field survey on 19 NOV. 19 97 do hereby state that under requirements of P.A. 74, Michigan P.A. of 1970, the corner points mentioned in lines 1 and 2 above were in conformance with regulations and rules therefore as required in the current manual of survey instructions of the United States Department of the Interior, Bureau of Land Management or by a decree of a Court of Law and for that the corner points mentioned in lines 3, 4 and 5 above were in conformance with the rules of the Michigan Board of Land Surveyors or by a Decree of a Court of Law, established, re-established, monumented, recovered, found as expressed below:

NOTE: Not more than 2 corners, all in the same town and range, may be recorded on this certificate.

	A	B	C	D	E	F	G	H	I	J	K	L	M
1													
2		6		5		4		3		2		1	
3													
4		7		8		9		10		11		12	
5													
6		18		17		16	●	15		14		13	
7													
8		19		20		21		22		23		24	
9													
10		30		29		28		27		26		25	
11													
12		31		32		33		34		35		36	
13													

A. Description of original monument and accessories and/or subsequent restoration:

GLO SET BEECH POST ARPIL 1857, BEECH 11 N40E 43, BEECH 11 S12W 33

Ratified by Peer  
Group in accordance  
with P.A. 345  
Antrim Co. Chairman

*Arthur L. Lennox*  
Arthur L. Lennox  
Nov. 18, 1997

B. Description of corner evidence found and/or method applied in restoring or reestablishing corner:

FOUND 1 1/2" IRON PIPE, 2' ABOVE GRADE, ON EXTENDED EAST-WEST FENCE LYING TO EAST & NORTH-SOUTH FENCE LYING TO NORTH

FOUND WIT'S AS RECORDED BY A. LENNOX, L. 365 P.559

- 7" MAPLE N10W 17.5
- 6" MAPLE SOUTH 4.2
- 5" MAPLE WEST 8.3
- 6" CHERRY EAST 28.5

C. Description of monument for corner and accessories established to perpetuate locating the position of the corner:

SET ANTRIM COUNTY MONUMENT, SET AT GRADE

- N15W 17.56' SET NAIL SW/SIDE 10" MAPLE
- N89E 28.84' SET NAIL N/SIDE 12" CHERRY
- S02W 4.46' SET NAIL W/SIDE 12" MAPLE
- S87W 8.69' SET NAIL S/SIDE 8" MAPLE

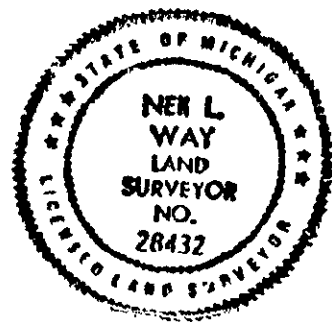

Signed by *Neil L. Way*  
Surveyor's Michigan License No. 28432

Date 24 NOV. 1997