

SURVEY & REMONUMENTATION

MAR 05 1998

ARENAC COUNTY REMONUMENTATION
LAND CORNER RECORDATION CERTIFICATE
Filing Requirement of Act 74, Mich. P.A. 1970

SECTION

For corners in

ARENAC
(County)

Located In:

Corner Code # ROSE SMITH

LC 2/ 130
IP

1. Public Land Survey

T18N R5E

D-9

Page 1 of 1
ARENAC CO. REG. OF DEEDS
RS Rec. Date 12/23/97 Time 11:38
RECORDING FEES: 9.00

2. Property Controlling in Section

S T R

3. Miscellaneous

S T R

Property in Sec.

S T R

Register of Deeds Stamp & File Number

4. Lot No. , Recorded Plat

5. Private Claims

	A	B	C	D	E	F	G	H	I	J	K	L	M
1													
2	6		5		4		3		2		1		
3													
4	7		8		9		10		11		12		
5													
6	18		17		16		15		14		13		
7													
8	19		20		21		22		23		24		
9													
10	30		29		28		27		26		25		
11													
12	31		32		33		34		35		36		
13													

I, MICHAEL J. MACDONALD, in a field survey on OCTOBER 23, 1997 do hereby state that under requirements of P.A. 74, Michigan P.A. of 1970, the corner points mentioned in lines 1 and 2 above were in conformance with regulations and rules therefore as required in the current manual of survey instructions of the United States Department of the Interior, Bureau of Land Management or by a decree of a Court of Law and for that the corner points mentioned in lines 3, 4 and 5 above were in conformance with the rules of the Michigan Board of Land Surveyors or by a Decree of a Court of Law; established, re-established, monumented, recovered, found as expressed below:

NOTE: Not more than 2 corners, all in the same town and range, may be recorded on this certificate.

A. Description of original monument and accessories and/or subsequent restoration:

D-9

1. ORIGINAL POST SET BY J. BURT D.S. JULY 1843
CEDAR 8" S 35°W 31 LINKS
CEDAR 8" N 2°W 23 LINKS

2. LCRC L 1, P 159 (3/81) MUELLER FOUND RAILROAD SPIKE, SET RAILROAD SPIKE 14.38' SSW BASED ON PLAT OF BOURDEAUX SUBDIVISION. NE 89.94° PP, SE 42.18° CENTER OF CABLE MARKER, NW 38.57' CHISELED ARROW IN CULVERT PIPE. SEVERAL OTHER SURVEYS BY MUELLER USED THIS CORNER. L. 1, P. 440; L.1, P.442; L.1, P. 488, L.1, P.449

3. SURVEY, UNRECORDED, 1963 (GOSS) FOUND RAILROAD SPIKE AND 5/8" BAR, SW 86.35' TO SERVICE POLE, NE 77.9 TO PP

ACCEPTED BY THIS ARENAC COUNTY SURVEY PEER GROUP AS THE OFFICIAL CORNER UNDER MICHIGAN PUBLIC ACT 345 OF 1990 AT "A" MEETING HELD ON 10/30/97
Paul M. Ciosek
PAUL M. CIOSEK P.S., CHAIRMAN

B. Description of corner evidence found and/or method applied in restoring or reestablishing corner:

D-9

SEARCHED THE APPARENT LOCATION OF THE CORNER AND FOUND A RAILROAD SPIKE, 3/8" REROD AND 1/2" REROD. EXCAVATED UNDER THE 1/2" REROD TO A DEPTH OF 29" TO CLAY GRADE AND FOUND NO OTHER OBJECTS. THE 1/2" REROD APPEARS TO BE IN THE POSITION OF THE SET RAILROAD SPIKE BY MUELLER IN LCRC L. 1, P. 159. WITNESSES VERIFY THE LOCATION. EXCAVATED UNDER THE FOUND 3/8" REROD AND FOUND NOTHING. THERE IS NO RECORDED INFORMATION OF THIS CORNER BEING USED. EXCAVATED UNDER THE FOUND RAILROAD SPIKE (THE RAILROAD SPIKE CALLED FOR IN MUELLERS LCRC, L. 1, P. 159, SSW 14.38' R., SSW 14.31' M.) AND FOUND ANOTHER RAILROAD SPIKE AT 15". UNDER THIS RAILROAD SPIKE WAS FOUND A 3/4" BAR. AT 24" BELOW THE ROAD SURFACE FOUND FIVE 3/4" PIPES RANGING FROM 8"-10" LONG AROUND THE 3/4" BAR. AT 28" BELOW THE ROAD SURFACE FOUND THAT THE 3/4" BAR ENTERED A WOOD POST. WOOD POST IS WELL PRESERVED. ACCEPTED 3/4" BAR IN WOOD POST AS THE BEST AVAILABLE EVIDENCE OF THE POSITION OF THE ORIGINAL CORNER.

C. Description of monument for corner and accessories established to perpetuate locating the position of the corner:

D-9

DROVE DOWN THE 3/4" BAR AND PLACED 5/8" REROD x 24" LONG REROD WITH ARENAC CO. REMONUMENTATION CAP WITH 1/8" DRILL HOLE.
N 45° E 77.98' N/T E. FACE PP (77.9 R 1963)
S 5° W 14.3' FND 1/2" REROD
S 5.20' FOUND 3/8" REROD
S 45° W 78.80' FND SPIKE W. FACE CEDAR POST
S 15° E 46.97' N. FACE STOP SIGN POST

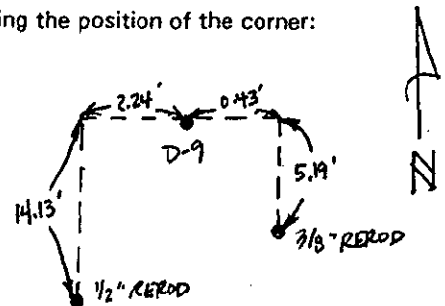

Signed by Michael J. MacDonald

Surveyor's Michigan License No. 22438

FIELD BOOK 2, PAGE 58-59

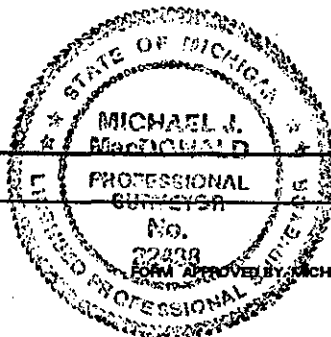

Date 20 Dec 97