

MICHIGAN
DEPARTMENT OF CONSERVATION
FORESTRY DIVISION

LAND CORNER RECORD

T. 46-47 N.R. 34W

Baraga COUNTY

DESCRIPTION OF CORNER 1/4 corner between Section 2 & 35

CORNER MONUMENT 1" I.D. x 36" iron pipe with 4" aluminum cap

DATE MONUMENT PLACED AND WITNESSED August 29, 1968

WITNESSES TO CORNER..... Hemlock 12 N49W 52 lks. "1/4S NBT"

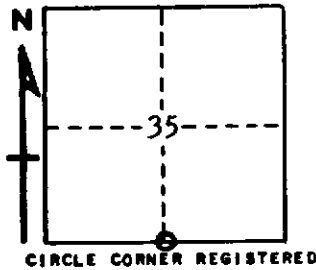

Red Maple 15 S44E 37½ lks. "1/4S NBT"

AND

DESCRIPTION IN DETAIL AS TO HOW CORNER WAS LOCATED AND IDENTIFIED OR RESTORED.

Monument placed at site of a 1" I.D. x 36" iron pipe with 2" brass cap set by Northern Paper Mills personnel probably in early 1950's. Latter monument had been set from an original BT, Cedar 10 N28E 30, now down and in poor condition, no scribe marks visible but faces and axe marks distinguishable. Scribe marks may have been there when Northern Paper Mills monument was set. No trace of other BT, but there are many old line blazes in the vicinity.

Northern Paper Mills had rewitnessed corner as follows:

Hemlock 12 N55E 28 lks. "1/4S, S35, BT"
Yellow Birch 12 S11W 33 lks. "1/4S, S2, BT"

Names of persons present when monument was placed: A. O. Enger, J. E. Hulkonen, and W. A. Dellies.

SURVEYOR'S SEAL

SIGNED Arthur O. Enger DATE 11/26/68
REGISTERED LAND SURVEYOR