

MICHIGAN
DEPARTMENT OF CONSERVATION
FORESTRY DIVISION

LAND CORNER RECORD

T. 47 N.R. 33-34W

Baraga COUNTY

DESCRIPTION OF CORNER Sec. cor. common to secs. 18-19-13-24

CORNER MONUMENT 1" pipe with 4" Aluminum cap.

DATE MONUMENT PLACED AND WITNESSED 3/15/66

WITNESSES TO CORNER..... 9" Balsam (S18 NBT) N30°E, 13.5'

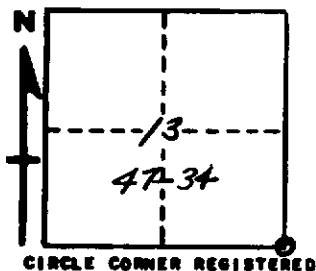

8" B. Spruce (S24 NBT) S23°E, 23.0'

6" B. Spruce (S13 NBT) N45°W, 45.5'

AND

DESCRIPTION IN DETAIL AS TO HOW CORNER WAS LOCATED AND IDENTIFIED OR RESTORED.

Replaced corner at wood post. Found two probably bearing trees, down and in poor condition; S37°W, 21 links and N28°E, 14 Links. Corner lies in low, wet ground.

SURVEYOR'S SEAL

SIGNED Billy O. Buckler DATE 2/8/67
REGISTERED LAND SURVEYOR