

**LAND CORNER RECORDATION CERTIFICATE**  
**Filing Requirement of Act 74, Mich. P.A. 1970 as Amended**

For corners in

Baraga

(County)

Located In:

Corner Code #

- |                                    |                           |            |
|------------------------------------|---------------------------|------------|
| 1. Public Land Survey              | T <u>48N</u> R <u>33W</u> | <u>K11</u> |
|                                    | T _____ R _____           | _____      |
|                                    | T _____ R _____           | _____      |
| 2. Property Controlling in Section | S _____ T _____ R _____   | _____      |
|                                    | S _____ T _____ R _____   | _____      |
| 3. Miscellaneous Property in Sec.  | S _____ T _____ R _____   | _____      |
|                                    | S _____ T _____ R _____   | _____      |

Register of Deeds Stamp & File Number

4. Lot No. \_\_\_\_\_, Recorded Plat \_\_\_\_\_  
 5. Private Claims \_\_\_\_\_

Jun 07 2005

I, Stephan J. Szyszkoski, in a field survey on \_\_\_\_\_, 20\_\_\_\_ do hereby state that under requirements of P.A. 74, Michigan P.A. of 1970, the corner points mentioned in lines 1 and 2 above were in conformance with regulations and rules therefore as required in the current manual of survey instructions of the United States Department of the Interior, Bureau of Land Management or by a decree of a Court of Law and /or that the corner points mentioned in lines 3, 4 and 5 above were in conformance with the rules of the Michigan Board of Land Surveyors or by a Decree of a Court of Law; established, re-established, monumented, recovered, found as expressed below:

**NOTE: Not more than 2 corners, all in the same town and range, may be recorded on this certificate.**

A. Description of original monument and accessories and/or subsequent restoration:

(K11) Corner common to Sections 25-26-35-36. 1851 - Established by Francis Houck, Deputy Surveyor: N9'W Corrected between Sections 35 and 36 ...79.90 Corner of Sections 25-26-35-36. Fir 10 N45W 24 links, Fir S60E 6 links.

1	A	B	C	D	E	F	G	H	I	J	K	L	M
2	6	5	4	3	2	1							
3													
4	7	8	9	10	11	12							
5													
6	18	17	16	15	14	13							
7													
8	19	20	21	22	23	24							
9													
10	30	29	28	27	26	25							
11													
12	31	32	33	34	35	36							
13													

B. Description of corner evidence found and/or method applied in restoring or reestablishing corner:

(K11) The original post and accessories were not recovered. Reestablished the corner by double proportionate measurement to the original record between Section corner 5266.80' East (rec. 80.05 chains), Quarter corner 2631.61' South (rec. 39.95 chains), Quarter corner 2627.79' West (rec. 39.94 chains), and Section corner 10526.42' North (rec. 159.80 chains). The position for the corner falls on the edge of a large mostly-subsurface boulder. The monument could not be installed in a vertical position at this location. It leans to the NE. The top center of the cap marks the position for the corner.

C. Description of monument for corner and accessories established to perpetuate locating the position of the corner:

(K11) Set 1"IDx32" I.pipe with 4" alum. MDNR cap. Set measuring nails in:  
 8" Sugar S84E 20.0' wrkd "S36 NBT"  
 7" Sugar S05W 7.0' "S35 NBT"  
 10" Y.Birch S69W 21.4' "S35 NBT"  
 11" Y.Birch N40W 15.1' "S26 NBT"  
 Set sq'd sugar post adjacent. Bearings are magnetic. Distances are to nail with tag. Monument leans to NE. The top center marks the corner position.

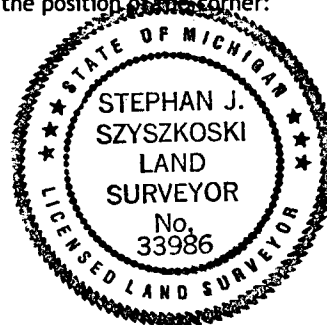

Signed by Stephan J. Szyszkoski  
 Surveyor's Michigan License No. 33986

Date 7/27/05

For the Michigan Department of Natural Resources, Office of Land and Facilities