

LAND CORNER RECORDATION CERTIFICATE
Filing Requirement of Act 74, Mich. P.A. 1970 as Amended

For corners in

<u>Baraga</u> (County)	Located In:	Corner Code #
1. Public Land Survey	T 49N R 34W	G11
	T 49N R 34W	H9
	T _____ R _____	_____
	S _____ T _____ R _____	_____
2. Property Controlling in Section	S _____ T _____ R _____	_____
	S _____ T _____ R _____	_____
3. Miscellaneous Property in Sec.	S _____ T _____ R _____	_____
	S _____ T _____ R _____	_____

Register of Deeds Stamp & File Number

4. Lot No. _____, Recorded Plat _____
 5. Private Claims
 H9 Jul 19 2004
 G11 Jun 28 2004

I, Stephan J. Szyszkoski, in a field survey on _____, 20____ do hereby state that under requirements of P.A. 74, Michigan P.A. of 1970, the corner points mentioned in lines 1 and 2 above were in conformance with regulations and rules therefore, as required in the current manual of survey instructions of the United States Department of the Interior, Bureau of Land Management or by a decree of a Court of Law and /or that the corner points mentioned in lines 3, 4 and 5 above were in conformance with the rules of the Michigan Board of Land Surveyors or by a Decree of a Court of Law; established, re-established, monumented, recovered, found as expressed below:

NOTE: Not more than 2 corners, all in the same town and range, may be recorded on this certificate.

1	A	B	C	D	E	F	G	H	I	J	K	L	M
2		6		5		4		3		2		1	
3													
4		7		8		9		10		11		12	
5													
6		18		17		16		15		14		13	
7													
8		19		20		21		22		23		24	
9													
10		30		29		28		27		26		25	
11													
12		31		32		33		34		35		36	
13													

A. Description of original monument and accessories and/or subsequent restoration:

(G11) Corner common to Sections 27-28-33-34. K.L.Sackett RLS, 5-22-75, reestablished at location of old rotted post. Set 1"IDx36" I.pipe with 4" aluminum cap. 7" Spruce S78W 7.4', 14" R.Pine N29W 41.5', 9" R.Pine N31E 46.8'.
 (H9) Quarter corner common to Sections 22-27. 1971: A.O.Enger RLS, remonumented the corner at a found tamarack post point, described in the 1971 record as probably the remains of the original post. Set 1"IDx36" I.pipe with 4" aluminum cap. 6" B.Spruce S54E 22.1', 6" B.Spruce S85W 36.8', 5" Tamarack S14W 32.3'.

B. Description of corner evidence found and/or method applied in restoring or reestablishing corner:

(G11) Found the 1975 monument in good condition and at record bearing and distance from the 1975 witnesses recovered as follows: The R.Pines NE and NW are now cut stumps, the witness J.Pine is in good condition but is actually a Tamarack with double overgrown blazes. Left the monument in place and made new witnesses as described below.
 (H9) Recovered the 1971 monument in good condition and at record bearing and distance from the 1971 witnesses. The B.Spruce SE is in good condition with scribing visible. The Tamarack SW is in good condition with overgrown blazes. The B.Spruce SW was not recovered. The 1"x24" iron pipe noted in the 1971 LCRC (recorded in 1973), was found S65E 0.8' from the corner monument.

C. Description of monument for corner and accessories established to perpetuate locating the position of the corner:

(G11) Found 1"ID I.pipe with 4" alum. MDNR cap. Blazed, scribed, and set measuring nails in: 8" Tamarack S81W 7.7' 1975 wit. 4" W.Pine N41E 28.3' "S27 NBT" 8" B.Spruce S05W 17.1' "S33 NBT" 7" Tamarack N55W 34.8' "S28 NBT" A sq'd B.Spruce post is adjacent. Bearings are magnetic. Distances are to nail with tag.	(H9) Found 1"ID I.pipe with 4" alum. MDNR cap. Blazed, scribed, and set measuring nails in: 6" Tamarack N45W 23.9' "1/4S NBT" 7" J.Pine N46E 13.8' do 7" B.Spruce S51E 22.4' scribing vis. * 8" Tamarack S19W 32.5' old blazes * A sq'd cedar post is adjacent. Bearings are magnetic. Distances are to nail with tag. * denotes 1971 NBT.
---	--

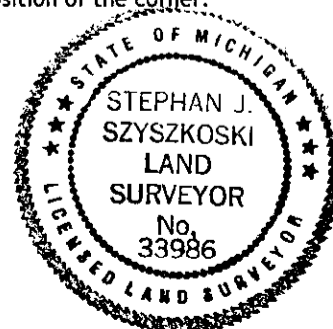

Signed by Stephan J. Szyszkoski
 Surveyor's Michigan License No. 33986

Date 10/12/04