

LAND CORNER RECORDATION CERTIFICATE
Filing Requirement of Act 74, Mich. P.A. 1970 as Amended

For corners in

<u>Baraga</u> (County)	Located In:	Corner Code #
1. Public Land Survey	T <u>49NR 33W</u>	<u>G11</u>
	T <u>49NR 33W</u>	<u>G12</u>
	T _____ R _____	_____
2. Property Controlling in Section	S _____ T _____ R _____	_____
	S _____ T _____ R _____	_____
3. Miscellaneous Property in Sec.	S _____ T _____ R _____	_____
	S _____ T _____ R _____	_____

Register of Deeds Stamp & File Number

4. Lot No. _____, Recorded Plat _____
 5. Private Claims _____
 G12 Oct 12 2005
 G11 Aug 31 2005

A	B	C	D	E	F	G	H	I	J	K	L	M
1												
2	6	5	4	3	2	1						
3												
4	7	8	9	10	11	12						
5												
6	18	17	16	15	14	13						
7												
8	19	20	21	22	23	24						
9												
10	30	29	28	27	26	25						
11												
12	31	32	33	34	35	36						
13												

I, Stephan J. Szyszkoski, in a field survey on _____, 20____ do hereby state that under requirements of P.A. 74, Michigan P.A. of 1970, the corner points mentioned in lines 1 and 2 above were in conformance with regulations and rules therefore as required in the current manual of survey instructions of the United States Department of the Interior, Bureau of Land Management or by a decree of a Court of Law and /or that the corner points mentioned in lines 3, 4 and 5 above were in conformance with the rules of the Michigan Board of Land Surveyors or by a Decree of a Court of Law; established, re-established, monumented, recovered, found as expressed below:

NOTE: Not more than 2 corners, all in the same town and range, may be recorded on this certificate.

A. Description of original monument and accessories and/or subsequent restoration:

(G11) Corner common to Sections 27-28-33-34. 1852 - Established by Zelotes Searles, Deputy Surveyor: "North corrected between sections 33-34 ...79.98 Set post corner of sections 27-28-33-34. Y. Birch 12 S35E 35 links, Sugar 12 N61W 38 links". Dec. 8, 1941 - Notes by N.T.Thompson RLS found at Northern Hardwoods office in Bovine, MI: "Set iron pipe New B.T. [illegible] Elm 14 N52W 30'9", [illegible] 5 S43W 28'10", Sug 7 S8E 25'." Further undated notes by unknown in same collection: "See page 43-A NIT reversed angle on Y.Br. BT" and (on page 43-A) "Reversed made it S35W set Bal post look good there is no other reading on this Birch size now 16". "

(G12) Quarter corner common to Sections 33-34. 1852 - Established by Zelotes Searles, Deputy Surveyor: "North corrected between Sections 33-34 ...39.99 Set quarter section post. Y. Birch 20 S50E 35 links, Y. Birch 10 N54W 29 links. ...79.98 Section corner". Aug. 27, 1940 - Notes of N.T.Thompson, RLS, found at Northern Hardwoods office in Bovine, MI state: "1/4 bet. 33 & 34. B.T. Bir 24" dead. Set Bal post." July 29, 1941 - same note collection states: "Iron pipe New B.T. Sug 10 N85W 28'2", Y.Bir 16 N68E 12'4". "

B. Description of corner evidence found and/or method applied in restoring or reestablishing corner:

(G11) The original post and accessories were not recovered. Found a 1" ID iron pipe, projecting 2 feet, set firm, with adjacent rotting squared cedar post. The 1941 Sugar NBT S8E is in good condition and at record bearing and distance. Recovered root holes at record bearing and distance for the NBT Elm. I could not be sure about the cryptic references to the reversed bearing but presume that Mr. Thompson discovered that the record GLO bearing to the Y. Birch BT was not correct. I accept the pipe as the best available evidence of the position of the original corner. Left it in place and made new witnesses.

(G12) The original post and accessories were not recovered. Found a 1-5/8" ID iron pipe, disturbed and laying nearly horizontally with base in ground and top nearly severed. Found 10" Sugar S42W with Ford Motor Co. location tag facing. No sign of the Y.Birch NBT. Found a clump of Sugars at record bearing and distance for the N85W 28'2" Sugar which may have propagated from the 1941 NBT. The area has been heavily disturbed. Straightened and drove the pipe at its likely original position and determined its position to be 0.1' north and 1.1' west of a point midway and on line between Section corners G11 and G13. Accepted same as the best available evidence of the position of the original corner.

C. Description of monument for corner and accessories established to perpetuate locating the position of the corner:

(G11) Found 1" ID I.pipe. Set measuring nails in:	(G12) Found 1 5/8" ID iron pipe. Set measuring nails in:
12" Sugar S02E 25.1' mrkd "S34 NBT" *	9" Sugar S61E 16.8' mrkd "1/4S NBT"
8" Sugar N40E 6.8' "S27 NBT"	10" Sugar S42W 16.4' do
5" Sugar S80W 15.4' "S33 NBT"	8" Sugar N84W 26.7' do
5" Sugar N35W 20.9' "S28 NBT"	6" Sugar N05W 9.2' do
Set sq'd cedar post adjacent. Bearings are magnetic. Distances are to nail with tag. * denotes 1941 NBT.	Set sq'd cedar post adjacent. Bearings are magnetic. Distances are to nail with tag.

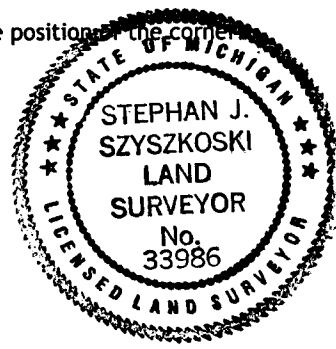

Signed by Stephan J. Szyszkoski
 Surveyor's Michigan License No. 33986

Date 2/29/06