

MICHIGAN  
DEPARTMENT OF CONSERVATION  
FORESTRY DIVISION

# LAND CORNER RECORD

T. 50 N.R. 34-35N

Baraga COUNTY

DESCRIPTION OF CORNER Section Corner common to Sections 19-30-24-25

CORNER MONUMENT 1" Pipe with 4" Brass Cap

DATE MONUMENT PLACED AND WITNESSED 5-16-61 with Duane St. Ours

WITNESSES TO CORNER..... 16" Red Pine (S24 NBT) N30°W 140 links

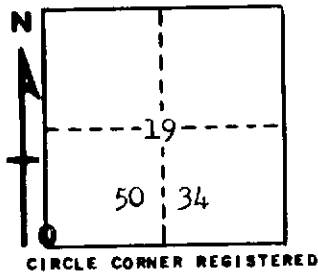

6" Aspen (S19 NBT) N39°E 25 links

6" Aspen (S30 NBT) S40°E 30 links

AND

**DESCRIPTION IN DETAIL AS TO HOW CORNER WAS LOCATED AND IDENTIFIED OR RESTORED.**

This corner was re-established by single proportionate measure along N-S Township line, using Corners  $\frac{1}{2}$  mile North and 1 mile South.  
No evidence of Original Corner.

**SURVEYOR'S SEAL**

SIGNED Billy D. Buckler DATE December 28, 1961  
REGISTERED LAND SURVEYOR  
Billy D. Buckler