

SURVEY & REMONUMENTATION

SEP 13 1994

COMMISSION
For corners in **BARRY**
(County)

BARRY COUNTY REMONUMENTATION
LAND CORNER RECORDATION CERTIFICATE
Filing Requirement of Act 74, Mich. P.A. 1970

STATE OF MICHIGAN
COUNTY OF BARRY
RECEIVED FOR RECORD

MAR 16 4 24 PM '94

Sandy Schindelmarer
REGISTER OF DEEDS

002183

Register of Deeds Stamp & File Number

Located In: _____ Corner Code # _____

T 1N R 7W B-13
T ASSYRIA TWNSP.
T 1/4 COR. SEC. 31 ON TOWN LINE

1. Public Land Survey _____

2. Property Controlling in Section S _____ T _____ R _____
S _____ T _____ R _____

3. Miscellaneous Property in Sec. S _____ T _____ R _____
S _____ T _____ R _____

4. Lot No. _____, Recorded Plat _____

5. Private Claims _____

	A	B	C	D	E	F	G	H	I	J	K	L	M
2	6		5		4		3		2		1		
3													
4	7		8		9		10		11		12		
5													
6	18		17		16		15		14		13		
7													
8	19		20		21		22		23		24		
9													
10	30		29		28		27		26		25		
11													
12	31		32		33		34		35		36		
13													

I, **BRIAN REYNOLDS**, in a field survey on **JAN 10**, 19 **94**, do hereby certify that under requirements of P.A. 74, Michigan P.A. of 1970, the corner points mentioned in lines 1 and 2 above were in conformance with regulations and rules therefore as required in the current manual of survey instructions of the United States Department of the Interior, Bureau of Land Management or by a decree of a Court of Law and/or that the corner points mentioned in lines 3, 4 and 5 above were in conformance with the rules of the Michigan Board of Land Surveyors or by a Decree of a Court of Law; established, re-established, monumented, re-monumented, recovered, found as expressed below:

NOTE: Not more than 4 corners, all in the same town and range, may be recorded on this certificate.

A. Description of original monument and accessories and/or subsequent restoration:

- **GENERAL LAND OFFICE: JOHN MULLET D.S., 1825 (R7W, Pg. 3)**
A W. OAK - 14 - N82 1/2E - 31; Do. - 14 - N53 1/2W - 84.
- **BOWEN 27JAN1876, (L.1, Pg.133) : FOUND STAKE:**
W. O. - 26 - N84E - 31 - IRON; W. O. - 20 - N53W - 84

B. Description of corner evidence found and/or method applied in restoring or reestablishing corner:

-FOUND 1/2" PIPE IN CONCRETE SURROUNDED BY TWO 2' x 2' STONES AND MANY SMALLER STONES AND CROCKERY.

ACT 345 BARRY COUNTY REMONUMENTATION
APPROVED BY PEER REVIEW AT A MEETING HELD ON
JAN 12, 1994 BR
BRIAN REYNOLDS COUNTY SURVEYOR

C. Description of monument for corner and accessories established to perpetuate locating the position of the corner:

- **1/2" PIPE IN CONCRETE:**
N&T - S. SIDE - 25" EASTERLY TRUNK OF TWIN OAK - WEST - 17.66'
N&T - E. SIDE - UTILITY POLE - S15W - 26.17'
N&T - W. SIDE - 15" OAK - S25E - 47.63'
N&T - N. SIDE - 16" NORTHWESTERLY TRUNK OF TWIN OAK - EAST - 47.97'
1'+/- NORTH OF EAST/WEST WIRE FENCE
1'+/- NORTH OF AND 2'+/- WEST OF 1' DIAMETER WOOD FENCE/GATE POST

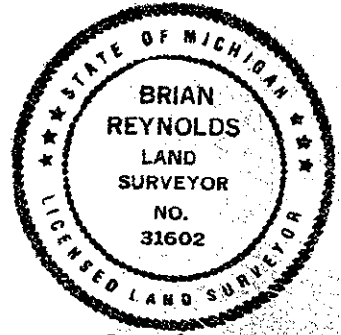

Signed by [Signature] Date FEB 28, 1994
Surveyor's Michigan License No. 31602