

APR 10 1994

COMMISSION

BARRY COUNTY REMONUMENTATION  
LAND CORNER RECORDATION CERTIFICATE  
Filing Requirement of Act 74, Mich. P.A. 1970

STATE OF MICHIGAN  
COUNTY OF BARRY  
RECEIVED FOR RECORD  
DEC 14 8 54 AM '93

BARRY  
(County)

Located In: Corner Code #

Sandy Schindelmarper  
REGISTER OF DEEDS

002163

Register of Deeds Stamp & File Number

Public Land Survey

T 1N R 9W A-2  
T BARRY TOWNSHIP  
T W1/4 POST SEC. 6

Property Controlling  
in Section  
Miscellaneous  
Property in Sec.

S T R  
S T R  
S T R  
S T R

Lot No. \_\_\_\_\_, Recorded Plat \_\_\_\_\_  
Private Claims \_\_\_\_\_

	A	B	C	D	E	F	G	H	I	J	K	L	M
2	6	5	4	3	2	1							
3													
4	7	8	9	10	11	12							
5													
6	18	17	16	15	14	13							
7													
8	19	20	21	22	23	24							
9													
10	30	29	28	27	26	25							
11													
12	31	32	33	34	35	36							
13													

BRIAN REYNOLDS in a field survey on JUL 19 93

hereby certify that under requirements of P.A. 74, Michigan P.A. of 1970, the corner points mentioned in lines 1 and 2 above were in conformance with regulations and rules therefore as required in the current manual of survey instructions of the United States Department of the Interior, Bureau of Land Management or by a decree of a Court of Law and/or that the corner points mentioned in lines 3, 4 and 5 above were in conformance with the rules of the Michigan Board of Land Surveyors or by a Decree of a Court of Law, established, re-established, monumented, re-monumented, recovered, found as expressed below:

NOTE: Not more than 4 corners, all in the same town and range, may be recorded on this certificate.

Description of original monument and accessories and/or subsequent restoration:

- NOT SET BY G.L.O.
- PRATT (06 SEP 1888) (Pg. 333 COUNTY SURVEYORS NOTES) IN A MAP OF SURVEY IN THE NW1/4 OF SEC. 6, BARRY TOWNSHIP. PRATT SHOWS A JOG BETWEEN A-2, T1N, R9W & M-2, T1N, R10W OF 3.67ch. = 242.22ft. . PRATT ALSO SHOWS A DISTANCE OF 47.45ch. = 3131.7ft. FOR A-1, T1N, R9W TO A-2, T1N, R9W.
- WAYLAND INGERSOLL (NOV. DEC. 1967) "SET IRON ROD AT W1/4 POST BY PULLING THE RECORD GOV'T JOG ( NOT SET BY G.L.O. - INGERSOLL MUST MEAN PRATT'S JOG ) FROM THE E1/4 POST OF PRAIRIEVILLE TWP. THIS FITS THE OLD FENCE LINE GOOD." (SEE BACK OF THIS FORM FOR WIT.)
- LARRY G. WATSON (27 FEB 1973) (L.C.R.C. #114) FOUND 1/2" IRON SET BY WAYLAND INGERSOLL (NOV. 1967); (SEE BACK OF THIS FORM FOR WIT.)

Description of corner evidence found and/or method applied in restoring or reestablishing corner:

- FOUND 1/2" IRON . CHECKED WELL WITH WITNESSES ON LCRC #114.
- DISTANCE A-1, T1N, R9W TO FOUND 1/2" IRON = 3129.98'; CHECKS WITHIN REASON WITH PRATT'S DISTANCE A-1 TO A-2 T1N, R9W (3131.7')
- FOUND CLAY TILE 241.63' NORTH; CHECKS WELL WITH PRATT'S JOG (242.22').
- 1/2" IRON FOUND WAS ASSUMED TO BE INGERSOLL'S IRON.
- IRON IS 0.60' EAST OF TOWNSHIP LINE.
- BY PEER GROUP INSTRUCTION FOUND 1/2" IRON WAS LEFT IN PLACE TO CONTROL DIRECTION OF EAST - WEST 1/4 LINE OF SECTION 6, BARRY TOWNSHIP.
- REMONUMENTATION MONUMENT WAS PLACED WEST OF FOUND IRON AND ON TOWNSHIP LINE.

Description of monument for corner and accessories established to perpetuate locating the position of the corner:

- |   |   |
|---|---|
| FOUND 1/2" IRON - RESET 3/4" IRON PIN:    | SET BARRY Co. MONUMENT:                           |
| - NW. SIDE - UTIL. POLE - N39E - 34.17'   | - NW. SIDE UTIL. POLE - N39E - 34.42'             |
| - E. FACE - 10" OAK - N18E - 38.89'       | - E. SIDE - 10" OAK - N18E - 38.97'               |
| - S. FACE - 12" OAK - S80W - 24.46'       | - S. FACE - 12" OAK - S80W - 23.97'               |
| - N. FACE - 18" TWIN OAK - S78E - 26.15'  | - N. FACE - 18" TWIN OAK - S78E - 26.67'          |
| - NW. COR. HSE. #10551 - S16E - 37.82'    | - NW. COR. HSE. # 10551 - S16E - 38.09'           |
| - +/- 9' E. C/L PRIVATE DRIVE TO N. ;     | - PRAIRIEVILLE TOWNSHIP MON. (M-2) - N. - 241.63' |
| - +/- 15' N. C/L PRIVATE DRIVE TO E.      |   |
| - 1/2" IRON (LOT COR.) - S80W - 20.32'    |   |
| - 1/2" IRON (LOT COR.) - S20W - 57.08'    |   |
| - SEC. COR. M-2, T1N, R10W - N. - 241.63' |   |

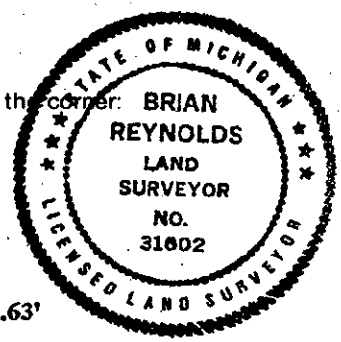

Surveyed by: [Signature] Surveyor's Michigan License No. 31602

Date: DECEMBER 10, 1993