

SURVEY & REMONUMENTATION

SEP 13 1994

**BARRY COUNTY REMONUMENTATION
LAND CORNER RECORDATION CERTIFICATE
Filing Requirement of Act 74, Mich. P.A. 1970**

STATE OF MICHIGAN
COUNTY OF BARRY
RECEIVED FOR RECORD

MAR 16 4 24 PM '94

Sandy Schondelmarer
REGISTER OF DEEDS

002187

Register of Deeds Stamp & File Number

For corners in
**COMMISSION
BARRY**
(County)

Located In: Corner Code #

1. Public Land Survey
T IN R 9W F-5
T BARRY TWNSP.
T 1/4 COR. SEC. 9 & 16
T _____ R _____
2. Property Controlling in Section
S _____ T _____ R _____
S _____ T _____ R _____
3. Miscellaneous Property in Sec.
S _____ T _____ R _____
S _____ T _____ R _____
4. Lot No. _____, Recorded Plat _____
5. Private Claims _____

	A	B	C	D	E	F	G	H	I	J	K	L	M
2	6	5	4	3	2	1							
3													
4	7	8	9	10	11	12							
5													
6	18	17	16	15	14	13							
7													
8	19	20	21	22	23	24							
9													
10	30	29	28	27	26	25							
11													
12	31	32	33	34	35	36							
13													

I, **BRIAN REYNOLDS**, in a field survey on **07 MAR**, 19 **93**, do hereby certify that under requirements of P.A. 74, Michigan P.A. of 1970, the corner points mentioned in lines 1 and 2 above were in conformance with regulations and rules therefore as required in the current manual of survey instructions of the United States Department of the Interior, Bureau of Land Management or by a decree of a Court of Law and/or that the corner points mentioned in lines 3, 4 and 5 above were in conformance with the rules of the Michigan Board of Land Surveyors or by a Decree of a Court of Law; established, re-established, monumented, re-monumented, recovered, found as expressed below:

NOTE: Not more than 4 corners, all in the same town and range, may be recorded on this certificate.

- A. Description of original monument and accessories and/or subsequent restoration:
 - **GENERAL LAND OFFICE: SYLVESTER SIBLEY D.S., 1826 (R9W, Pg. 30)**
WEST CORRECTED 39.82ch. - A B. OAK - 18 - S2E - 17 ; Do. - 22 - N44E - 44.
 - **DON DAVIS: P.S. # 17617, 2/12/92: SURVEY FOR MR. STEWART WATERS; JOB# 8686:**
5/8" IRON: FENCE SOUTH, EAST, WEST.
28" OAK - EAST - 11.9'
24" MAPLE - S30E - 38.6'

B. Description of corner evidence found and/or method applied in restoring or reestablishing corner:

-FOUND 1/2" IRON AND WITNESSES MATCHING THOSE OF DON DAVIS, ACCEPTED 1/2" IRON AS PERPETUATION OF THE 1/4 CORNER.

ACT 345 BARRY COUNTY REMONUMENTATION
APPROVED BY PEER REVIEW AT A MEETING HELD ON
MARCH 1, 1994 *BR*
BRIAN REYNOLDS COUNTY SURVEYOR

C. Description of monument for corner and accessories established to perpetuate locating the position of the corner:

- SET BARRY Co. REMONUMENTATION MONUMENT:**
 - **SMALL NAIL & RIBBON - SE. FACE - 28" OAK - EAST - 11.9'**
 - **SMALL NAIL & RIBBON - E. FACE - 24" MAPLE - S30E - 38.6'**
 - **CENTER - 2" DIAMETER STEEL FENCE CORNER - SOUTH - 0.55'**
 - **N&T - E. FACE - 5" BLACK CHERRY - S18E - 3.54'**
 - **N&T - N. FACE - 9" BLACK CHERRY - S63E - 31.41'**
 - **N&T - W. FACE - 10" BLACK CHERRY - S20W - 18.00'**
 - **N&T - SE. FACE - 8" HICKORY - S57W - 31.23'**

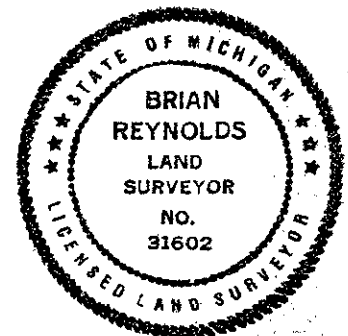

Signed by *Brian Reynolds*
Surveyor's Michigan License No. 31602

Date MARCH 8, 1994