

SURVEY & REMONUMENTATION

BARRY COUNTY REMONUMENTATION

FEB 17 1998

LAND CORNER RECORDATION CERTIFICATE
Filing Requirement of Act 74, Mich. P.A. 1970

SECTION

For Corners in **BARRY**
(county)

Located In:

Corner Cr



Sandy Schondelmayer - Barry Co. LCRCR

2664

Page: 1 of 1
12/19/1997 07:49A

1. Public Land Survey
CENTER OF SECTION 23
BARRY TOWNSHIP

T 1N R 9W J-8
T _____ R _____
T _____ R _____
T _____ R _____

2. Property Controlling in Section

S _____ T _____ R _____
S _____ T _____ R _____

3. Miscellaneous Property in Sec.

S _____ T _____ R _____
S _____ T _____ R _____

4. Lot No. _____, Recorded Plat _____
5. Private Claims _____

I, **Brian Reynolds**, in a field survey on **10 AUGUST, 1997** do hereby certify that under requirements of P.A. 74, Michigan P.A. of 1970, the corner points mentioned in lines 1 and 2 above were in conformance with regulations and rules therefore as required in the current manual of survey instructions of the United States Department of the Interior, Bureau of Land Management or by a decree of a Court of Law and/or that the corner points mentioned in lines 3, 4, and 5 above were in conformance with the rules of the Michigan Board of Land Surveyors or by a Decree of a Court of Law; established, re-established, monumented, re-monumented, recovered, found as expressed below.

NOTE: Not more than 2 corners, all in the same town and range, may be recorded on this certificate.

A. Description of original monument and accessories and/or subsequent restoration:

- 1. **THIS CORNER WAS NOT SET BY THE GENERAL LAND OFFICE.**
- 2. **UNRECORDED SURVEY BY RAYMOND MOORED, P.S. #26463, JOB #96-1026, 12-5-96, "CENTER FD IRON" (NO WITNESSES)**

***** NO OTHER HISTORICAL INFORMATION, PUBLIC OR PRIVATE, AVAILABLE FOR THIS CORNER *****

B. Description of corner evidence found and/or method applied in restoring or reestablishing corner:

FOUND REMONUMENTATION IRON PLACED BY MOORED (SET OVER 2 IRONS APPARENTLY FROM AN OLD PIECE OF FARM MACHINERY), ALSO FOUND AN OLD 3/4" IRON APPARENTLY REPRESENTING 1/8 CORNER 1/4 MILE WEST. FOUND STAKE & STONE AT K-8 AS REFERRED TO IN SURVEY BY FRANK BOWEN (L.1, P.238). LOCATION OF FOUND STONE, REMONUMENTATION IRON AND OLD 1/8 CORNER IRON CONFIRM ONE ANOTHER. ACCEPTED FOUND REMONUMENTATION IRON, PLACED BY MOORED, AS BEST AVAILABLE EVIDENCE OF CORNER LOCATION AS PER OLD SURVEY NOT OF RECORD.

C. Description of monument for corner and accessories established to perpetuate locating the position of the corner:

SET STANDARD BARRY COUNTY REMONUMENTATION MONUMENT (3/4" X 36" IRON) WITH ALUMINUM CAP. FOUND NAIL W/ REMON TAG IN THE WEST SIDE OF AN 8" BLACK WALNUT S8°E 12.95' FOUND NAIL W/ REMON TAG IN THE NORTH SIDE OF A 38" BLACK WALNUT S78°E 35.82' FOUND NAIL W/ REMON TAG IN THE NORTHWEST SIDE OF A 22" MAPLE N38°E 42.08' FOUND NAIL W/ REMON TAG IN THE NORTHEAST SIDE OF A 60" OAK N38°W 53.21' SOUTHEAST CORNER OF THE STONE FOUNDATION TO HOUSE #2500 N71°E 107.74' CORNER LIES 6'+/- WEST OF FENCE LINE RUNNING SOUTH 8'+/- SOUTH OF EAST-WEST GRAVEL CENTERLINE 6'+/- EAST OF CENTERLINE GRAVEL ROAD NORTH

ACT 345 BARRY COUNTY REMONUMENTATION APPROVED BY PEER REVIEW AT A MEETING HELD ON

13 Oct. 97
BRIAN REYNOLDS

BR
COUNTY SURVEYOR

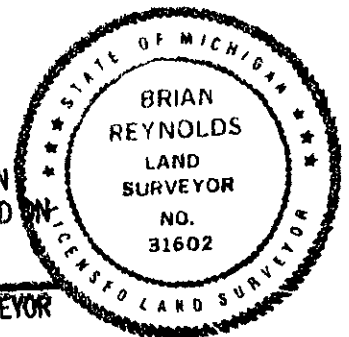

	A	B	C	D	E	F	G	H	I	J	K	L	M
1													
2	6	5	4	3	2	1							
3													
4	7	8	9	10	11	12							
5													
6	18	17	16	15	14	13							
7													
8	19	20	21	22	24								
9													
10	30	29	28	27	26	25							
11													
12	31	32	33	34	35	36							
13													

Signed by **BR**
Surveyor's Michigan License No **31602**

Date **Dec 18, 1997**