

**SURVEY & REMONUMENTATION**

SEP 13 1994

**BARRY COUNTY REMONUMENTATION LAND CORNER RECORDATION CERTIFICATE**  
 Filing Requirement of Act 74, Mich. P.A. 1970

STATE OF MICHIGAN  
 COUNTY OF BARRY  
 RECEIVED FOR RECORD

MAR 16 4 24 PM '94

For corner in **COMMISSION BARRY**  
 (County)

Located In: Corner Code #

Sandy Schindelmarjer  
 REGISTER OF DEEDS

**002191**

Register of Deeds Stamp & File Number

- 1. Public Land Survey T 2N<sub>R</sub> 8W C-7  
 T BALTIMORE TWP.  
 T COR. SEC. 17, 18, 19, & 20  
 T   R
- 2. Property Controlling S    T    R     
 in Section S    T    R
- 3. Miscellaneous S    T    R     
 Property in Sec. S    T    R
- 4. Lot No. \_\_\_\_\_, Recorded Plat \_\_\_\_\_
- 5. Private Claims \_\_\_\_\_

**BRIAN REYNOLDS** **MARCH 6** **94**

I, \_\_\_\_\_, in a field survey on \_\_\_\_\_, 19\_\_\_\_, do hereby certify that under requirements of P.A. 74, Michigan P.A. of 1970, the corner points mentioned in lines 1 and 2 above were in conformance with regulations and rules therefore as required in the current manual of survey instructions of the United States Department of the Interior, Bureau of Land Management or by a decree of a Court of Law and/or that the corner points mentioned in lines 3, 4 and 5 above were in conformance with the rules of the Michigan Board of Land Surveyors or by a Decree of a Court of Law; established, re-established, monumented, re-monumented, recovered, found as expressed below:

A	B	C	D	E	F	G	H	I	J	K	L	M
2	6	5	4	3	2	1						
3												
4	7	8	9	10	11	12						
5												
6	18	17	16	15	14	13						
7		⊕										
8	19	20	21	22	23	24						
9												
10	30	29	28	27	26	25						
11												
12	31	32	33	34	35	36						
13												

**NOTE: Not more than 4 corners, all in the same town and range, may be recorded on this certificate.**

- A. Description of original monument and accessories and/or subsequent restoration:  
 -GENERAL LAND OFFICE: (MUSGROVE EVANS D.S., 1826, R8W, Pg. 81) SET POST & TOOK WITNESSES: W. ASH - 12 - N19E - 26lks.; Be. -10 - S51W - 33lks.  
 -A.C. WILLSON (26 JUN 1876) (COUNTY SURVEYOR RECORDS : VOL. 2, Pg. 167 - 169) FOUND CORNER TO BE OBLITERATED; REESTABLISHED THROUGH: TESTIMONY OF "Mr. PULASKI PIERCE" ( ADJACENT LANDOWNER); TESTIMONY OF "Mr. WEEKS" (SURVEYOR); FOUND STUMP AGREEING WITH FIELDS NOTES IN SIZE, KIND OF TIMBER, COURSE, & DISTANCE OF WITNESS; & TESTIMONY OF OTHERS WHICH WERE PRESENT. SET STONE & OTHER MATERIALS. NO WITNESSES TAKEN.  
 -BOWEN (19 OCT 1876) (Co. SURVEYOR RECORDS VOL. 1, Pg.169) FOUND CORNER. TOOK WITNESS: W. ASH STUMP - 30 - N22E - 14.

- B. Description of corner evidence found and/or method applied in restoring or reestablishing corner:  
 -REYNOLDS (AUG 92): FOUND 1" PIPE. 1/8 LINE AND 1/4 LINE OCCUPATION MEASUREMENTS NORTH AND WEST CONFIRMED LOCATION, ACCEPTED PIPE AS PERPETUATION OF WILLSON'S RESTORATION.  
 REYNOLDS - AUG 92: FOUND 1" PIPE:  
 ACCEPTED AS PERPETUATION OF TRUE CORNER.  
 N&T - 7" - BOX ELDER - S30E - 21.77'  
 N&T - 11" - BOX ELDER - S15W - 22.79'  
 N&T - 12" - BOX ELDER - S45W - 47.59'  
 N&T - UTIL. POLE #6970 - N60W - 92.67'  
 1' +/- - S. - C/L PRITCHARDVILLE Rd.

ACT 345 BARRY COUNTY REMONUMENTATION  
 APPROVED BY PEER REVIEW AT A MEETING HELD ON  
FEBRUARY 1, 1994 BR  
 BRIAN REYNOLDS COUNTY SURVEYOR

- C. Description of monument for corner and accessories established to perpetuate locating the position of the corner:  
 - FOUND 1" PIPE AS PER REYNOLDS' (92) WITNESSES: (PIPE NOT EASILY REMOVED. PLACED REMONUMENTATION CAP ON 1" PIPE) ; 0.6' BELOW GRADE.  
 ACCEPTED AS PERPETUATION OF TRUE CORNER.  
 N&T (ORANGE "REYNOLDS" TAG) - NW FACE - 7" - BOX ELDER - S30E - 21.77'  
 N&T (STEEL WASHER) - NE FACE - 11" - BOX ELDER - S15W - 22.79'  
 N&T (ORANGE "REYNOLDS" TAG) - N. FACE - 12" - BOX ELDER - S45W - 47.59'  
 N&T (ORANGE "REYNOLDS" TAG) - SE. FACE - UTIL. POLE #6970 - N60W - 92.67'  
 Co. N&T - NW. FACE - 10" ELM - N50E - 74.13'  
 SE. CORNER OF MICH. BELL TELE. BOX #7000 - N45W - 56.51'  
 1' +/- - S. - C/L PRITCHARDVILLE Rd.

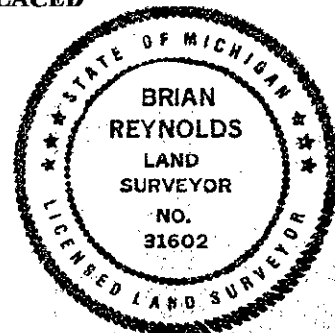

Signed by [Signature] Date MARCH 8, 1994  
 Surveyor's Michigan License No. 31602