

DEC 7 2 40 PM '93

Sandy Schondelmarer  
REGISTER OF DEEDS

002106

LAND CORNER RECORDATION CERTIFICATE  
Filing Requirement of Act 74, Mich. P.A. 1970

For corners in  
Barry County  
(County)

Located In: Corner Code #

1. Public Land Survey

T 3N	R 7W	A-13
ALSO T 2N	R 8W	M-1
ALSO T 2N	R 7W	A-1
ALSO T 3N	R 8W	M-13

2. Property Controlling  
in Section

S T R  
S T R  
S T R  
(Common to above  
Section corners)

3. Miscellaneous  
Property in Sec.

S T R  
S T R  
S T R

Register of Deeds Stamp & File Number

4. Lot No. Recorded Plat

5. Private Claims

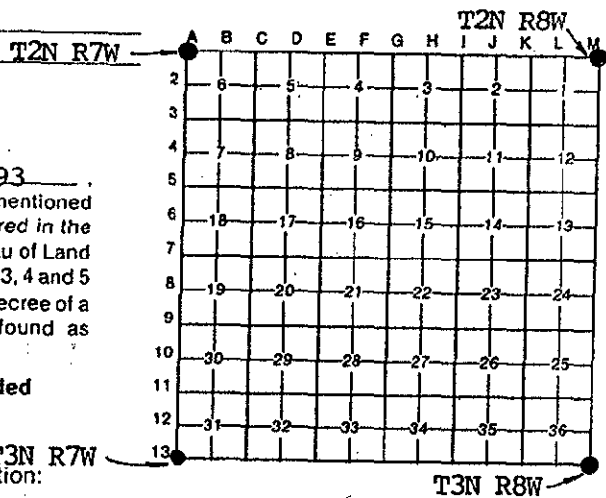

I, Kenneth C. Brandt in a field survey on November 6, 19 93, do hereby certify that under requirements of P.A. 74, Michigan P.A. of 1970, the corner points mentioned in lines 1 and 2 above were in conformance with regulations and rules therefore as required in the current manual of survey instructions of the United States Department of the Interior, Bureau of Land Management or by a decree of a Court of Law and/or that the corner points mentioned in lines 3, 4 and 5 above were in conformance with the rules of the Michigan Board of Land Surveyors or by a Decree of a Court of Law; established, re-established, monumented, re-monumented, recovered, found as expressed below:

NOTE: Not more than 4 corners, all in the same town and range, may be recorded on this certificate.

A. Description of original monument and accessories and/or subsequent restoration:

GLO: Tamarack, 12" N. 64½° E. 81 L  
White Oak, 9" N. 35½° W. 98 L

Conc. mon. 2' N. of fence corner  
8" cherry with blaze E. 97'

¾" pipe - East 100' (in fence)

LCRC #238 (4/7/78 - DeKeyser & Assoc.)

LCRC #317 (9/22/81) - Mueller) S.W. corner of Prudden's Subdivision (1.5, p. 46)

B. Description of corner evidence found and/or method applied in restoring or reestablishing corner:

Found conc. mon. (2' N. of corner of Prudden's Subdivision)

Fd. ¾" pipe in fence, 100 feet East

Fd. large stone against rotted wood fence corner, broken off

Found conc. mon. 166 feet East in fence.

SURVEY &  
REMONUMENTATION

APR 05 1994

COMMISSION

C. Description of monument for corner and accessories established to perpetuate locating the position of the corner:

Set ¾" Iron Pin and Aluminum Remon. Cap with punch mark in submerged corner post stub, 2.00 feet South of Conc. mon. & 166.00 feet West of conc. plat monument.

Nail and Barry County Shiners set as follows:

S. side of 10" Maple, N. 55° W. 11.84 feet

W. side of 8" Black Ash, Due South 27.24 feet

SE side of 10" Black Ash, N. 75° E. 11.83 feet

Fence rows running N, E, S & W.



Signed by Kenneth C. Brandt

Date 11/10/93

Surveyor's Michigan License No. 24587