

MAY 20 1997

COMMISSION

BARRY COUNTY REMONUMENTATION LAND CORNER RECORDATION CERTIFICATE Filing Requirement of Act 74, Mich. P.A. 1970

STATE OF MICHIGAN COUNTY OF BARRY RECEIVED

DEC 9 2 10 PM '96

Sandy Schorlemmer REGISTER OF DEEDS

For corners in

<u>BARRY</u> (County)	Located In:	Corner Code #
1. Public Land Survey	T <u>2NR 9W</u>	<u>B-13</u>
1/4 CORNER COMMON TO	T ___ R ___	_____
SEC. 31	T ___ R ___	_____
HOPE TWP.	T ___ R ___	_____
2. Property Controlling in Section	S ___ T ___ R ___	_____
	S ___ T ___ R ___	_____
3. Miscellaneous Property in Sec.	S ___ T ___ R ___	_____
	S ___ T ___ R ___	_____

002435

Register of Deeds Stamp & File Number

4. Lot No. _____, Recorded Plat _____
5. Private Claims _____

I, RAYMOND MOORED, in a field survey on MAY, 1995 do hereby state that under requirements of P.A. 74, Michigan P.A. of 1970, the corner points mentioned in lines 1 and 2 above were in conformance with regulations and rules therefore as required in the current manual of survey instructions of the United States Department of the Interior, Bureau of Land Management or by a decree of a Court of Law and/or that the corner points mentioned in lines 3, 4 and 5 above were in conformance with the rules of the Michigan Board of Land Surveyors or by a Decree of a Court of Law; established, re-established, monumented, recovered, found as expressed below:

NOTE: Not more than 2 corners, all in the same town and range, may be recorded on this certificate.

	A	B	C	D	E	F	G	H	I	J	K	L	M
1													
2	6		5		4		3		2		1		
3													
4	7		8		9		10		11		12		
5													
6	10		17		16		15		14		13		
7													
8	19		20		21		22		23		24		
9													
10	30		29		28		27		26		25		
11													
12	31		32		33		34		35		36		
13													

A. Description of original monument and accessories and/or subsequent restoration:

G.L.O. JOHN MULLETT D.S. 1826 (R9W, P.53) W. OAK 15 N. 40 1/2 E. 76. DO 12 N.56.W. 96. PRATT BROWN HOPE TWP. F.B, P.5 (REYNOLDS TRANSCRIPTIONS) (BROWN BARRY TWP.F.B, P.86) HICKORY 7 N.9DEG. 30'E. 39 IRON STAKE. PT OF BEGINNING 18" HICKORY NE 61.6' 10" SASSAFRAST NW 52.9' (#609 MILLER RD, PG.3). LCRC # 107-LARRY WATSON, PS # 12447 REC 2-19-74 FD NAIL PER OLD INFO BY INGERSOLL 1958 26" HICKORY N. 10DEG. 26.00' 12" OAK S.20DEG.W. 39.22' 15" OAK S.20"E 35.89' (ACT 132 SURVEY L.1,P.160-161) 2-19-1974 LARRY G. WATSON RLS # 12447. (ACT 132 SURVEY L.1, P.709) ROBERT R. CARR RLS #20704 MARCH 31, 1982

B. Description of corner evidence found and/or method applied in restoring or reestablishing corner:

FOUND 1/2" IRON PER WITS ABOVE ACCEPTED AS BEST AVAILABLE EVIDENCE OF CORNER LOCATION. SET STANDARD BARRY COUNTY REMON IRON W/CAP.

ACT 345 BARRY COUNTY REMONUMENTATION APPROVED BY PEER REVIEW AT A MEETING HELD ON 10 April '95 BRIAN REYNOLDS COUNTY SURVEYOR

C. Description of monument for corner and accessories established to perpetuate locating the position of the corner:

SET STANDARD BARRY COUNTY REMON IRON W/CAP -CENTERLINE GRAVEL ROAD SOUTH 2.5' -NAIL IN W. SIDE 25" HICKORY N. 5DEG. E. 25.88' -NAIL IN SE SIDE 10" ASH N45DEG. E. 34.05' -NAIL IN NW SIDE 20" RED OAK S 40DEG. E. 35.00' -NAIL IN NW SIDE 16" RED OAK S 30DEG. W. 37.90'

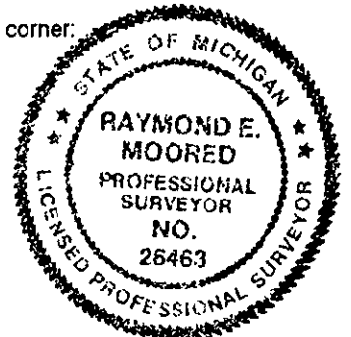

Signed by Raymond Moored
Surveyor's Michigan License No. 26463

Date 11/4/96