

SURVEY & REMONUMENTATION

1993

COMMISSION

BARRY COUNTY REMONUMENTATION LAND CORNER RECORDATION CERTIFICATE
 Filing Requirement of Act 74, Mich. P.A. 1970

STATE OF MICHIGAN
 COUNTY OF BARRY
 RECEIVED FOR RECORD

JUL 20 11 20 AM '93

Sandy Schondelmaier
 REGISTER OF DEEDS

For corners in BARRY
 (County)

Located In: Corner Code #

- 1. Public Land Survey T2N R9W C-9
 T ___ R ___ HOPE TWPSP.
 T ___ (COR. SEC. 19 - 20 - 29 - 30)
 T ___ R ___
- 2. Property Controlling in Section S ___ T ___ R ___
 S ___ T ___ R ___
- 3. Miscellaneous Property in Sec. S ___ T ___ R ___
 S ___ T ___ R ___

002038

Register of Deeds Stamp & File Number

- 4. Lot No. _____, Recorded Plat _____
- 5. Private Claims _____

	A	B	C	D	E	F	G	H	I	J	K	L
2	6	5	4	3	2	1						
3												
4	7	8	9	10	11	12						
5												
6	18	17	16	15	14	13						
7												
8	19	20	21	22	23	24						
9												
10	30	29	28	27	26	25						
11												
12	31	32	33	34	35	36						
13												

I, **BRIAN REYNOLDS**, in a field survey on MAY, 1993, do hereby certify that under requirements of P.A. 74, Michigan P.A. of 1970, the corner points mentioned in lines 1 and 2 above were in conformance with regulations and rules therefore as required in the current manual of survey instructions of the United States Department of the Interior, Bureau of Land Management or by a decree of a Court of Law and/or that the corner points mentioned in lines 3, 4 and 5 above were in conformance with the rules of the Michigan Board of Land Surveyors or by a Decree of a Court of Law; established, re-established, monumented, re-monumented, recovered, found as expressed below:

NOTE: Not more than 4 corners, all in the same town and range, may be recorded on this certificate.

A. Description of original monument and accessories and/or subsequent restoration:

- G. L. O.:** **GLAZA (1988) FOUND 1" IRON PIPE: RECORDED IN LCRC # 388:**
W OAK 10 N64 1/2E 45 NAIL IN W. SIDE 10" OAK N05E 11.6'
W OAK 7 S51W 57 NAIL IN E. SIDE 30" OAK S45W 15.8'
39.73CH. BETWEEN D-9 & C-9 NAIL IN N. SIDE 20" OAK S60E 24.3'

MITCHELL (L.L.S. #19618)(1980) USED POINTED STONE
DILLINGHAM (L.L.S. #19927)(1980) USED POINTED STONE
BOTH "MITCHELL & DILLINGHAM" SHOW SAME WITNESSES ON DRAWINGS:
18" OAK NNW 36.0'; 32" OAK SSW 39.1'; 28" OAK SE 34.8'

B. Description of corner evidence found and/or method applied in restoring or reestablishing corner:

FOUND POINTED STONE WITH ERODED CHISELED "X" AS PER "MITCHELL & DILLINGHAM" DISREGARDED LCRC #388 BY "GLAZA"

C. Description of monument for corner and accessories established to perpetuate locating the position of the corner:

- SET BARRY Co. REMON. MONUMENT:**
40 D NAIL - BARRY Co. SHINER - E. FACE - 30" OAK - N05W - 36.43'
" " " " - NW. FACE - 12" ASH - S40W - 20.63"
FOUND DOUBLE HEADED NAIL - SW. FACE - 36" OAK - S45W - 33.83'
" " " " - NW. FACE - 36" OAK - S20W - 38.53'
GLAZA'S 1" PIPE IN LCRC # 388 - S53E - 32.73'
11' +/- W. OF N-S. FENCE; 30' +/- N. OF E-W. FENCE

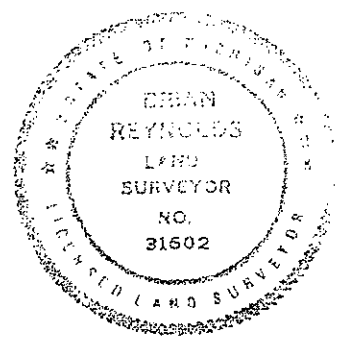

Signed by Brian Reynolds Date 7-13-91
 Surveyor's Michigan License No. 31602