

SURVEY & REMONUMENTATION

1993

COMMISSION

**BARRY COUNTY REMONUMENTATION
LAND CORNER RECORDATION CERTIFICATE
Filing Requirement of Act 74, Mich. P.A. 1970**

STATE OF MICHIGAN
COUNTY OF BARRY
RECEIVED FOR RECORD

JUL 20 11 21 AM '93

Sandy Schondelmar
REGISTER OF DEEDS

For corners in

<u>BARRY</u> (County)	Located In:	Corner Code #/
1. Public Land Survey	T <u>2N</u> R <u>9W</u>	<u>D-8</u>
	T _____ R _____	<u>HOPE</u>
	T _____ R _____	_____
	T _____ R _____	_____
2. Property Controlling in Section	S _____ T _____ R _____	_____
	S _____ T _____ R _____	_____
3. Miscellaneous Property in Sec.	S _____ T _____ R _____	_____
	S _____ T _____ R _____	_____
4. Lot No. _____, Recorded Plat _____		
5. Private Claims _____		

002036

Register of Deeds Stamp & File Number

I, BRIAN REYNOLDS, in a field survey on JULY, 19 93, do hereby certify that under requirements of P.A. 74, Michigan P.A. of 1970, the corner points mentioned in lines 1 and 2 above were in conformance with regulations and rules therefore as required in the current manual of survey instructions of the United States Department of the Interior, Bureau of Land Management or by a decree of a Court of Law and/or that the corner points mentioned in lines 3, 4 and 5 above were in conformance with the rules of the Michigan Board of Land Surveyors or by a Decree of a Court of Law: established, re-established, monumented, re-monumented, recovered, found as expressed below:

A	B	C	D	E	F	G	H	I	J	K	L	M
2	6	5	4	3	2	1						
3												
4	7	8	9	10	11	12						
5												
6	13	17	16	15	14	13						
7												
8	19	21	22	23	24							
9												
10	30	29	28	27	26	25						
11												
12	31	32	33	34	35	36						
13												

NOTE: Not more than 4 corners, all in the same town and range, may be recorded on this certificate.

A. Description of original monument and accessories and/or subsequent restoration:

NOT SET BY GENERAL LAND OFFICE SURVEY. SEE PREVIOUS RECORDING DATA ON BACK OF FORM.

OF THE NUMEROUS SURVEYS IN SECTION 20 RECORDED IN THE COUNTY SURVEYOR'S NOTES, THE CENTER 1/4 CORNER IS NEVER SPECIFICALLY MENTIONED. HOWEVER, SURVEYS BY COBB AND PRATT MENTION THE SOUTH 1/16 CORNER OF THE NORTHWEST 1/4, IMPLYING THAT THE CENTER WAS EXTANT AT THAT TIME (1890'S).

A NOTATION IN THE COUNTY SURVEYOR'S BOOKS (L.2, P. 299) BY HENRY J. DAVIES, REGISTERED CIVIL ENGINEER, APRIL 16, 1942, "FOUND IRON PIPE" 20" HICKORY S40E 70.1'

B. Description of corner evidence found and/or method applied in restoring or reestablishing corner: 20" HICKORY S85E 27.8'

FOUND 1" IRON PIPE AT INTERSECTION OF ROADS.

FOUND PIPE IS THE SAME AS PREVIOUSLY RECORDED BY GLAZA AND REYNOLDS. FOUND PIPE IS BELIEVED TO BE THE SAME AS FOUND BY DAVIES (1942) AND SAME AS USED BY ROGERS FOR NUMEROUS SURVEYS.

ACCEPTED AS BEST EVIDENCE OF CORNER.

ACCEPTED CORNER IS 0.57' WEST OF A LINE FROM D-7 TO D-9 AND 10.52' NORTH OF A LINE FROM C-8 TO E-8.

C. Description of monument for corner and accessories established to perpetuate locating the position of the corner:

REPLACED 1" PIPE WITH STANDARD 3/4" REMONUMENTATION IRON AND ALUMINUM CAP.
40D NAIL AND WITNESS TAG IN N'LY SIDE OF 10" EVERGREEN, S88°E, 26.91'
40D NAIL AND WITNESS TAG IN NE'LY SIDE OF 24" HICKORY, S30°E, 54.73'
40D NAIL AND WITNESS TAG IN SE'LY SIDE OF 10" EASTERLY MAPLE IN CLUSTER, S60°W, 93.99'
SW CORNER OF BRICK PLANTER S45°E, 62.24'
CENTER OF TELEPHONE RISER, N10°W, 86.08'
±4' EAST OF CENTERLINE TO THE NORTH
±6' NORTH OF CENTERLINE TO THE WEST

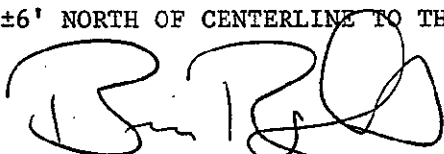

Signed by _____ Date JULY 19, 1993
Surveyor's Michigan License No. 31602

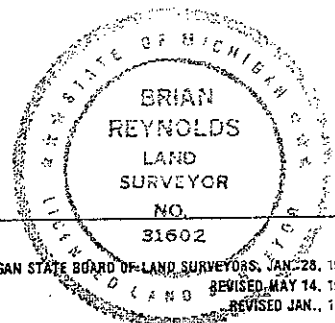

PART "A" (CONTINUED)

LAND CORNER RECORDATION CERTIFICATE #388 (EDWARD J. GLAZA, 1988)

FOUND 1" IRON PIPE IN ROAD INTERSECTION

NW CORNER HSE (NOT PLANTER) S80°E 56.6'
NAIL IN E. SIDE P. POLE S20°W 96.8'
NAIL IN E. SIDE P. POLE N20°W 84.7'

LAND CORNER RECORDATION CERTIFICATE #422 (REYNOLDS, 1990)

FOUND 1" PIPE

10" EVERGREEN S88E 26.91'
24' HICKORY S30E 54.73'
10" MAPLE IN CLUSTER S60W 93.99'
4± E OF C/L N
6± N OF C/L W