

SURVEY & REMONUMENTATION

AUG 31 1994

COMMISSION
For corners in **BARRY**
(County)

BARRY COUNTY REMONUMENTATION
LAND CORNER RECORDATION CERTIFICATE
Filing Requirement of Act 74, Mich. P.A. 1970

STATE OF MICHIGAN
COUNTY OF BARRY
RECEIVED FOR RECORD

JUL 8 12 42 PM '94

Sandy Schondelmarer
REGISTER OF DEEDS

002200

Register of Deeds Stamp & File Number

- Located In: _____ Corner Code: ## _____
- T 2N R 10W H-6
ORANGEVILLE TOWNSHIP
INTERIOR 1/4 COR. SEC. 15
1. Public Land Survey _____
2. Property Controlling in Section
S _____ T _____ R _____
S _____ T _____ R _____
3. Miscellaneous Property in Sec.
S _____ T _____ R _____
S _____ T _____ R _____
4. Lot No. _____, Recorded Plat _____
5. Private Claims _____

I, **BRIAN REYNOLDS**, in a field survey on **05 APR**, 19 **94**, do hereby certify that under requirements of P.A. 74, Michigan P.A. of 1970, the corner points mentioned in lines 1 and 2 above were in conformance with regulations and rules therefore as required in the current manual of survey instructions of the United States Department of the Interior, Bureau of Land Management or by a decree of a Court of Law and/or that the corner points mentioned in lines 3, 4 and 5 above were in conformance with the rules of the Michigan Board of Land Surveyors or by a Decree of a Court of Law; established, re-established, monumented, re-monumented, recovered, found as expressed below:

NOTE: Not more than 4 corners, all in the same town and range, may be recorded on this certificate.

A	B	C	D	E	F	G	H	I	J	K	L	M
2	6	5	4	3	2	1						
3												
4	7	8	9	10	11	12						
5												
6	18	17	16	15	14	13						
7												
8	19	20	21	22	23	24						
9												
10	30	29	28	27	26	25						
11												
12	31	32	33	34	35	36						
13												

A. Description of original monument and accessories and/or subsequent restoration:

- G.L.O.: DID NOT SET CORNER.
- A. C. WILLSON, 24APR1867, (L.2, Pg. 139): SET CORNER AT CROSSING OF 1/4 LINES. STONE AND BRICK FOR CORNER.

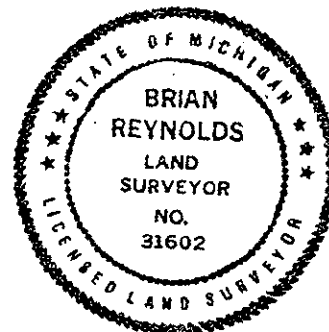

B. Description of corner evidence found and/or method applied in restoring or reestablishing corner:

- CHOSE NOT TO EXCAVATE FOR STONE. +/- 7' OF FILL WAS LAID IN CONSTRUCTION OF KELLER ROAD. SET CORNER AT INTERSECTION OF 1/4 LINES.

ACT 345 BARRY COUNTY REMONUMENTATION
APPROVED BY PEER REVIEW AT A MEETING HELD ON
MAY 3, 1994 BR
BRIAN REYNOLDS COUNTY SURVEYOR

C. Description of monument for corner and accessories established to perpetuate locating the position of the corner:

- SET BARRY Co. REMONUMENTATION MONUMENT:
 - OLD FENCE NORTH AND SOUTH
 - +/- 15.2' NORTH OF C/L KELLER Rd.; +/- 3.9' NORTH OF NORTHERN EDGE OF ASPHALT.
 - N&T - NW. SIDE - 12" MAPLE - N20E - 19.80'
 - N&T - W. SIDE - 18" HICKORY - N. - 43.93'
 - N&T - E. SIDE - 12" ASH - S25W - 51.99'
 - N&T - CENTER - TOP - 4" FENCE CORNER - S20E - 45.55'
 - N&T - E. SIDE - 12" TWIN MAPLE - S30E - 44.52'

Signed by [Signature] Date JUNE 20, 1994
Surveyor's Michigan License No. 31602