

**SURVEY & REMONUMENTATION**

SEP 13 1994

COMMISSION

NE COR SEC 18  
HASTINGS

BARRY COUNTY REMONUMENTATION  
**LAND CORNER RECORDATION CERTIFICATE**  
Filing Requirement of Act 74, Mich. P.A. 1970

STATE OF MICHIGAN  
COUNTY OF BARRY  
RECEIVED FOR RECORD

MAR 16 4 24 PM '94

Sandy Schondelmaier  
REGISTER OF DEEDS

**002185**

Register of Deeds Stamp & File Number

For corners in

<u>BARRY</u> (County)	Located In:	Corner Code #
1. Public Land Survey	T <u>3N</u> R <u>8W</u>	<u>C-5</u>
	T _____ R _____	_____
	T _____ R _____	_____
	T _____ R _____	_____
2. Property Controlling in Section	S _____ T _____ R _____	_____
	S _____ T _____ R _____	_____
3. Miscellaneous Property in Sec.	S _____ T _____ R _____	_____
	S _____ T _____ R _____	_____
4. Lot No. _____, Recorded Plat _____		
5. Private Claims _____		

	A	B	C	D	E	F	G	H	I	J	K	L	M
2	6		5		4		3		2		1		
3													
4	7		8		9		10		11		12		
5													
6	18		17		16		15		14		13		
7													
8	19		20		21		22		23		24		
9													
10	30		29		28		27		26		25		
11													
12	31		32		33		34		35		36		
13													

I, BRIAN REYNOLDS, in a field survey on JANUARY 5TH, 19 94, do hereby certify that under requirements of P.A. 74, Michigan P.A. of 1970, the corner points mentioned in lines 1 and 2 above were in conformance with regulations and rules therefore as required in the current manual of survey instructions of the United States Department of the Interior, Bureau of Land Management or by a decree of a Court of Law and/or that the corner points mentioned in lines 3, 4 and 5 above were in conformance with the rules of the Michigan Board of Land Surveyors or by a Decree of a Court of Law; established, re-established, monumented, re-monumented, recovered, found as expressed below:

**NOTE: Not more than 4 corners, all in the same town and range, may be recorded on this certificate.**

A. Description of original monument and accessories and/or subsequent restoration:  
CORNER SET BY DEPUTY SURVEYOR SLYVESTER SIBLEY UNDER CONTRACT DATED 16 MARCH 1831  
SET POST COR SEC'S 7, 8, 17, 18  
WHITE OAK 12 S83E 28  
WHITE OAK 11 N88W 42  
1900 CITY SURVEY - GAS PIPE  
WALNUT WEST 172.6'  
OAK 10 SE 91.0  
MDOT SURVEY OF BRIDGE ON BROADWAY ST. COR. IS PK NAIL & CAP IN E RD  
WITS= S18°E 72.21' P. POLE N33°E 55.81' P. POLE N89°W 33.00' SE COR RUBBLEWALL COR WAS REPLACED WITH 1" IRON PIN AND M. BOX AT TIME OF BRIDGE CONST.

B. Description of corner evidence found and/or method applied in restoring or reestablishing corner:  
FD 1" SOLID IRON IN MON. BOX PER MDOT INFORMATION.

ACT 345 BARRY COUNTY REMONUMENTATION  
APPROVED BY PEER REVIEW AT A MEETING HELD ON  
JANUARY 12, 1994 BR  
BRIAN REYNOLDS COUNTY SURVEYOR

C. Description of monument for corner and accessories established to perpetuate locating the position of the corner:  
1" SOLID IRON IN MON. BOX  
-USGS B. MARK IN S/W AT NW COR BRIDGE S18°W 94.98'  
-NAIL & TAG IN W SIDE P. POLE S24°E 66.91'  
-NAIL & TAG IN W SIDE P. POLE N13°E 132.60'  
-NAIL & TAG IN E SIDE P. POLE N23°E 78.26'  
- TOP SE COR CONC CAP ON STONE WALL WEST 33.08'

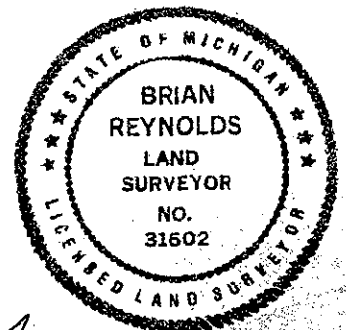

Signed by [Signature]  
Surveyor's Michigan License No. 31602

Date 3-7-94