

**SURVEY &  
REMONUMENTATION**

JUL 24 1997

COMMISSION

**BARRY COUNTY REMONUMENTATION**

LAND CORNER RECORDATION CERTIFICATE  
Filing Requirement of Act 74, Mich. P.A. 1970

STATE OF MICHIGAN  
BARRY COUNTY  
RECORDED

17 JUN 97 12:21 P.M.

SANDY SCHONDELMAYER  
REGISTER OF DEEDS

**002506**

Register of Deeds Stamp & File Number

For Corners in <u>BARRY</u> (county)	Located In:	Corner Code #
1. Public Land Survey 1/4 CORNER COMMON TO SECTIONS 27 & 28 HASTINGS TOWNSHIP	T <u>3N</u> R <u>8W</u> T _____ R _____ T _____ R _____ T _____ R _____	<u>G-10</u> _____ _____ _____
2. Property Controlling in Section	S _____ T _____ R _____ S _____ T _____ R _____	_____ _____
3. Miscellaneous Property in Sec.	S _____ T _____ R _____ S _____ T _____ R _____	_____ _____
4. Lot No _____, Recorded Plat _____		
5. Private Claims _____		

	A	B	C	D	E	F	G	H	I	J	K	L	M
2	6	5	4	3	2	1							
3													
4	7	8	9	10	11	12							
5													
6	18	17	16	15	14	13							
7													
8	19	20	21	22	23	24							
9													
10	30	29	28	27	26	25							
11													
12	31	32	33	34	35	36							
13													

I, **Brian Reynolds**, in a field survey on 17 NOVEMBER, 1995 do hereby certify that under requirements of P.A. 74, Michigan P.A. of 1970, the corner points mentioned in lines 1 and 2 above were in conformance with regulations and rules therefore as required in the current manual of survey instructions of the United States Department of the Interior, Bureau of Land Management or by a decree of a Court of Law and/or that the corner points mentioned in lines 3, 4, and 5 above were in conformance with the rules of the Michigan Board of Land Surveyors or by a Decree of a Court of Law; established, re-established, monumented, re-monumented, recovered, found as expressed below.

NOTE: Not more than 2 corners, all in the same town and range, may be recorded on this certificate.

A. Description of original monument and accessories and/or subsequent restoration:

- GENERAL LAND OFFICE: SYLVESTER SIBLEY D.S., 1830 (R8W,P.113) A W. OAK 8 S17E 25 A HICKORY 8 N6 1/2W 42
- COUNTY SURVEYOR RECORDS: CRESSEY, 30-31 MARCH, 1874 (L.1,P.42) "PUT STONE & BRICK"
- ALSO: COBB, 1888 (BOOK IX, P.15) "FOUND STONE & BRICK BY JOHN CRESSEY, MADE NEW BEARINGS" B. ASH 10 N29E 10 1/2
- ALSO: COBB, DEC. 16, 1889 (BOOK IX, PG.86) "G-10 TO G-11 39.90 CH." "FOUND STONE & BRICK BY CRESSEY & BEARING TREE BY SELF 1889"
- PRIVATE NOTES: JAMES L. KING, P.S. #14766 DEC. 76; "3/4" IRON ROD IN FC. E-W FC. TO THE S." 30" TWIN OAK N5°+/-E 27.34'
- PRIVATE NOTES OF BRIAN REYNOLDS, P.S. #31602, "FOUND 3/4" IRON" 60" TWIN OAK N05°E 27.58' 18" MAPLE N70°E 32.75' 12" TREE WEST 7.36' 18" MAPLE N45°W 25.65' FENCE EAST-WEST & SOUTH

B. Description of corner evidence found and/or method applied in restoring or reestablishing corner:

FOUND 3/4" IRON ROD AT THE INTERSECTION OF FENCES RUNNING EAST-WEST & SOUTH. FOUND WITNESS FROM KING (30" TWIN OAK N5°+/-E 27.34' NOW MUCH LARGER), THIS WITNESS MAY BE THE SAME TREE USED BY SIBLEY IN 1830 (HICKORY 8 N6 1/2W 42 Iks.) EXCAVATED AT INTERSECTION OF FENCES AND FOUND NOTHING. EXCAVATED AT BEARING AND DISTANCE FROM SIBLEY AND FOUND NOTHING. BASED ON TRAVERSE OF SECTIONS 27 AND 28 (FROM PREVIOUS SURVEY OF SECTION 28) ACCEPTED FOUND 3/4" IRON AS PERPETUATION OF CORNER POSITION BY SIBLEY.  
REPLACED FOUND 3/4" IRON WITH STANDARD BARRY COUNTY REMONUMENTATION MONUMENT.

C. Description of monument for corner and accessories established to perpetuate locating the position of the corner:

SET STANDARD BARRY COUNTY REMONUMENTATION MONUMENT (3/4" X 36" IRON) WITH ALUMINUM CAP.  
FOUND NAIL WITH PLASTIC CAP IN THE WEST SIDE OF A 60" TWIN OAK N5°E 27.56'  
FOUND NAIL WITH PLASTIC CAP IN THE NORTH SIDE OF AN 18" MAPLE N70°E 32.75'  
FOUND NAIL WITH PLASTIC CAP IN THE NORTH SIDE OF A 12" ASH WEST 7.35'  
FOUND NAIL WITH PLASTIC CAP IN THE SOUTHWEST SIDE OF AN 18" MAPLE N45°W 25.65'  
IN LINE WITH FENCE SOUTH 0.3' NORTH OF AN EAST-WEST FENCE FENCE CORNER POST SOUTH 0.3'

ACT 345 BARRY COUNTY REMONUMENTATION  
APPROVED BY PEER REVIEW AT A MEETING HELD ON

4-8-96  
BRIAN REYNOLDS

*ISR*  
COUNTY SURVEYOR

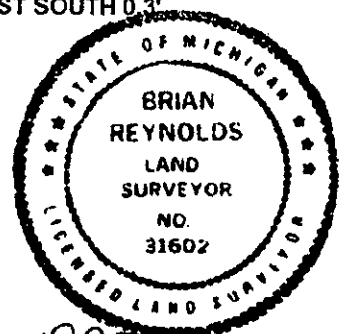

Signed by *[Signature]*  
Surveyor's Michigan License No 31602

Date MAY 16, 1997