

**SURVEY & REMONUMENTATION**

**BARRY COUNTY REMONUMENTATION**

**FEB 17 1998**

**LAND CORNER RECORDATION CERTIFICATE**  
Filing Requirement of Act 74, Mich. P.A. 1970

**SECTION**

**002517**

For Corners in <u>BARRY</u> (county)	Located In:	Corner Code #
1. Public Land Survey TOWNSHIP CORNER COMMON TO TOWNSHIPS 3 & 4 NORTH RANGES 7 & 8 WEST	T <u>3N</u> R <u>7W</u> T <u>3N</u> R <u>8W</u> T <u>4N</u> R <u>7W</u> T <u>4N</u> R <u>8W</u>	<u>A-1</u> <u>M-1</u> <u>A-13</u> <u>M-13</u>
2. Property Controlling in Section	S ___ T ___ R ___ S ___ T ___ R ___	_____
3. Miscellaneous Property in Sec.	S ___ T ___ R ___ S ___ T ___ R ___	_____
4. Lot No _____, Recorded Plat _____		
5. Private Claims _____		

STATE OF MICHIGAN  
BARRY COUNTY  
RECORDED

31 JUL 97 9:04 A.M.

SANDY SCHONDELMEYER  
REGISTER OF DEEDS

Register of Deeds Stamp & File Number

I, **Brian Reynolds**, in a field survey on **17 OCTOBER, 1996** do hereby certify that under requirements of P.A. 74, Michigan P.A. of 1970, the corner points mentioned in lines 1 and 2 above were in conformance with regulations and rules therefore as required in the current manual of survey instructions of the United States Department of the Interior, Bureau of Land Management or by a decree of a Court of Law and/or that the corner points mentioned in lines 3, 4, and 5 above were in conformance with the rules of the Michigan Board of Land Surveyors or by a Decree of a Court of Law; established, re-established, monumented, re-monumented, recovered, found as expressed below.

	B	C	D	E	F	G	H	I	J	K	L	M
2	6	5	4	3	2	1						
3												
4	7	8	9	10	11	12						
5												
6	18	17	16	15	14	13						
7												
8	19	20	21	22	23	24						
9												
10	30	29	28	27	26	25						
11												
12	31	32	33	34	35	36						
13												

NOTE: Not more than 2 corners, all in the same town and range, may be recorded on this certificate.

A. Description of original monument and accessories and/or subsequent restoration:

- GENERAL LAND OFFICE: L.LYON, D.S., 1826 (R7W,P.91) WEST 76.64 SUGAR 15 S26W 19 ELM 16 N69W 25
- COUNTY SURVEYOR RECORDS: S. PRATT, 1887 (BR. CAST. FB., P.68) "FOUND STONE WITH CROSS ON TOP IN PLACE" ELM 12 N24 1/2E 113 NE COR CHURCH WALL S31 3/4W 151 3/4
- C.K.&S RAILROAD PLANS, 8 NOV., 1888 (L.1 OF PLATS, P. 34) "918' NORTH AND 857' WEST OF R.R."
- COUNTY ROAD COMMISSION: NO NAME, 1928 (DURKEE RD. F.B., P.4) "STA. 106+02.18 STONE WITH X"
- ALSO: MDOT, 1928 (M-43 HIGHWAY PLANS, P. 13) "CROSS ON STONE" N44°30'E 42.5' SPIKE IN ANCHOR FNC. POST S49°30'E 44.5' TO NORTHWEST COR. CONC. STEP OF STORE S43°30'W 51.4' SPIKE IN 12" MAPLE

\*\*\* SEE REVERSE OF THIS FORM FOR MORE HISTORICAL INFORMATION \*\*\*

B. Description of corner evidence found and/or method applied in restoring or reestablishing corner:

FOUND 7/8"X12" IRON IN MONUMENT BOX. WITNESS TO SOUTHEAST CORNER FOUNDATION SCHOOL NORTHWEST (#6 OF PART "A") MEASURES VERY CLOSELY. P.P. (POWER POLE) NW AND 12" CEDAR NE(#9 OF PART "A") MEASURE VERY CLOSE USING THE FACE OF THE POWER POLE AND CEDAR. 20" MAPLE SW (NOW MUCH LARGER) AND POWER POLE NORTHWEST (#8 OF PART "A") MEASURES VERY CLOSELY. REMOVED 7/8" IRON, ATTEMPTED TO PLACE STANDARD 3/4"X24" REMON IRON, COULD NOT DO SO AS STONE IS STILL IN PLACE 15" +/- BELOW GRADE. REPLACED 7/8"X12" IRON, INSTALLED STANDARD ALUMINUM REMONUMENTATION CAP (WITHOUT PLASTIC SLEEVES) OVER STONE, INSIDE EXISTING MONUMENT BOX.

C. Description of monument for corner and accessories established to perpetuate locating the position of the corner:

INSTALLED STANDARD ALUMINUM REMONUMENTATION CAP ON TOP OF 7/8"X12" FOUND IRON INSIDE EXISTING MONUMENT BOX  
SET 20d NAIL W/REMON TAG IN THE SOUTHWEST SIDE OF A UTILITY POLE N23°W 54.33'  
SET 20d NAIL W/REMON TAG IN THE SOUTHEAST SIDE OF A NEW UTILITY POLE N26°E 58.23'  
SET 20d NAIL W/REMON TAG IN THE SOUTHEAST SIDE OF A 30" MAPLE S52°W 63.47'  
SOUTHEAST FOUNDATION CORNER OF OLD CHURCH N39°W 85.63'  
SOUTHEAST FOUNDATION CORNER OF NEW CHURCH S20°W 148.32'  
CORNER IS ON CENTERLINE OF ROADS NORTH-SOUTH-EAST-WEST

ACT 345 BARRY COUNTY REMONUMENTATION  
APPROVED BY PEER REVIEW AT A MEETING HELD ON

JULY 14 1997 BR  
BRIAN REYNOLDS COUNTY SURVEYOR

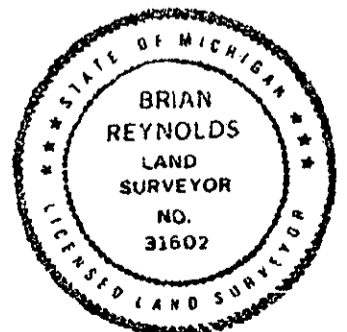

Signed by [Signature]  
Surveyor's Michigan License No 31602

Date JULY 30, 1997

6300

2517-A

(PART "A" CONTINUED)

6. ALSO: ROAD COMMISSION, NO DATE (RD. #440 M-43 F.B., P.1) "STONE" 20" MAPLE S45W 62.8  
PROJECT MARKER S20E 69.0 SE CORN. FOUND. SCH. NW 85.7 36" ELM N30E 71.9'
7. ALSO: ROAD COMMISSION, 1-25-73, "SET IRON ON STONE PLACED MONU. BOX"
8. LAND CORNER RECORDATION CERTIFICATE: #188, BY G.M. YOUNG, P.S. #17640, 18 NOV., 1975 "FOUND 3/4" IRON  
ROD" NAIL IN 24" MAPLE S45°W 63.49' NAIL IN P. P. N25°E 55.50' NAIL IN P.P. N25°W 54.55'
9. COUNTY ROAD COMMISSION: (1984 & 1985 ROAD PLANS, P.6) P.O.T. STA. 175+45.1= 15+00 DURKEE RD.  
P.P. N40°W 53.6' 12" CEDAR N45°E 47.0 NE CORN. SIGN BASE S45°W 58.6

SURVEY &  
REMONUMENTATION

FEB 17 1998

SECTION