

SURVEY & REMONUMENTATION

SEP 13 1994

COMMISSION

**BARRY COUNTY REMONUMENTATION
LAND CORNER RECORDATION CERTIFICATE
Filing Requirement of Act 74, Mich. P.A. 1970**

STATE OF MICHIGAN
COUNTY OF BARRY
RECEIVED FOR RECORD

MAR 16 4 24 PM '94

Sandra Schondelmayer
REGISTER OF DEEDS

002193

Register of Deeds Stamp & File Number

For corners in BARRY
(County)

Located In: Corner Code #

- 1. Public Land Survey T 3N R 9W E-5
T RUTLAND TWP.
T COR. SEC. 8, 9, 16 & 17
T _____ R _____
- 2. Property Controlling S _____ T _____ R _____
in Section S _____ T _____ R _____
- 3. Miscellaneous S _____ T _____ R _____
Property in Sec. S _____ T _____ R _____
- 4. Lot No. _____, Recorded Plat _____
- 5. Private Claims _____

	A	B	C	D	E	F	G	H	I	J	K	L	M
2	6		5		4		3		2		1		
3													
4	7		8		9		10		11		12		
5					⊙								
6	18		17		16		15		14		13		
7													
8	19		20		21		22		23		24		
9													
10	30		29		28		27		26		25		
11													
12	31		32		33		34		35		36		
13													

I, BRIAN REYNOLDS, in a field survey on 6 DEC, 19 93, do hereby certify that under requirements of P.A. 74, Michigan P.A. of 1970, the corner points mentioned in lines 1 and 2 above were in conformance with regulations and rules therefore as required in the current manual of survey instructions of the United States Department of the Interior, Bureau of Land Management or by a decree of a Court of Law and/or that the corner points mentioned in lines 3, 4 and 5 above were in conformance with the rules of the Michigan Board of Land Surveyors or by a Decree of a Court of Law; established, re-established, monumented, re-monumented, recovered, found as expressed below:

NOTE: Not more than 4 corners, all in the same town and range, may be recorded on this certificate.

- A. Description of original monument and accessories and/or subsequent restoration:
 - GENERAL LAND OFFICE: A W. OAK - 8 - N83W - 32ks.; Do. - 10 - N75E - 46lks.
 - NO RECOERD FOUND IN COUNTY SURVEYOR NOTES.
 - L. C. R. C. #350, 2/25/83, BY CARL ENGLERT, P.S. #18987:
 - SET 1/2" IRON BAR: NE. - 44.65' - 8" OAK
 - E. - 43.33' - 11" HICKORY
 - NW. - 12.14' - 10" OAK
 - IRON IN CENTER OF ROAD - N. - 20.72'
 - S. - 10" OAK - 0.88'

ACT 345 BARRY COUNTY REMONUMENTATION
APPROVED BY PEER REVIEW AT A MEETING HELD ON
MARCH 1, 1994 BR
BRIAN REYNOLDS COUNTY SURVEYOR

- B. Description of corner evidence found and/or method applied in restoring or reestablishing corner:
 - FOUND IRON RECORDED BY ENGLERT AND ALL WITNESSES. ENGLERT CHOSE TO IGNORE IRON IN CENTERLINE OF TRAIL ROAD AND NUMEROUS WITNESS NAILS OF UNKNOWN ORIGIN. REYNOLDS' MEASUREMENTS IN SECTION 9, DEC. 93, DID NOT BEAR OUT ENGLERT'S CONCLUSIONS. BONNEMA'S (P.S. # 12579) MEASUREMENTS IN SECTION 8 ALONG WITH PREVIOUS MEASUREMENTS IN SECTIONS 9 AND 17 AGREED. REYNOLDS AND BONNEMA EACH INDEPENDENTLY AND IN CONSULTATION CONCLUDED THE IRON IGNORED BY ENGLERT REPRESENTED A MUCH MORE LIKELY POSITION. REYNOLDS' SUBSEQUENTLY EXCAVATED A WIDE AREA FOR ADDITIONAL PHYSICAL EVIDENCE AND FOUND NOTHING. ACCEPTED IRON 20.72' NORTH OF POSITION RECORDED IN L. C. R. C. # 350 AS BEST EVIDENCE OF CORNER. REPLACED IRON WITH STANDARD BARRY Co. MONUMENT. ENGLERT WAS INFORMED AND DID NOT RESPOND.

- C. Description of monument for corner and accessories established to perpetuate locating the position of the corner:
 - SET BARRY Co. REMONUMENTATION MONUMENT:
 - FOUND NAIL IN NORTHERLY SIDE OF 18" HICKORY - S60E - 39.08'
 - FOUND NAIL IN WEST SIDE OF 15" OAK - SOUTH - 21.60'
 - FOUND NAIL IN SOUTHEAST SIDE OF 12" OAK - N38E - 23.98'
 - 1/2" IRON RECORDED IN L.C.R.C. # 350 - SOUTH - 20.72'
 - SET SPIKE & TAG - NW. SIDE - 18" ELM - S33W - 18.15'
 - SET SPIKE & TAG - NW. SIDE - 15" OAK - S70W - 62.98'
 - SET SPIKE & TAG - S. SIDE - 18" OAK - N75E - 63.24'
 - ON C/L OF TRAIL ROAD.

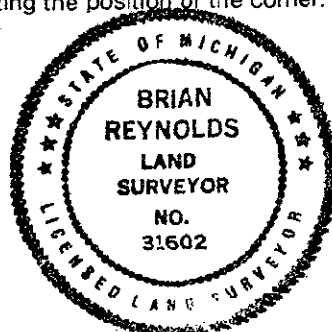

Signed by [Signature]
Surveyor's Michigan License No. 31602

Date MARCH 8, 1994