

BARRY COUNTY REMONUMENTATION

STATE OF MICHIGAN
COUNTY OF BARRY
RECEIVED FOR RECORD

OCT 27 1994

LAND CORNER RECORDATION CERTIFICATE
Filing Requirement of Act 74, Mich. P.A. 1970

OCT 7 2 04 PM '94

For corners in
BARRY
(County)

Sandy Schondelmayer
REGISTER OF DEEDS

	Located In:	Corner Code #
1. Public Land Survey 1/4 CORNER COMMON TO SECTIONS 33 AND 34 RUTLAND TOWNSHIP	T <u>3N</u> R <u>9W</u>	<u>G-12</u>
	T _____ R _____	_____
	T _____ R _____	_____
	T _____ R _____	_____
2. Property Controlling in Section	S _____ T _____ R _____	_____
	S _____ T _____ R _____	_____
3. Miscellaneous Property in Sec.	S _____ T _____ R _____	_____
	S _____ T _____ R _____	_____
4. Lot No. _____, Recorded Plat _____		
5. Private Claims _____		

002240

Register of Deeds Stamp & File Number

	A	B	C	D	E	F	G	H	I	J	K	L	N
2	6		5		4		3		2		1		
3													
4	7		8		9		10		11		12		
5													
6	18		17		16		15		14		13		
7													
8	19		20		21		22		23		24		
9													
10	30		29		28		27		26		25		
11													
12	31		32		33		34		35		36		
13													

I, **BRIAN REYNOLDS**, in a field survey on **4 OCTOBER**, 19**1994**, do hereby certify that under requirements of P.A. 74, Michigan P.A. of 1970, the corner points mentioned in lines 1 and 2 above were in conformance with regulations and rules therefore as required in the current manual of survey instructions of the United States Department of the Interior, Bureau of Land Management or by a decree of a Court of Law and/or that the corner points mentioned in lines 3, 4 and 5 above were in conformance with the rules of the Michigan Board of Land Surveyors or by a Decree of a Court of Law; established, re-established, monumented, re-monumented, recovered, found as expressed below:

NOTE: Not more than 4 corners, all in the same town and range, may be recorded on this certificate.

A. Description of original monument and accessories and/or subsequent restoration:
**GENERAL LAND OFFICE: SYLVESTER SIBLEY D. S. 1831 (R9W,P.162) A. BEECH 8 N8SE 6 AN IRONWOOD 6 S60W 24
NO OTHER RECORDED HISTORICAL INFORMATION, PUBLIC OR PRIVATE COULD BE FOUND FOR THIS CORNER.**

B. Description of corner evidence found and/or method applied in restoring or reestablishing corner:
FOUND FENCE CORNER ANCHOR POST, FENCES AND TREE ROWS EAST AND SOUTH, TREE ROWS NORTH AND WEST. EXCAVATED AROUND FENCE POST, FOUND NUMEROUS SMALL STONES, ONE LARGER ROUND STONE, ABOUT 10" IN DIAMETER 1 FOOT WEST OF FENCE CORNER POST. TIED OFF ROUND STONE, REMOVED STONE, EXCAVATED FURTHER, AT 2+ FEET BELOW GRADE FOUND 1" DIAMETER BY 10" LONG IRON, TAPERED AT LOWER END (DRAG TOOTH), OBVIOUSLY VERY OLD, DIRECTLY BELOW FOUND ROUND STONE. ACCEPTED FOUND IRON AS BEST AVAILABLE EVIDENCE OF CORNER POSITION REPLACED FOUND IRON WITH STANDARD BARRY COUNTY REMONUMENTATION MONUMENT.

ACT 345 BARRY COUNTY REMONUMENTATION
APPROVED BY PEER REVIEW AT A MEETING HELD ON
4 OCT. '94 BR
BRIAN REYNOLDS COUNTY SURVEYOR

C. Description of monument for corner and accessories established to perpetuate locating the position of the corner:
**SET STANDARD BARRY COUNTY REMONUMENTATION MONUMENT (3/4"X36"W/ALUMINUM CAP)
40d NAIL W/REMON TAG SET IN SOUTHWEST SIDE OF A 12" MAPLE N47W 27.35'
40d NAIL W/REMON TAG SET IN EAST SIDE OF A 14" MAPLE S3W 10.60'
40d NAIL W/REMON TAG SET IN SOUTH SIDE OF A 12" MAPLE N83E 19.27'
40d NAIL W/REMON TAG SET IN EAST SIDE OF A 15" MAPLE N23W 34.84'
40d NAIL W/REMON TAG SET IN NORTH SIDE OF AN 18" MAPLE N66W 35.23'
40d NAIL W/REMON TAG SET IN NORTH SIDE OF A 24" OAK S67W 28.46'
CORNER LIES 1'+/- WEST OF REMAINS OF STEEL FENCE CORNER POST
FENCE EAST AND SOUTH**

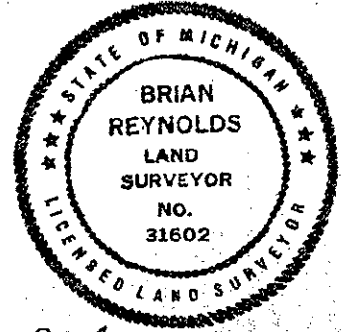

Signed by [Signature] Date OCT 7, 1994
Surveyor's Michigan License No. 31602