

SURVEY & REMONUMENTATION

NOV 04 1996

COMMISSION

BARRY COUNTY REMONUMENTATION

LAND CORNER RECORDATION CERTIFICATE  
Filing Requirement of Act 74, Mich. P.A. 1970

STATE OF MICHIGAN  
COUNTY OF BARRY  
RECEIVED FOR RECORD

AUG 20 11 27 AM '96

Sandy Schondelmarzen  
REGISTER OF DEEDS

002397

Register of Deeds Stamp & File Number

For corners in

BARRY

(County)

Located In:

Corner Code #

- 1. Public Land Survey T 3N R9W  
**NORTH 1/4 CORNER SECTION 1** T \_\_\_\_\_ R \_\_\_\_\_  
**RUTLAND TOWNSHIP** T \_\_\_\_\_ R \_\_\_\_\_  
**ON TOWNSHIP LINE** T \_\_\_\_\_ R \_\_\_\_\_  
L-1
- 2. Property Controlling S \_\_\_\_\_ T \_\_\_\_\_ R \_\_\_\_\_  
in Section S \_\_\_\_\_ T \_\_\_\_\_ R \_\_\_\_\_
- 3. Miscellaneous S \_\_\_\_\_ T \_\_\_\_\_ R \_\_\_\_\_  
Property in Sec. S \_\_\_\_\_ T \_\_\_\_\_ R \_\_\_\_\_
- 4. Lot No. \_\_\_\_\_, Recorded Plat \_\_\_\_\_
- 5. Private Claims \_\_\_\_\_

	A	B	C	D	E	F	G	H	I	J	K	L	M
2	6	5	4	3	2	1							
3													
4	7	8	9	10	11	12							
5													
6	18	17	16	15	14	13							
7													
8	19	20	21	22	23	24							
9													
10	30	29	28	27	26	25							
11													
12	31	32	33	34	35	36							
13													

I, BRIAN REYNOLDS, in a field survey on 30 MARCH, 1995, do hereby certify that under requirements of P.A. 74, Michigan P.A. of 1970, the corner points mentioned in lines 1 and 2 above were in conformance with regulations and rules therefore as required in the current manual of survey instructions of the United States Department of the Interior, Bureau of Land Management or by a decree of a Court of Law and/or that the corner points mentioned in lines 3, 4 and 5 above were in conformance with the rules of the Michigan Board of Land Surveyors or by a Decree of a Court of Law; established, re-established, monumented, re-monumented, recovered, found as expressed below:

**NOTE: Not more than 4 corners, all in the same town and range, may be recorded on this certificate.**

A. Description of original monument and accessories and/or subsequent restoration

**CORNER NOT SET BY THE GENERAL LAND OFFICE.  
PRIVATE SURVEY (NOT RECORDED) c. 1989 BY BRIAN REYNOLDS P.S.#31602 "SET L-1 AT MID POINT AND ON LINE BETWEEN K-1 AND M-1."  
NO OTHER RECORDED HISTORICAL INFORMATION AVAILABLE FOR THIS CORNER.**

B. Description of corner evidence found and/or method applied in restoring or reestablishing corner:

**FOUND IRON BY REYNOLDS AS MENTIONED ABOVE. TRAVERSE 1/2 MILE EAST AND 2 1/2 MILES WEST LOCATING L-13 T4N, R9W, AND RESTORING K-13 T4N, R9W, FOUND REYNOLDS IRON TO BE 1.64' SOUTH OF TOWN LINE BETWEEN K-13 AND L-13 T4N, R9W.  
MOVED REYNOLDS POSITION NORTH 1.64' TO TOWNSHIP LINE AND SET STANDARD BARRY COUNTY REMONUMENTATION MONUMENT.**

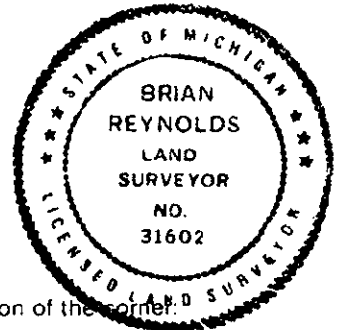

C. Description of monument for corner and accessories established to perpetuate locating the position of the corner:

**SET STANDARD BARRY COUNTY REMONUMENTATION MONUMENT (3/4"X36"W/ALUMINUM CAP)  
SET 40d NAIL W/PLASTIC TAG IN THE EAST SIDE OF A 14" CHERRY S12°E 55.47'  
SET 40d NAIL W/PLASTIC TAG IN THE SOUTH SIDE OF A UTILITY POLE N76°E 158.51'  
SET 40d NAIL W/PLASTIC TAG IN THE WEST SIDE OF AN 8" ASPEN N15°W 57.50'  
FOUND NAIL WITH CAP IN THE NORTHWEST SIDE OF A WOODEN FENCE POST S1°W 33.46'  
FOUND NAIL WITH CAP IN THE WEST SIDE OF A 10" TRIPLE CHERRY N10°E 47.85'  
FOUND NAIL WITH CAP IN THE EAST SIDE OF A RAILROAD TIE FENCE CORNER POST S20°E 31.53'**

ACT 345 BARRY COUNTY REMONUMENTATION  
APPROVED BY PEER REVIEW AT A MEETING HELD ON  
APRIL 10, 1995 BR  
BRIAN REYNOLDS COUNTY SURVEYOR

Signed by [Signature] Date \_\_\_\_\_  
Surveyor's Michigan License No. 31602