

APR 04 2000

BARRY COUNTY REMONUMENTATION

LAND CORNER RECORDATION CERTIFICATE
Filing Requirement of Act 74, Mich. P.A. 1970

SECTION

For Corners in BARRY Located In: _____ Corner Code # _____
(county)

1. Public Land Survey T 4N R 8W D-10
CENTER OF SECTION 29 T _____ R _____
CARLTON TOWNSHIP T _____ R _____
T _____ R _____



2767
Page: 1 of
05/18/1999 02:1

Sandy Schondelmayer- Barry Co. LCRCR

Register of Deeds Stamp & File Number

2. Property Controlling S _____ T _____ R _____
in Section S _____ T _____ R _____

3. Miscellaneous S _____ T _____ R _____
Property in Sec. S _____ T _____ R _____

4. Lot No _____, Recorded Plat _____

5. Private Claims _____

I, **Brian Reynolds**, in a field survey on **10 AUGUST, 1998** do hereby certify that under requirements of P.A. 74, Michigan P.A. of 1970, the corner points mentioned in lines 1 and 2 above were in conformance with regulations and rules therefore as required in the current manual of survey instructions of the United States Department of the Interior, Bureau of Land Management or by a decree of a Court of Law and/or that the corner points mentioned in lines 3, 4, and 5 above were in conformance with the rules of the Michigan Board of Land Surveyors or by a Decree of a Court of Law; established, re-established, monumented, re-monumented, recovered, found as expressed below.

	A	B	C	D	E	F	G	H	I	J	K	L	M
1													
2	6	5	4	3	2	1							
3													
4	7	8	9	10	11	12							
5													
6	18	17	16	15	14	13							
7													
8	19	20	21	22	23	24							
9													
10	30	29	28	27	26	25							
11													
12	31	32	33	34	35	36							
13													

NOTE: Not more than 2 corners, all in the same town and range, may be recorded on this certificate.

A. Description of original monument and accessories and/or subsequent restoration:

NO HISTORY, PUBLIC OR PRIVATE, COULD BE FOUND FOR THIS CORNER

B. Description of corner evidence found and/or method applied in restoring or reestablishing corner:

SET AT INTERSECTION OF 1/4 LINES

C. Description of monument for corner and accessories established to perpetuate locating the position of the corner:
SET STANDARD BARRY COUNTY REMONUMENTATION MONUMENT (3/4" X 36" IRON) WITH ALUMINUM CAP.
SET 20d NAIL W/PLASTIC TAG IN THE EAST SIDE OF THE SOUTH TRUNK OF AN 8" CHERRY CLUSTER N18°E 75.33'
SET 20d NAIL W/PLASTIC TAG IN THE NORTHEAST ROOT OF A 46" CHERRY S36°E 11.35'
SET 20d NAIL W/PLASTIC TAG IN THE NORTHEAST ROOT OF AN 8" MAPLE S28°E 39.41'
SET 20d NAIL W/PLASTIC TAG IN THE NORTH ROOT OF A 14" OAK S16°E 29.77'
SET 20d NAIL W/PLASTIC TAG IN THE SOUTHWEST ROOT OF A 22" OAK S53°E 45.66'
5' +/- NORTH OF TREE LINE OCCUPATION EAST 5.5'+/- EAST OF NORTH-SOUTH GRAVEL CENTERLINE

ACT 345 BARRY COUNTY REMONUMENTATION
APPROVED BY PEER REVIEW AT A MEETING HELD ON

12 Jan '98
BRIAN REYNOLDS

BR
COUNTY SURVEYOR

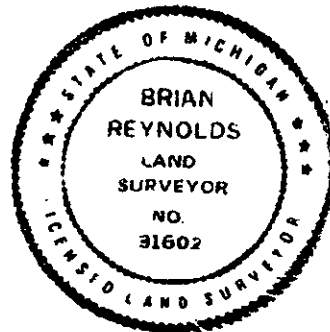

Signed by *Brian Reynolds*
Surveyor's Michigan License No 31602

Date MAY 18, 1999