

SURVEYS
 REMONUMENTATION
 AUG 22 1995
 COMMISSION

BARRY COUNTY REMONUMENTATION

STATE OF MICHIGAN
 COUNTY OF BARRY
 RECEIVED FOR RECORD

LAND CORNER RECORDATION CERTIFICATE
 Filing Requirement of Act 74, Mich. P.A. 1970

MAR 20 10 55 AM '95

Sandy Schendelmarer
 REGISTER OF DEEDS

For corners in
BARRY
 (County)

Located In: Corner Code #

1. Public Land Survey	4N	R8W	K-1
4 CORNER COMMON TO	T	R	
SECTIONS 1 & 2 CARLTON	T	R	
TOWNSHIP ON TOWN LINE	T	R	
2. Property Controlling	S	T	R
in Section	S	T	R
3. Miscellaneous	S	T	R
Property in Sec.	S	T	R

002295

Register of Deeds Stamp & File Number

4. Lot No. _____, Recorded Plat _____
 5. Private Claims _____

	A	B	C	D	E	F	G	H	I	J	K	L	M
2	6	5	4	3	2	1							
3													
4	7	8	9	10	11	12							
5													
6	18	17	16	15	14	13							
7													
8	19	20	21	22	23	24							
9													
10	30	29	28	27	26	25							
11													
12	31	32	33	34	35	36							
13													

BRIAN REYNOLDS, in a field survey on **15 APRIL**, 19**94**, do hereby certify that under requirements of P.A. 74, Michigan P.A. of 1970, the corner points mentioned in lines 1 and 2 above were in conformance with regulations and rules therefore as required in the current manual of survey instructions of the United States Department of the Interior, Bureau of Land Management or by a decree of a Court of Law and/or that the corner points mentioned in lines 3, 4 and 5 above were in conformance with the rules of the Michigan Board of Land Surveyors or by a Decree of a Court of Law: established, re-established, monumented, re-monumented, recovered, found as expressed below:

NOTE: Not more than 4 corners, all in the same town and range, may be recorded on this certificate.

A. Description of original monument and accessories and/or subsequent restoration:

GENERAL LAND OFFICE: SYLVESTER SIBLEY, D.S., 1830 (R8W, P.148), NORTH 78.55, NORTH BOUNDARY 25 LINKS EAST OF POST. SET POST CORNER TO SECTIONS 1 & 2. BEECH 7 S59E 4 IRONWOOD 6 S83W 29 NO OTHER RECORDED HISTORICAL INFORMATION AVAILABLE FOR THIS CORNER

B. Description of corner evidence found and/or method applied in restoring or reestablishing corner:
FOUND UNCAPPED IRON REPRESENTING CLOSING CORNER. FOUND CAPPED "MULDER" IRON 16.5' WEST, REPRESENTING STANDARD CORNER. EXCAVATED WITH BACKHOE AND AT 2 FEET BELOW GRADE FOUND VERY LARGE STONE. REMOVED STONE AND BELOW IT FOUND RING OF SMALL STONES INDICATING THAT CORNER POSITION WAS 1'+/- SOUTH AND THREE FEET WEST OF "MULDER" IRON AND FOUND ANOTHER LARGE STONE WITH CIRCLE OF SMALL STONES BELOW. ACCEPTED AS STANDARD CORNER. SET CLOSING CORNER 16.5' EAST AND ON TOWN LINE. REPLACED LARGE STONE WITH STANDARD BARRY COUNTY REMONUMENTATION MONUMENT

ACT 345 BARRY COUNTY REMONUMENTATION
 APPROVED BY PEER REVIEW AT A MEETING HELD ON

3 May 94 **BR**
 BRIAN REYNOLDS COUNTY SURVEYOR

C. Description of monument for corner and accessories established to perpetuate locating the position of the corner:

**SET STANDARD BARRY COUNTY REMONUMENTATION MONUMENT (3/4"X36"W/ALUMINUM CAP)
 SET 40d NAIL W/REMON TAG IN THE NORTHEAST SIDE OF A POWER POLE S55°E 42.20'
 SET 40d NAIL W/REMON TAG IN THE WEST SIDE OF A 50" OAK S7°W 88.71'
 SET 40d NAIL W/REMON TAG IN THE NORTHERLY SIDE OF A 30" EVERGREEN S75°W 151.55'
 SOUTHEAST CORNER OF THE CONCRETE FOUNDATION OF A HOUSE S60°W 227.59'
 U.S.G.S. MONUMENT N5°E 47.56'
 SOUTHEAST CORNER OF SECTION 35, T5N, R8W, WEST 16.5'
 3'+/- SOUTH OF EAST-WEST CENTERLINE
 7'+/- WEST OF CENTERLINE TO THE SOUTH**

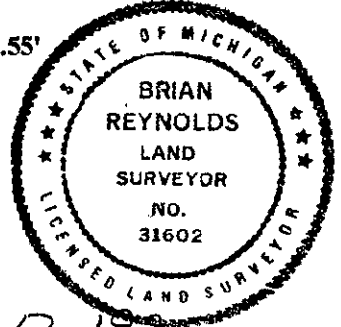

Signed by [Signature]
 Surveyor's Michigan License No. 31602

Date MARCH 17, 1995