

AUG 22 1995

COMMISSION

BARRY COUNTY REMONUMENTATION

STATE OF MICHIGAN COUNTY OF BARRY RECEIVED FOR RECORD

MAR 20 10 55 AM '95

LAND CORNER RECORDATION CERTIFICATE Filing Requirement of Act 74, Mich. P.A. 1970

Sandy Schindelmarper REGISTER OF DEEDS

For corners in BARRY

(County)

Located In:

Corner Code #

1. Public Land Survey CENTER OF SECTION 15 IRVINGTOWNSHIP

T 4N R 9W

H-6

2. Property Controlling in Section

S T R

3. Miscellaneous Property in Sec.

S T R

002285

Register of Deeds Stamp & File Number

4. Lot No. Recorded Plat 5. Private Claims

Grid table with columns A-M and rows 2-13. A black dot is located at the intersection of column H and row 6.

I, BRIAN REYNOLDS, in a field survey on 2 MARCH, 19 1995, do hereby certify that under requirements of P.A. 74, Michigan P.A. of 1970, the corner points mentioned in lines 1 and 2 above were in conformance with regulations and rules therefore as required in the current manual of survey instructions of the United States Department of the Interior, Bureau of Land Management or by a decree of a Court of Law and/or that the corner points mentioned in lines 3, 4 and 5 above were in conformance with the rules of the Michigan Board of Land Surveyors or by a Decree of a Court of Law; established, re-established, monumented, re-monumented, recovered, found as expressed below:

NOTE: Not more than 4 corners, all in the same town and range, may be recorded on this certificate.

A. Description of original monument and accessories and/or subsequent restoration:

CORNER NOT SET BY GENERAL LAND OFFICE RECORDED SURVEY BY DOUGLAS BONNEMA, P.S. # 12579, 27 JULY, 1990 (ACT 132 SURVEY L.2,P.5) "REROD" NAIL IN S SIDE 20" OAK N80°E 5.03' NAIL IN N SIDE 16" OAK S65°E 10.74' NAIL IN E SIDE 12" OAK S10°W 21.28' NAIL IN N SIDE 10" OAK S80°W 21.08' LAND CORNER RECORDATION CERTIFICATE: #340, BY BONNEMA, "REROD" WITNESSES SAME AS ABOVE NO OTHER RECORDED HISTORICAL INFORMATION FOR THIS CORNER AVAILABLE

B. Description of corner evidence found and/or method applied in restoring or reestablishing corner:

FOUND IRON AS RECORDED BY BONNEMA. SECTION MEASUREMENTS CONFIRM PROPER LOCATION. ACCEPTED FOUND IRON AS PROPER ESTABLISHMENT OF CORNER POSITION. REPLACED FOUND IRON WITH STANDARD BARRY COUNTY REMONUMENTATION MONUMENT.

ACT 345 BARRY COUNTY REMONUMENTATION APPROVED BY PEER REVIEW AT A MEETING HELD ON MAY 3 1994 BR BRIAN REYNOLDS COUNTY SURVEYOR

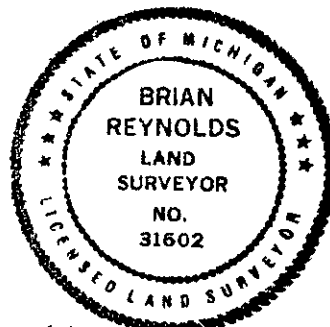

C. Description of monument for corner and accessories established to perpetuate locating the position of the corner:

SET STANDARD BARRY COUNTY REMONUMENTATION MONUMENT (3/4"X36"W/ALUMINUM CAP) SET 40d NAILW/PLASTIC TAG IN A 20" OAK N80°E 5.03' SET 40d NAILW/PLASTIC TAG IN A 16" OAK S65°E 10.74' SET 40d NAILW/PLASTIC TAG IN A 12" OAK S10°W 21.28' SET 40d NAILW/PLASTIC TAG IN A 10" OAK S80°W 21.08'

Signed by [Signature]

Date MARCH 17, 1995

Surveyor's Michigan License No. 31602