

SURVEY & REMONUMENTATION

NOV 04 1996

COMMISSION

BARRY COUNTY REMONUMENTATION

LAND CORNER RECORDATION CERTIFICATE
Filing Requirement of Act 74, Mich. P.A. 1970

STATE OF MICHIGAN
COUNTY OF BARRY
RECEIVED FOR RECORD

AUG 20 11 27 AM '96

Sandy Schondelmayer

REGISTER OF DEEDS

002391

For corners in

BARRY

(County)

Located In:

Corner Code #/

Public Land Survey	T	<u>4N</u>	R	<u>9W</u>	<u>H-13</u>
SOUTH 1/4 CORNER SECTION	T	_____	R	_____	_____
4 IRVING TOWNSHIP	T	_____	R	_____	_____
ON TOWNSHIP LINE	T	_____	R	_____	_____
Property Controlling in Section	S	_____	T	_____	_____
Miscellaneous Property in Sec.	S	_____	T	_____	_____

Register of Deeds Stamp & File Number

Lot No. _____, Recorded Plat _____
Private Claims _____

BRIAN REYNOLDS in a field survey on **31 MARCH** 19**95**

do hereby certify that under requirements of P.A. 74, Michigan P.A. of 1970, the corner points mentioned in lines 1 and 2 above were in conformance with regulations and rules therefore as required in the current manual of survey instructions of the United States Department of the Interior, Bureau of Land Management or by a decree of a Court of Law and/or that the corner points mentioned in lines 3, 4 and 5 above were in conformance with the rules of the Michigan Board of Land Surveyors or by a Decree of a Court of Law; established, re-established, monumented, re-monumented, recovered, found as expressed below:

NOTE: Not more than 4 corners, all in the same town and range, may be recorded on this certificate.

	A	B	C	D	E	F	G	H	I	J	K	L	M
2	6	5	4	3	2	1							
3													
4	7	8	9	10	11	12							
5													
6	13	17	16	15	14	13							
7													
8	19	20	21	22	23	24							
9													
10	30	29	28	27	26	25							
11													
12	31	32	33	34	35	36							
13													

Description of original monument and accessories and/or subsequent restoration

GENERAL LAND OFFICE: L. LYON, D.S., 1826(R9W, P.148)
B. OAK 7 N78E 94 Do. 7 N85 1/2W 65

NO OTHER RECORDED HISTORICAL INFORMATION AVAILABLE FOR THIS CORNER

Description of corner evidence found and/or method applied in restoring or reestablishing corner:

NO CORNER EVIDENCE FOUND. POSITION LIES IN 8'+ OF NEW ROAD FILL NEAR LARGE CULVERT.
SET CORNER AT MID-POINT BETWEEN G-13 AND I-13 AND ON LINE AS DEFINED BY G-13 AND H-1, T3N, R9W.

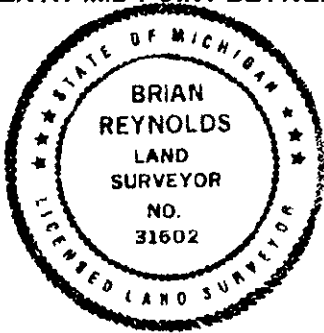

ACT 345 BARRY COUNTY REMONUMENTATION
APPROVED BY PEER REVIEW AT A MEETING HELD ON

10 April 95
BRIAN REYNOLDS

BR
COUNTY SURVEYOR

Description of monument for corner and accessories established to perpetuate locating the position of the corner:

- SET STANDARD BARRY COUNTY REMONUMENTATION MONUMENT (3/4"X36"W/ALUMINUM CAP)
- SET 40d NAIL W/PLASTIC TAG IN THE NORTH ROOT OF A 12" MAPLE S82°W 254.57'
- SET 40d NAIL W/PLASTIC TAG IN THE EAST SIDE OF A UTILITY POLE S17°W 63.07'
- SET 40d NAIL W/PLASTIC TAG IN THE NORTH SIDE OF A 40" OAK S79°E 245.24'
- SET 40d NAIL W/PLASTIC TAG IN THE WEST SIDE OF A UTILITY POLE S23°E 214.36'
- SET 40d NAIL W/PLASTIC TAG IN THE WEST SIDE OF A 12" TRIPLE MAPLE N33°E 166.47'
- CORNER LIES ROUGHLY ON CENTERLINE OF EAST-WEST ROAD
- 1 T3N, R9W, RUTLAND TOWNSHIP WEST 16.85'

Signed by *BR*

Date AUGUST 16, 1996

Surveyor's Michigan License No. 31602