

NOV 04 1996

COMMISSION

BARRY COUNTY REMONUMENTATION

STATE OF MICHIGAN COUNTY OF BARRY RECEIVED FOR RECORD

LAND CORNER RECORDATION CERTIFICATE Filing Requirement of Act 74, Mich. P.A. 1970

AUG 20 11 27 AM '96

Sandy Schondelmayer REGISTER OF DEEDS

002386

Register of Deeds Stamp & File Number

For corners in

BARRY

(County)

Located In:

Corner Code #

- 1. Public Land Survey T 4N R 9W I-7
CORNER COMMON TO SECTIONS 14,15,22, & 23 IRVING TOWNSHIP
2. Property Controlling in Section S T R
3. Miscellaneous Property in Sec. S T R

- 4. Lot No. Recorded Plat
5. Private Claims

I, BRIAN REYNOLDS, in a field survey on 2 MARCH 1995 do hereby certify that under requirements of P.A. 74, Michigan P.A. of 1970, the corner points mentioned in lines 1 and 2 above were in conformance with regulations and rules therefore as required in the current manual of survey instructions of the United States Department of the Interior, Bureau of Land Management or by a decree of a Court of Law and/or that the corner points mentioned in lines 3, 4 and 5 above were in conformance with the rules of the Michigan Board of Land Surveyors or by a Decree of a Court of Law; established, re-established, monumented, re-monumented, recovered, found as expressed below:

NOTE: Not more than 4 corners, all in the same town and range, may be recorded on this certificate.

A. Description of original monument and accessories and/or subsequent restoration.

- 1. GENERAL LAND OFFICE: SYLVESTER SIBLEY, D.S., 1830 (R9W,P.165), A TAMERACK 7 S.58E 39 Do. 8 S.78W 65
2. COUNTY SURVEYOR RECORDS: FRANK S. BOWEN, 15 NOV. 1875 (L.1,P107) "FOUND TAMK 12 S78W 65 NEW BEARING Do. 6 S41W 43"
NO OTHER RECORDED HISTORICAL INFORMATION AVAILABLE FOR THIS CORNER

PRIVATE RECORDS OF EXXEL ENGINEERING SET 1/2" CAPPED IRON AT SOUTHWEST SIDE OF CORNER FENCE POST SPIKE IN NW SIDE OF 30" MAPLE N45E 18.30' SPIKE IN SW SIDE OF 16" MAPLE N45W 19.04' SPIKE IN SE SIDE OF 12" MAPLE S45W 26.53' SPIKE IN N SIDE OF 14" MAPLE S60E 26.20'

B. Description of corner evidence found and/or method applied in restoring or reestablishing corner:

FOUND 1/2" CAPPED IRON AND ALL WITNESSES OF EXXEL ENGINEERING. AFTER SECTION TRAVERSE OF SECTION 15 AND THE WEST 1/2 OF SECTION 14 AND ANALYSIS OF SECTION MEASUREMENTS, ACCEPTED FOUND IRON AS BEST AVAILABLE EVIDENCE OF CORNER POSITION. REPLACED FOUND CAPPED IRON WITH STANDARD BARRY COUNTY REMONUMENTATION MONUMENT.

ACT 345 BARRY COUNTY REMONUMENTATION APPROVED BY PEER REVIEW AT A MEETING HELD ON MAY 3, 1994 BRIAN REYNOLDS COUNTY SURVEYOR

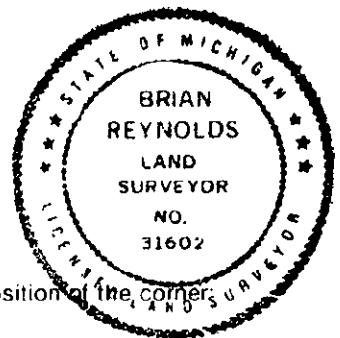

C. Description of monument for corner and accessories established to perpetuate locating the position of the corner:

SET STANDARD BARRY COUNTY REMONUMENTATION MONUMENT (3/4"X36"W/ALUMINUM CAP) CORNER LIES ON THE SOUTHWEST SIDE OF A 1' WOOD FENCE CORNER POST FOUND SPIKE ON THE NORTHERLY SIDE OF A 15" MAPLE S75E 26.26' FOUND SPIKE ON THE SOUTHERLY SIDE OF A 12" MAPLE S40W 26.52' FOUND SPIKE ON THE SOUTHERLY SIDE OF AN 18" MAPLE N70W 19.01' FOUND SPIKE ON THE NORTHERLY SIDE OF A 30" MAPLE N45E 18.35'

Signed by [Signature] Surveyor's Michigan License No. 31602

Date AUGUST 16, 1996