

**SURVEY & REMONUMENTATION**

AUG 31 1994

COMMISSION

**BARRY COUNTY REMONUMENTATION**

LAND CORNER RECORDATION CERTIFICATE

Filing Requirement of Act 74, Mich. P.A. 1970

STATE OF MICHIGAN  
COUNTY OF BARRY  
RECEIVED FOR RECORD

JUL 8 12 42 PM '94

Sandy Schondelmar  
REGISTER OF DEEDS

002205

Register of Deeds Stamp & File Number

For corners in BARRY  
(County)

Located In: Corner Code #

1. Public Land Survey T 4N R 9W J-9  
T IRVING TWNSP.  
T 1/4 COR. SEC 23 & 26  
T \_\_\_\_\_ R \_\_\_\_\_
2. Property Controlling S \_\_\_\_\_ T \_\_\_\_\_ R \_\_\_\_\_  
in Section S \_\_\_\_\_ T \_\_\_\_\_ R \_\_\_\_\_
3. Miscellaneous S \_\_\_\_\_ T \_\_\_\_\_ R \_\_\_\_\_  
Property in Sec. S \_\_\_\_\_ T \_\_\_\_\_ R \_\_\_\_\_
4. Lot No. \_\_\_\_\_, Recorded Plat \_\_\_\_\_
5. Private Claims \_\_\_\_\_

	A	B	C	D	E	F	G	H	I	J	K	L	M
2	6	5	4	3	2	1							
3													
4	7	8	9	10	11	12							
5													
6	18	17	16	15	14	13							
7													
8	19	20	21	22	23	24							
9													
10	30	29	28	27	26	25							
11													
12	31	32	33	34	35	36							
13													

I, BRIAN REYNOLDS, in a field survey on 26 APR, 19 94, do hereby certify that under requirements of P.A. 74, Michigan P.A. of 1970, the corner points mentioned in lines 1 and 2 above were in conformance with regulations and rules therefore as required in the current manual of survey instructions of the United States Department of the Interior, Bureau of Land Management or by a decree of a Court of Law and/or that the corner points mentioned in lines 3, 4 and 5 above were in conformance with the rules of the Michigan Board of Land Surveyors or by a Decree of a Court of Law; established, re-established, monumented, re-monumented, recovered, found as expressed below:

NOTE: Not more than 4 corners, all in the same town and range, may be recorded on this certificate.

- A. Description of original monument and accessories and/or subsequent restoration:  
 - G.L.O.: SYLVESTER SIBLEY D.S., 1830 (R9W, Pg. 165): WEST CORRECTED 39.88chains  
 W. OAK - 10 - S87W - 41; B. OAK - 20 - N24E - 64  
 - LEE COBB, 18 & 19 MAR 1892 (BOOK IX, Pg. 128): FOUND ONE STUMP U.S. TREE, PLAIN VIZ., W. OAK - S87W - 41links, SET STONE 16x8x4 & BRICK.  
 - A. W. BATEMAN, 23 & 24 JUN 1902 (L.3, Pg.68): STONE: S79E - 26Ft. - 8" ELM.  
 - L.C.R.C. # 312, WILLIAM R. BYL, 2 NOV 1979, SET 1/2" STEEL BAR IN C/L ROAD IN LINE WITH FENCES EAST & WEST: 16" TWIN OAK - SSE - 69.10'; 16" OAK - SW - 25.12'  
 16" OAK - NNE - 54.56'; 8" CHERRY - WNW - 32.32'

- B. Description of corner evidence found and/or method applied in restoring or reestablishing corner:  
 - FOUND BYL'S IRON AND WITNESSES AS RECORDED IN L.C.R.C. # 312. GIVEN THAT ROAD GRADE WAS ABOUT EVEN WITH NATURAL GRADE, TOGETHER WITH THE FACT THAT WE HAD BEEN ABLE TO FIND OTHER OLD CORNERS IN AREA WE DECIDED TO EXCAVATE FOR THE STONE AND BRICK ESTABLISHED BY COBB (1892) AND FOUND BY BATEMAN (1902).  
 AT ABOUT 1.5 FEET BELOW ROAD GRADE AND ABOUT 2 FEET NORTH OF BYL'S RECORDED IRON WE FOUND A LARGE GREEN STONE AND BRICK MATCHING THAT WHICH WAS RECORDED BY COBB. ACCEPTED THIS STONE AS THE STONE SET BY COBB (1892).

ACT 345 BARRY COUNTY REMONUMENTATION  
APPROVED BY PEER REVIEW AT A MEETING HELD ON  
MAY 3, 1994 BR  
BRIAN REYNOLDS COUNTY SURVEYOR

- C. Description of monument for corner and accessories established to perpetuate locating the position of the corner:

- SET BARRY Co. REMONUMENTATION MONUMENT IN PLACE OF FOUND STONE AND BRICK:  
 - ON C/L N. - S. ROAD; ON FENCE OCC. E. - W.  
 - 1.34' - N57E - OF BYL'S ESTABLISHED N1/4 CORNER (L.C.R.C. # 312)  
 - N&T - NE. FACE - 15" HICKORY - S19E - 104.33'  
 - N&T - N. FACE - 15" OAK - S54W - 27.15'  
 - N&T - N FACE - 18" OAK - N39W - 38.37'  
 - N&T - W. FACE - 16" OAK - N12E - 78.50'  
 - N&T - N. FACE - 8" ASH - N87E - 42.52'

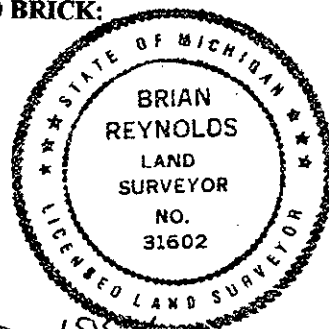

Signed by Brian Reynolds  
Surveyor's Michigan License No. 31602

Date JUNE 20, 1994