

SURVEY & REMONUMENTATION

NOV 04 1996

COMMISSION

BARRY COUNTY REMONUMENTATION

STATE OF MICHIGAN  
COUNTY OF BARRY  
RECEIVED FOR RECORD

LAND CORNER RECORDATION CERTIFICATE  
Filing Requirement of Act 74, Mich. P.A. 1970

AUG 20 11 27 AM '96

Sandy Schondelmayr

REGISTER OF DEEDS

002389

Register of Deeds Stamp & File Number

For corners in  
BARRY  
(County)

Located In: Corner Code #

1. Public Land Survey	T	<u>4N</u>	R	<u>9W</u>	<u>J-13</u>
<b>SOUTH 1/4 CORNER SECTION.</b>	T	_____	R	_____	_____
<b>35 IRVING TOWNSHIP</b>	T	_____	R	_____	_____
<b>ON TOWNSHIP LINE</b>	T	_____	R	_____	_____
2. Property Controlling	S	_____	T	_____	_____
in Section	S	_____	T	_____	_____
3. Miscellaneous	S	_____	T	_____	_____
Property in Sec.	S	_____	T	_____	_____

4. Lot No. \_\_\_\_\_, Recorded Plat \_\_\_\_\_  
5. Private Claims \_\_\_\_\_

A	B	C	D	E	F	G	H	I	J	K	L	M
2	6	5	4	3	2	1						
3												
4	7	8	9	10	11	12						
5												
6	18	17	16	15	14	13						
7												
8	19	20	21	22	23	24						
9												
10	30	29	28	27	26	25						
11												
12	31	32	33	34	35	36						
13												

I, BRIAN REYNOLDS, in a field survey on 31 MARCH, 1995

do hereby certify that under requirements of P.A. 74, Michigan P.A. of 1970, the corner points mentioned in lines 1 and 2 above were in conformance with regulations and rules therefore as required in the current manual of survey instructions of the United States Department of the Interior, Bureau of Land Management or by a decree of a Court of Law and/or that the corner points mentioned in lines 3, 4 and 5 above were in conformance with the rules of the Michigan Board of Land Surveyors or by a Decree of a Court of Law; established, re-established, monumented, re-monumented, recovered, found as expressed below:

NOTE: Not more than 4 corners, all in the same town and range, may be recorded on this certificate.

A. Description of original monument and accessories and/or subsequent restoration

GENERAL LAND OFFICE: L. LYON, D.S., 1826(R9W, P.148)  
W. OAK 16 N7E 49 Do. 9 N45W 26  
LAND CORNER RECORDATION CERTIFICATE #394 BY DAVID F. PEABODY, P.S.#25866 "P.K. NAIL"  
P.K. NAIL IN E'LY SIDE T. POLE N30°W, 52.4' P.K. NAIL IN N'LY SIDE P. POLE S60°E, 67.2'  
2' +/- N. OF CENTERLINE ROAD CENTERLINE ROAD TO N. IS E. 6'+/-  
P.K. NAIL IN W'LY SIDE T. POLE S30°E, 85.6'  
ROAD COMMISSION: WITNESSES FOR J-1 T3N, R9W, RUTLAND TOWNSHIP REFER TO A STONE 4.55' EAST  
NO OTHER RECORDED HISTORICAL INFORMATION AVAILABLE FOR THIS CORNER

B. Description of corner evidence found and/or method applied in restoring or reestablishing corner:

FOUND 6"x8"x12" TAPERED STONE 2.5' BELOW GRAVEL ROAD AND 4.42' EAST OF J-1, T3N, R9W, RUTLAND TOWNSHIP. TRAVERSE 1.5 MILES EAST AND 1.5 MILES WEST SHOWS FOUND STONE IS ON TOWN LINE AND FITS VERY WELL WITH OCCUPATION.  
ACCEPTED FOUND STONE AS BEST EVIDENCE OF HISTORICAL POSITION.  
REPLACED STONE WITH STANDARD BARRY COUNTY REMONUMENTATION MONUMENT.

ACT 345 BARRY COUNTY REMONUMENTATION  
APPROVED BY PEER REVIEW AT A MEETING HELD ON

JULY 10, 1995 BR  
BRIAN REYNOLDS COUNTY SURVEYOR

C. Description of monument for corner and accessories established to perpetuate locating the position of the corner:

SET STANDARD BARRY COUNTY REMONUMENTATION MONUMENT (3/4"x36"W/ALUMINUM CAP)  
SET 40d NAIL W/PLASTIC TAG IN THE EAST SIDE OF A 10" TWIN OAK S5°W 50.26'  
FOUND "PK" IN THE EAST SIDE OF A UTILITY POLE N15°W 48.75'  
FOUND "PK" IN THE WEST SIDE OF A UTILITY POLE S45°E 89.82'  
FOUND "PK" IN THE NORTH SIDE OF A UTILITY POLE S65°E 74.97'  
CENTERLINE OF BUEHLER ROAD TO NORTH LIES EAST 18'+/-  
CENTERLINE OF BUEHLER ROAD TO SOUTH LIES EAST 23'+/-  
L-1 T3N, R9W, RUTLAND TOWNSHIP LIES WEST 4.42'

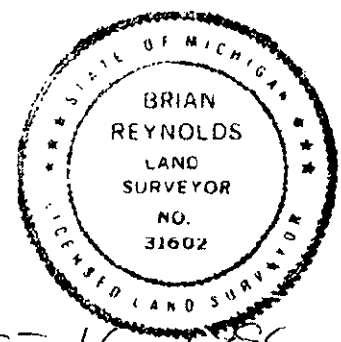

Signed by [Signature]

Date AUGUST 16, 1996

Surveyor's Michigan License No. 31602