

LAND CORNER RECORDATION CERTIFICATE
Filing Requirement of Act 74, Mich. P.A. 1970

For corners in
BARRY

(County)

Located in:

Corner Code =#

1. Public Land Survey	T 4N R 10W	M-3
	T 4N R 10W	M-9
	T _____ R _____	_____
	T _____ R _____	_____
2. Property Controlling in Section	S _____ T _____ R _____	_____
	S _____ T _____ R _____	_____
3. Miscellaneous Property in Sec.	S _____ T _____ R _____	_____
	S _____ T _____ R _____	_____

Register of Deeds Stamp & File Number

4. Lot No. _____, Recorded Plat _____
 5. Private Claims _____

A	B	C	D	E	F	G	H	I	J	K	L	M
2	5	5	4	3	2	1						
3												
4	7	8	9	10	11	12						
5												
6	13	17	16	15	14	13						
7												
8	19	20	21	22	23	24						
9												
10	30	29	28	27	26	25						
11												
12	31	32	33	34	35	36						
13												

I, GARY C. BILOW, in a field survey on AUGUST 29, 19 90, do hereby certify that under requirements of P.A. 74, Michigan P.A. of 1970, the corner points mentioned in lines 1 and 2 above were in conformance with regulations and rules therefore as required in the current manual of survey instructions of the United States Department of the Interior, Bureau of Land Management or by a decree of a Court of Law and/or that the corner points mentioned in lines 3, 4 and 5 above were in conformance with the rules of the Michigan Board of Land Surveyors or by a Decree of a Court of Law, established, re-established, monumented, re-monumented, recovered, found as expressed below:

NOTE: Not more than 4 corners, all in the same town and range, may be recorded on this certificate.

A. Description of original monument and accessories and/or subsequent restoration:
 (M-3) CORNER POST ESTABLISHED BY U.S. GOVERNMENT DEPUTY SURVEYOR LUCIUS LYON, 1826. ACCESSORIES: W. OAK 24 S09N 50, W. OAK 15 N27N 28. CORNER RECORDED UNDER ACT 74, P.A. 1970 BY DOUGLAS W. BONNEMA IN 1972 AS "FOUND 3/4" IRON" BONNEMA'S ACCESSORIES ARE: NAIL IN FACE P. POLE S5W 102.13', NAIL IN FACE OF T. POLE W. 26.95', NAIL IN FACE OF 20" WALNUT NNE 47.97', NAIL IN FACE OF 12" WALNUT ESE 21.61', CENTER OF ROAD SOUTH 36'.
 (M-9) CORNER POST ESTABLISHED BY U.S. GOVERNMENT DEPUTY SURVEYOR LUCIUS LYON, 1826. ACCESSORIES: W. OAK 10 S64W 27, W. OAK 8 N4W 07. COUNTY ROAD COMMISSION RECORDS SHOW A STONE WITH THE FOLLOWING ACCESSORIES: 20" WALNUT N30W 58.2', 24" MAPLE N50W 37.2', IRON CORNER POST S2E 33.10'.

B. Description of corner evidence found and/or method applied in restoring or reestablishing corner:
 (M-3) ORIGINAL CORNER POST AND ACCESSORIES NOT RECOVERED. FOUND NO RECORD OF PERPETUATION IN COUNTY SURVEYOR RECORD OR COUNTY ROAD COMMISSION FILES. FOUND AND ACCEPTED 3/4" PIPE IN ACCORD WITH RECORD TIES TO WALNUTS AND TO CENTERLINE OF ROAD.
 (M-9) ORIGINAL CORNER POST AND ACCESSORIES NOT RECOVERED. FOUND AND ACCEPTED 1/2" DIAMETER IRON BAR WHICH FITS ROAD COMMISSION DISTANCE AND BEARING FROM AN IRON CORNER FENCE POST SET IN CONCRETE.

C. Description of monument for corner and accessories established to perpetuate locating the position of the corner:
 (M-3) FOUND 3/4" IRON PIPE
 N30E 48.58' SET NAIL AND MICHIGAN DEPT. OF NATURAL RESOURCES TAG N. FACE 27" WALNUT
 S71E 21.98' SET NAIL AND MDNR TAG N. FACE 16" WALNUT
 S60E 40.33' SET NAIL AND MDNR TAG S. FACE 14" THIN WALNUT
 N35W 21.70' SET NAIL AND MDNR TAG E. FACE 6" WALNUT
 SOUTH 55.47' FOUND 3/4" IRON PIPE AT NORTHWEST CORNER OF SECTION 7 T4N-R9W
 SOUTH 36' CENTERLINE OF PARMALEE ROAD.
 (M-9) FOUND 1/2" IRON BAR
 S75W 71.77' NAIL IN SE FACE 26" MAPLE
 S62E 61.22' SET NAIL AND MDNR TAG NE FACE 10" MAPLE
 N80E 104.07' SET NAIL AND MDNR TAG S. FACE POWER POLE
 N25E 87.41' SET NAIL AND MDNR TAG W. FACE 24" WALNUT
 SOUTH 4.63' FOUND 1/2" IRON BAR AT SOUTHWEST CORNER OF SECTION 19 T4N-R9W
 EAST 5' CENTERLINE OF ROBINSON ROAD TO NORTH

Signed by Gary C. Bilow
 Surveyor's Michigan License No. 26453

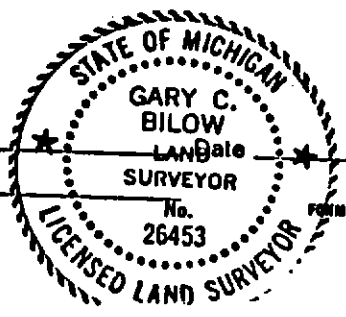

2/15/91

FORM APPROVED BY MICHIGAN STATE BOARD OF LAND SURVEYORS, JAN. 28, 1971
 REVISED MAY 14, 1978
 REVISED JAN., 1983