

LAND CORNER RECORDATION CERTIFICATE
Filing Requirement of Act 74, Mich. P.A. 1970

For corners in
BARRY

(County)	Located In:	Corner Code ##
1. Public Land Survey	T <u>4N</u> R <u>10W</u>	<u>M-7</u>
	T _____ R _____	_____
	T _____ R _____	_____
	T _____ R _____	_____
2. Property Controlling in Section	S _____ T _____ R _____	_____
	S _____ T _____ R _____	_____
3. Miscellaneous Property in Sec.	S _____ T _____ R _____	_____
	S _____ T _____ R _____	_____

Register of Deeds Stamp & File Number

4. Lot No. _____, Recorded Plat _____
 5. Private Claims _____

	A	B	C	D	E	F	G	H	I	J	K	L	M
2	6	5	4	3	2	1							
3													
4	7	8	9	10	11	12							
5													
6	16	17	18	15	14	13							
7													
8	19	20	21	22	23	24							
9													
10	30	28	28	27	26	25							
11													
12	31	32	33	34	35	36							
13													

I, GARY C. BILOW, in a field survey on AUGUST 29, 19 90, do hereby certify that under requirements of P.A. 74, Michigan P.A. of 1970, the corner points mentioned in lines 1 and 2 above were in conformance with regulations and rules therefore as required in the current manual of survey instructions of the United States Department of the Interior, Bureau of Land Management or by a decree of a Court of Law and/or that the corner points mentioned in lines 3, 4 and 5 above were in conformance with the rules of the Michigan Board of Land Surveyors or by a Decree of a Court of Law; established, re-established, monumented, re-monumented, recovered, found as expressed below:

NOTE: Not more than 4 corners, all in the same town and range, may be recorded on this certificate.

A. Description of original monument and accessories and/or subsequent restoration:
 CORNER POST ESTABLISHED IN 1926 BY U.S. GOVERNMENT DEPUTY SURVEYOR LUCIUS LYDM. HIS ACCESSORIES: W. OAK 15 S51W 23, W. OAK 9 N31W 79. CORNER REESTABLISHED AND RECORDED UNDER ACT 74, P.A. 1970 BY DOUGLAS W. BONNEMA IN 1980 BY SINGLE PROPORTIONATE MEASUREMENT BASED ON GLO RECORD BETWEEN M-3 AS REC. ON LCRC #14 AND M-8 AS REC. ON LCRC #29B. CORNER WAS SUBSEQUENTLY RESET BY ROBERT J. JONKER IN 1988 BY A SIMILAR METHOD FOLLOWING DESTRUCTION OF CORNER BY ROAD RECONSTRUCTION (SEE LCRC #387).

B. Description of corner evidence found and/or method applied in restoring or reestablishing corner:
 ORIGINAL CORNER POST AND ACCESSORIES NOT RECOVERED. FOUND NO RECORD OF PERPETUATION OF CORNERS M-7, M-6, M-5, M-4, OR M-3 IN COUNTY SURVEYORS RECORD OR IN COUNTY ROAD COMMISSION FILES. FOUND BUT DID NOT ACCEPT 1/2" REBAR SET BY JONKER. FROM EXAMINATION OF THE PATTERN OF OLD FENCE LINES IN N1/2 OF SECTION 24 AND S1/2 OF SECTION 13, I CONCLUDED THAT THE CORNER SHOULD BE REGARDED AS OBLITERATED AND NOT LOST. SPECIFICALLY, I RECOVERED AND ACCEPTED STONE AND BRICK AS CALLED FOR IN 1893 COUNTY SURVEYORS RECORD AT M-8 AND NOTED THAT 1/2" REBAR PREVIOUSLY RECORDED AS M-8 WAS EASTERLY, 3.78' DISTANT. THIS 1/2" REBAR HAD BEEN USED FOR PROPORTIONATE CONTROL BY BONNEMA TO SET M-7. AN OLD WIRE FENCE EXTENDS WESTERLY FROM THE STONE. I FOUND OLD WIRE FENCES EXTENDING WESTERLY FROM ROBERTSON ROAD AT THE FOLLOWING STATIONS NORTH OF THE STONE: 13+21.5, 26+42, 39+42, AND 52+45.7. ALL OF THESE FENCE LINES NORTH OF M-8 ARE VERY OLD AND IN ADVANCED STAGES OF DISREPAIR. SUPPORTING POSTS ARE VIRTUALLY NONEXISTENT AND THE WIRE STRANDS LAY ON THE GROUND, OCCASIONALLY RISING WHERE FIXED IN TREES. THE ROAD IS IN CUT SECTION AT M-6 AND M-7. HOLES WERE EXCAVATED AT EACH LOCATION WITH NOTHING FOUND. I FOUND NO ACCEPTABLE CORNERS BETWEEN M-8 AND M-3 AND NO ACCEPTABLE EVIDENCE OF THE RANGE LINE ON THE GROUND. THERE IS A 500' LONG SECTION OF OLD FENCE EXTENDING SOUTHERLY FROM THE EAST 1/8 CORNER LOCATION OF THE SE 1/4 OF SECTION 13 BUT ITS DIRECTION IS SUCH THAT WHEN PRODUCED NORTH AND (SEE BACK OF SHEET FOR REMAINDER)

C. Description of monument for corner and accessories established to perpetuate locating the position of the corner:
 SET 1/2"x3/4" REBAR ENCASED IN A 4" DIA. CONCRETE CYLINDER AND CAPPED WITH A CAST ALUMINUM MICHIGAN DEPT. OF NATURAL RESOURCES TABLET 8" BELOW THE GRAVEL SURFACE OF ROBERTSON ROAD.

S84E 96.86' FND PK NAIL S. FACE POWER POLE
 S54W 67.23' FND NAIL IN S. FACE TWIN 12" OAK
 N80W 52.86' FND NAIL IN S. FACE 12" OAK
 S05E 33.67' FND 1/2" REBAR AND CAP #21572 REC. AS
 A-7, T4N-R9W ON LCRC #385

S22E 88.26' SET NAIL AND MDNR TAG IN W. FACE 18" OAK
 S44W 82.13' SET NAIL AND MDNR TAG IN S. FACE 9" PINE
 S19E 8.23' FND 1/2" REBAR AND CAP #21572 REC. AS M-7 ON LCRC #387

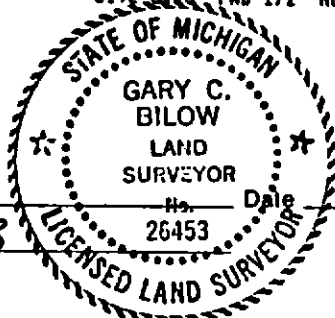

Signed by Gary C. BiLow
 Surveyor's Michigan License No. 26453

2/15/91