

APR 08 1996

COMMISSION

Barry County Remonumentation

LAND CORNER RECORDATION CERTIFICATE
Filing Requirement of Act 74, Mich. P.A. 1970

STATE OF MICHIGAN
COUNTY OF BARRY
RECEIVED FOR RECORD

NOV 20 8 35 AM '95

Sandy Schondelmayer
REGISTER OF DEEDS

002318

Register of Deeds Stamp & File Number

For corners in

Barry (County)	Located In:	Corner Code #
1. Public Land Survey	4N 10W T ___ R ___ T ___ R ___ T ___ R ___ T ___ R ___	A-4 (W 1/4, 7) Thornapple-Twp. _____ _____
2. Property Controlling in Section	S ___ T ___ R ___ S ___ T ___ R ___	_____ _____
3. Miscellaneous Property in Sec.	S ___ T ___ R ___ S ___ T ___ R ___	_____ _____
4. Lot No. _____, Recorded Plat _____		
5. Private Claims _____		

I, Steven Koerber, in a field survey on August 31, 19 95, do hereby certify that under requirements of P.A. 74, Michigan P.A. of 1970, the corner points mentioned in lines 1 and 2 above were in conformance with regulations and rules therefore as required in the current manual of survey instructions of the United States Department of the Interior, Bureau of Land Management or by a decree of a Court of Law and/or that the corner points mentioned in lines 3, 4 and 5 above were in conformance with the rules of the Michigan Board of Land Surveyors or by a Decree of a Court of Law; established, re-established, monumented, re-monumented, recovered, found as expressed below:

NOTE: Not more than 4 corners, all in the same town and range, may be recorded on this certificate.

A. Description of original monument and accessories and/or subsequent restoration:

- A-4 GLO (no post set)
 - April 5, 1972 LCRC No. 26 Douglas Bonnema (Barry Co.)
Set 3/4" I.P. on centerline gravel road N-S and between fences E-W.
Nail in side of P. Pole East 62.43'
Nail in side of 20" Walnut S-SE 161.79'

(additional info. see back of sheet)

B. Description of corner evidence found and/or method applied in restoring or reestablishing corner:

- A-4 Found 3/4" Iron Pipe
Found PK nail in N. side P. pole East 62.45'
Found JCB capped rerod East 33.0'
Found PK nail in W. side P. pole S25°E 176.32'
C/L Bit. pavement East 1.0'
C/L Gravel drive to East S. 16'

ACT 345 BARRY COUNTY REMONUMENTATION
APPROVED BY PEER REVIEW AT A MEETING HELD ON
August 14, 1995 BR
BRIAN REYNOLDS COUNTY SURVEYOR

C. Description of monument for corner and accessories established to perpetuate locating the position of the corner:

- A-4 Replaced 3/4" Iron pipe with Standard Allegan Co. Mon. (3/4" x 24" Iron Rod with cap)
Set nail & Allegan Co. Remon. Tag in N. side P. Pole N 90° E 62.46'
Set nail & Allegan Co. Remon. Tag in SW side P. Pole S 20° E 176.29'
Set 3/4" x 24" Iron rod with Allegan Co. Remonumentation witness cap N 90° W 50.00'
JCB capped rerod East 33.0'
C/L Bit. pavement East 1.0'
C/L Gravel drive to East S. 16'
A-4 corner is a common corner with M-4, Leighton Township, Allegan County.

Signed by Steven C. Koerber Date 11-13-1995
Surveyor's Michigan License No. 39085

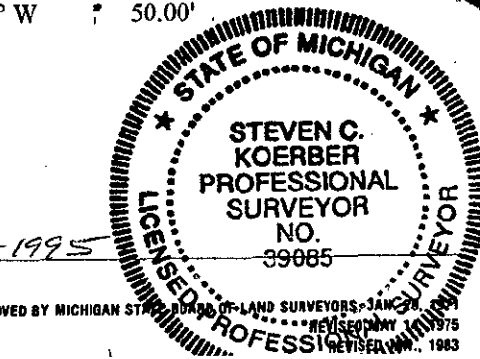

2. April, 27, 1972
Barry County Road Comm.
Iron
Fnc. post West 44.0'
Iron stake East 33.0'
P. pole East 62.1'
3. Sept. 16, 1982
C.S. Hay & Assoc.
Recorded survey L. 1, Pg. 726 (Barry Co)
Found 3/4" I.P. over soild rod
PK nail in N. side P. pole East 62.45'
PK nail in W. side P. pole SE 176.37'
C/L Bit. road East 1.0±
4. May 11, 1983 Jonker Land Surveys witnesses
Found 3/4" round iron
C/L Bit road ±
Found PK nail in N. side P. pole N90°E 62.50
Found PK Nail in W. side P. pole S20°E 176.4'
Rivet on N. end CMP N35°W 34.47
5. Sept. 23, 1985
Jonker Land Surveys
Recorded survey L. 1, Pgs. 884-886 (Barry Co.)
Found 3/4" I.P.
Nail in P. pole East 62.43'
Nail in P. pole S-SE 176.37'
C/L Bit. East 1.0'
6. October 30, 1987
Jonker Land Surveys witnesses
3/4" Iron Pipe
Nail in P. pole East 62.43'
Nail in P. pole SSE 176.37'
C/L Bit Pavement East 1.0'
7. July, 1991
MBN Eng. / Surv.
Recorded Survey L. 2, Pg. 44 (Barry Co.)
Found 1/2" Iron Rod per LCRC 176
8. Dec. 2, 1993
Exxel Eng.
Recorded Survey L. 2, Pg. 86-88 (Barry Co.)
Found 1" I.P.
PK in W. side P. pole N10°W 326.20'
PK in N. side P. pole N90°E 62.49'
PK in SW side P. pole S35°E 176.36'
NE cor. brick hse. S10°W 412.56'

