

APR 08 1996

COMMISSION

Barry County Remonumentation

LAND CORNER RECORDATION CERTIFICATE
Filing Requirement of Act 74, Mich. P.A. 1970

STATE OF MICHIGAN
COUNTY OF BARRY
RECEIVED FOR RECORD

Nov 20 8 35 AM '95

Sandy Schondelmayr
REGISTER OF DEEDS

002320

Register of Deeds Stamp & File Number

For corners in

Barry (County)	Located In:	Corner Code #
	4N 10W	A-7(SW, 18)
1. Public Land Survey	T ___ R ___	Thornapple Twp. ___
	T ___ R ___	___
	T ___ R ___	___
	T ___ R ___	___
2. Property Controlling in Section	S ___ T ___ R ___	___
	S ___ T ___ R ___	___
3. Miscellaneous Property in Sec.	S ___ T ___ R ___	___
	S ___ T ___ R ___	___

4. Lot No. _____, Recorded Plat _____
5. Private Claims _____

	A	B	C	D	E	F	G	H	I	J	K	L	M
2	6		5		4		3		2		1		
3													
4	7		8		9		10		11		12		
5													
6	18		17		16		15		14		13		
7													
8	19		20		21		22		23		24		
9													
10	30		29		28		27		26		25		
11													
12	31		32		33		34		35		36		
13													

I, Steven Koerber, in a field survey on August 31, 19 95, do hereby certify that under requirements of P.A. 74, Michigan P.A. of 1970, the corner points mentioned in lines 1 and 2 above were in conformance with regulations and rules therefore as required in the current manual of survey instructions of the United States Department of the Interior, Bureau of Land Management or by a decree of a Court of Law and/or that the corner points mentioned in lines 3, 4 and 5 above were in conformance with the rules of the Michigan Board of Land Surveyors or by a Decree of a Court of Law; established, re-established, monumented, re-monumented, recovered, found as expressed below:

NOTE: Not more than 4 corners, all in the same town and range, may be recorded on this certificate.

A. Description of original monument and accessories and/or subsequent restoration:

- A-7 GLO Sylvester Sibley DS, 1830
Corner 8 links North of Leighton Twp. corner = 5.28'
A Sugar 16 S 56 E 3 1/2
A Beech 8 N 36 E 32
- 1. Identified by U.S. Bearings Lee Cobb
Book 9, Pg. 109 Aug. 22&23 1890
(Additional info. see back of sheet)
- 2. Dec. 23, 1980
LCRC recorded as NO. 307(Barry Co.)
Carl Shangraw
Found 5/8" iron rod
PK nail in 12" Oak S80°E 43.05'
PK nail in 10" Walnut S40°E 74.56'
PK nail in Fence post N40°E 49.04'

B. Description of corner evidence found and/or method applied in restoring or reestablishing corner:

- A-7 Found 5/8" x 18" Iron rod
Found 5/8" Iron rod South 5.30'
Found PK nail c/l top wood post N50°E 49.35'
Found PK nail in face wood post N50°E 49.08'
Found PK nail in SW side 16" Walnut S40°E 74.98'
Found nail & Tag in N. side P. pole N70°E 90.00'

ACT 345 BARRY COUNTY REMONUMENTATION
APPROVED BY PEER REVIEW AT A MEETING HELD ON

August 14, 1995 BR
BRIAN REYNOLDS COUNTY SURVEYOR

C. Description of monument for corner and accessories established to perpetuate locating the position of the corner:

- A-7 Replaced 5/8" Iron Rod with Barry Co. Mon. (3/4" x 24" Iron Rod with cap)
- Set nail & Allegan Co. Remon. Tag in NW side wood fence post N 35° E 57.91'
- Set nail & Allegan Co. Remon. Tag in SW side 16" Walnut S 40° E 75.00'
- Set PK nail & Allegan Co. Remon. Tag in SW side P. Pole N 40° W 44.75'
- PK nail c/l top wood post N 50° E 49.35'
- PK nail in face wood post N 50° E 49.08'
- Nail & Tag in N. side P. pole N 70° E 90.00'
- PK nail in SW side 16" Walnut S 40° E 74.98'
- M-7 Corner, Leighton Twp., Allegan Co., is 8 links (5.28') South

Signed by Steven C. Koerber Date 11-13-1995
Surveyor's Michigan License No. 39085

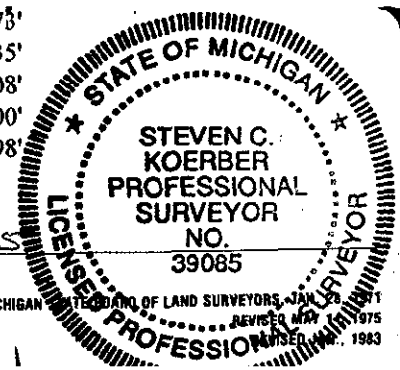

3. Dec 28, 1979
Moore & Bruggink
Recorded survey L. 1, Pg. 639 (Barry Co)
5/8" Iron rod
PK nail in 12" Oak S80°E 43.05'
PK nail in 10" Walnut S40°E 74.56'
PK nail in Fence post N40°E 49.04'

4. Finkbeiner road plans 1989-90
Barry Co. Rd. Comm.
5/8" iron rod
PK in 12" Oak S80°E 45.03'
PK in 10" Walnut S40°E 74.56'
PK in Fence post N40°E 49.04'

