

APR 08 1996

BARRY COUNTY REMONUMENTATION

STATE OF MICHIGAN  
COUNTY OF BARRY  
RECEIVED FOR RECORD

DEC 15 2 07 PM '95

COMMISSION

LAND CORNER RECORDATION CERTIFICATE  
Filing Requirement of Act 74, Mich. P.A. 1970

Sandy Schondelmar  
REGISTER OF DEEDS

For corners in

**BARRY**

(County)

Located In:

Corner Code #

- 1. Public Land Survey T 4N R 10W J-4  
T R  
T R  
T R
- 2. Property Controlling S T R  
in Section S T R  
3. Miscellaneous S T R  
Property in Sec. S T R
- 4. Lot No. , Recorded Plat
- 5. Private Claims

002339

Register of Deeds Stamp & File Number

I, **BRIAN REYNOLDS**, in a field survey on SEPT 5, 1995, do hereby certify that under requirements of P.A. 74, Michigan P.A. of 1970, the corner points mentioned in lines 1 and 2 above were in conformance with regulations and rules therefore as required in the current manual of survey instructions of the United States Department of the Interior, Bureau of Land Management or by a decree of a Court of Law and/or that the corner points mentioned in lines 3, 4 and 5 above were in conformance with the rules of the Michigan Board of Land Surveyors or by a Decree of a Court of Law; established, re-established, monumented, re-monumented, recovered, found as expressed below:

A	B	C	D	E	F	G	H	I	J	K	L	M
2	6	5	4	3	2	1						
3												
4	7	8	9	10	11	12						
5												
6	18	17	16	15	14	13						
7												
8	19	20	21	22	23	24						
9												
10	30	29	28	27	26	25						
11												

**NOTE: Not more than 4 corners, all in the same town and range, may be recorded on this certificate.**

ACT 345 BARRY COUNTY REMONUMENTATION  
APPROVED BY PEER REVIEW AT A MEETING HELD ON  
OCT 9, 1995  
**BRIAN REYNOLDS** COUNTY SURVEYOR

A. Description of original monument and accessories and/or subsequent restoration:

- 1. CORNER NOT SET BY GENERAL LAND OFFICE SURVEY
- 2. NO RECORD OF THIS CORNER FOUND IN THE RECORDS OF THE COUNTY SURVEYOR
- 3. LAND CORNER RECORDATION CERTIFICATE #120 BY D. BONNEMA, RECORDED JUNE 11, 1974  
"SET 3/4" IRON AT INTERSECTION OF 1/4 LINES." NAIL IN SDE 12" OAK NW 21.69'; NAIL IN SDE 20" WILD CHERRY SW 21.15'; NAIL IN SDE 6" PINE NE 32.03'; E&W FENCE SOUTH 9'; N&S TREE LINE WEST 18'
- 4. COUNTY ROAD COMMISSION NOTES: WITNESSES SAME AS IN L.C.R.C. #120 ABOVE
- 5. ACT 132 SURVEYS BY BONNEMA RECITE THE SAME WITNESSES AS IN LCRC #120 ABOVE; L.1,P.187-188, L.1,P.242, L.1,P.266, L.1,P.418, L.1,P.534

B. Description of corner evidence found and/or method applied in restoring or reestablishing corner:

FOUND IRON AND WITNESSES BY BONNEMA. POSITION OF INTERSECTION OF 1/4 LINES BY BONNEMA WAS BASED, IN PART, ON I-4 RESTORED MIDWAY ON LINE BETWEEN I-3 AND I-5. A SUBSEQUENT RESURVEY OF SECTION 10 RECOVERED G-4 AS PERPETUATE BY LEE S. COBB, COUNTY SURVEYOR, IN 1888, AND H-4 AS SET BY COUNTY SURVEY GEORGE MANCHESTER, PERPETUATED BY COBB AT INTERSECTION OF 1/4 LINES. COBB RAN BOTH 1/4 LINES TO CONFIRM MANCHESTER'S POSITION. BONNEMA HAD NOT RECOVERED EITHER OF COBB'S CORNERS RECITED ABOVE. THUS DID NOT BASE HIS RESTORATION OF I-4 ON THAT INFORMATION. I-4 RESTORED BASED ON THE COBB SURVEY IS 12.73' SOUTH OF POSITION BY BONNEMA. J-4 SET AT INTERSECTION OF RESTORED 1/4 LINES IS 6.42 FEET SOUTH OF POSITION PREVIOUSLY RECORDED BY BONNEMA. WHILE NO RECORD CAN BE FOUND OF THE COUNTY SURVEYOR WORKING IN SECTION 11, THE EXISTANCE OF THE OLD EAST-WEST FENCE INDICATES A SURVEY MANY YEARS AGO OF THE EAST-WEST 1/4 LINE. RESTORED J-4 FITS THE OLD FENCE MUCH BETTER. DISREGARDED POSITION PREVIOUSLY RECORDED BY BONNEMA, SET REMON IRON AND CAP AT INTERSECTION OF RESTORED 1/4 LINES. NOTE: THE 1895 AND 1913 COUNTY ATLAS INDICATE COMMON OWNERSHIP ACROSS NORTH-SOUTH 1/4 LINE SOUTH OF CENTER OF SECTION, THUS THE OLD FENCE AND TREE ROW SOUTH IS PROBABLY NOT A SIGNIFICANT INDICATION OF 1/4 LINE LOCATION.

C. Description of monument for corner and accessories established to perpetuate locating the position of the corner:

SET STANDARD BARRY COUNTY REMONUMENTATION MONUMENT (3/4"X36"W/ALUMINUM CAP)

- FOUND NAIL IN THE SOUTHWEST SIDE OF A 22" OAK N32°W 26.80'
- FOUND HOESSHOE NAIL IN THE SOUTH SIDE OF A 28" TWIN OAK N76°W 31.82'
- SET 20d NAIL W/PLASTIC TAG IN THE NORTH SIDE OF A 40" TWIN CHERRY S85°W 17.82'
- SET 20d NAIL W/PLASTIC TAG IN THE SOUTH SIDE OF AN 18" OAK N65°W 43.97'
- EAST-WEST FENCE SOUTH 2.5'+/- MUCH DECAYED FENCE RUNNING SOUTH 16'+/- WEST
- CAPPED PIPE BY BONNEMA N00°37'W 6.42'

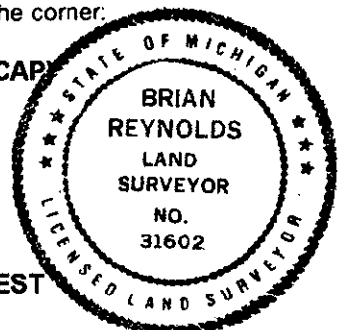

Signed by [Signature] Date 12/15/95  
 Surveyor's Michigan License No. 31602