

APR 08 1996

BARRY COUNTY REMONUMENTATION

STATE OF MICHIGAN  
COUNTY OF BARRY  
RECEIVED FOR RECORD

DEC 15 2 07 PM '95

COMMISSION

LAND CORNER RECORDATION CERTIFICATE  
Filing Requirement of Act 74, Mich. P.A. 1970

Sandy Schindelmarper  
REGISTER OF DEEDS

002342

Register of Deeds Stamp & File Number

For corners in

BARRY

(County)

Located in:

Corner Code #

1. Public Land Survey	T	4N	R	10W	K-3
1/4 CORNER COMMON TO SECTIONS 1,2,11, &12 THORNAPPLE TOWNSHIP	T		R		
2. Property Controlling in Section	S		T	R	
3. Miscellaneous Property in Sec.	S		T	R	

- 4. Lot No. \_\_\_\_\_, Recorded Plat \_\_\_\_\_
- 5. Private Claims \_\_\_\_\_

A	B	C	D	E	F	G	H	I	J	K	L	M
2	6	5	4	3	2	1						
3												
4	7	8	9	10	11	12						
5												
6	18	17	16	15	14	13						
7												
8	19	20	21	22	23	24						
9												
10	30	29	28	27	26	25						
11												
12	31	32	33	34	35	36						
13												

I, **BRIAN REYNOLDS** in a field survey on **6 SEPT.** 19 **95**

do hereby certify that under requirements of P.A. 74, Michigan P.A. of 1970, the corner points mentioned in lines 1 and 2 above were in conformance with regulations and rules therefore as required in the current manual of survey instructions of the United States Department of the Interior, Bureau of Land Management or by a decree of a Court of Law and/or that the corner points mentioned in lines 3, 4 and 5 above were in compliance with the rules of the Michigan Board of Land Surveyors or by a Decree of a Court of Law; established, re-established, monumented, re-monumented, recovered, found as expressed below:

**NOTE: Not more than 4 corners, all in the same town and range, may be recorded on this certificate.**

A. Description of original monument and accessories and/or subsequent restoration:

- 1. "GENERAL LAND OFFICE: SYLVESTER SIBLEY, D.S., 1830 (R10W,P.162)  
A. W. OAK 7 S34 1/2W 25 Do. 28 N28E 77
- 2. COUNTY SURVEYOR RECORDS: CRESSEY, 1874 (L.1,P.35) W.O. 12 N47E 68 1/2
- 3. COUNTY SURVEYOR LEE S. COBB, OCT, 1910 (THORN. F.B.,P.88) "FOUND STAKE, SET CAST WAGON SKIEN AND STONE MAPLE 14 N55°W 85 1/2LKS B. WALNUT 4 N7°W 78LKS
- 4. LAND CORNER RECORDATION CERTIFICATE: #120 BY D. BONNEMA, P.S.#12579 "FOUND 3/4" IRON CHECKS WITH PREVIOUS WITNESSES" NAIL IN SDE 40" WALNUT NORTH 49.61' NAIL IN SDE 12" WALNUT SW 53.72' NAIL IN SDE 18" OAK SE 50.78' C/L NORTH 4.5'
- 5. COUNTY ROAD COMMISSION: RECITE SAME WITNESSES AS BONNEMA AS IN L.C.R.C. #120 ABOVE  
**SEE REVERSE OF THIS FORM FOR MORE HISTORICAL INFORMATION**

B. Description of corner evidence found and/or method applied in restoring or reestablishing corner:

**FOUND 3/4" IRON AND WITNESSES (SOME OVERGROWN)RECORDED BY BONNEMA (WALNUT NORTH, OAK SE, WALNUT SW) SEARCHED FOR, DID NOT FIND WAGON SKEIN. ROAD SURFACE IS IN A DEEP CUT AREA, ANY ORIGINAL MONUMENTATION HAS MOST LIKELY BEEN DESTROYED BY ROAD CONSTRUCTION. BONNEMA'S WITNESS TREE, 40" WALNUT N. 49.61, IS BELIEVED TO BE THE SAME TREE USED BY COBB IN HIS SURVEY IN OCTOBER OF 1910, B. WALNUT 4 N7°W 78lks. BEARING TO THE 40" WALNUT IS SLIGHTLY WEST OF DUE NORTH. BEARING AND DISTANCE TO REMAINING WITNESS FROM COBB 1910, REASONABLY MATCH. ACCEPTED FOUND 3/4" IRON AS BEST EVIDENCE OF CORNER POSITION. REPLACED 3/4" IRON WITH STANDARD BARRY COUNTY REMONUMENTATION MONUMENT.**

ACT 345 BARRY COUNTY REMONUMENTATION  
APPROVED BY PEER REVIEW AT A MEETING HELD ON

9/14/95 BR  
BRIAN REYNOLDS COUNTY SURVEYOR

C. Description of monument for corner and accessories established to perpetuate locating the position of the corner:

- SET STANDARD BARRY COUNTY REMONUMENTATION MONUMENT (3/4"X36"W/ALUMINUM CAP)
- SET 40d NAIL W/PLASTIC TAG IN THE SOUTHEAST SIDE OF A UTILITY POLE N55°E 76.89'
- SET 40d NAIL W/PLASTIC TAG IN THE NORTH SIDE OF A 16" B. WALNUT (OVER BONNEMA'S WITNESS) S62°W 53.75'
- SET 40d NAIL W/PLASTIC TAG IN THE EAST SIDE OF A 42" B. WALNUT (BONNEMA'S TREE) N6°W 49.45'
- FOUND SQUARE NAIL IN NORTH SIDE OF AN 18" OAK S73°E 50.81'
- CENTERLINE STRIPE EAST-WEST ROAD (PARMALEE ROAD) LIES NORTH 5'+/-
- CORNER IS IN LINE WITH TREE LINE SOUTH AND WITH FENCE NORTH.

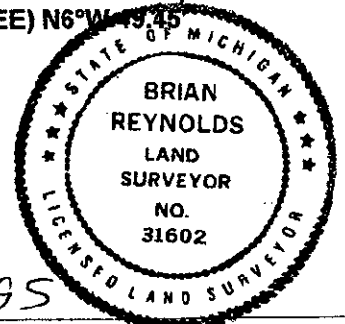

Signed by [Signature]  
Surveyor's Michigan License No. 31602

Date 12/15/95

ACT 132 SURVEYS: BY D. BONNEMA, P.S.#12579 L.1,P.187 L.1,P.534 SAME WITNESSES AS IN L.C.R.C #120 ABOVE

ACT 132 SURVEYS: ALSO BY BONNEMA, L.2,P.6-7 L.2,P.52 PK IN TOP WOOD FENCE POST NORTH 41.35'  
SPK NE SDE 24" OAK SE 50.72' SPK W SDE 30" OAK SOUTH 38.11' C/L B.T. NORTH 4.5'

ACT 132 SURVEY: BY G. NEDERVELD, P.S.#21272 L.1,P.943 NAIL IN NW SIDE 16" LOCUST SW 53.80  
NAIL IN W SIDE 24" OAK SSE 38.14' PK IN TOP FENCE POST N41.33'

ACT 138 SURVEY: BY R.D.UNEMA, P.S.#33987 L.2,P.11-12 "3/4" IRON" WITNESSES SAME AS IN L.2,P.6-7 ABOVE