

SECTION

BAY COUNTY REMONUMENTATION 1999  
LAND CORNER RECORDATION CERTIFICATE  
Filing Requirement of Act 74, Mich. P.A. 1970

For corners in

**MERRITT TOWNSHIP**

BAY Located in: Corner Code #  
(County)

1. Public Land Survey T 13N R 6E C-12  
T \_\_\_\_\_ R \_\_\_\_\_

2. Property Controlling S \_\_\_\_\_ T \_\_\_\_\_ R \_\_\_\_\_

3. Miscellaneous S \_\_\_\_\_ T \_\_\_\_\_ R \_\_\_\_\_  
Property in Sec. S \_\_\_\_\_ T \_\_\_\_\_ R \_\_\_\_\_

Bridget Jones, Notary Public  
REGISTER OF DEEDS  
BAY COUNTY, MICHIGAN

1999 DEC 29 P 12:53

RECORDED

Register of Deeds Stamp & File Number

4. Lot No. \_\_\_\_\_, Recorded Plat \_\_\_\_\_  
5. Private Claims \_\_\_\_\_

I, BRIAN D FERGUSON, in a field survey on MAY, 19 99 do hereby state that under requirements of P.A. 74, Michigan P.A. of 1970, the corner points mentioned in lines 1 and 2 above were in conformance with regulations and rules therefore as required in the current manual of survey instructions of the United States Department of the Interior, Bureau of Land Management or by a decree of a Court of Law and/or that the corner points mentioned in lines 3, 4 and 5 above were in conformance with the rules of the Michigan Board of Land Surveyors or by a Decree of a Court of Law; established, re-established, monumented, recovered, found as expressed below:

NOTE: Not more than 2 corners, all in the same town and range, may be recorded on this certificate.

1	A	B	C	D	E	F	G	H	I	J	K	L	M
2		6		5		4		3		2		1	
3													
4		7		8		9		10		11		12	
5													
6		18		17		16		15		14		13	
7													
8		19		20		21		22		23		24	
9													
10		30		29		28		27		26		25	
11													
12		31		32		33		34		35		36	
13													

A. Description of original monument and accessories and/or subsequent restoration:

WOOD POST SET BY J. WAMPLER, DS, IN 1821. NO EVIDENCE OF ORIGINAL CORNER REMAINS.  
LCRC BY DE LA MATER, L001 P49, IN 1971  
LCRC FBY MCGINNIS, L001 P79, IN 1972  
COS BY DE LA MATER, L652 P340  
COS BY MCGINNIS, L812 P238

B. Description of corner evidence found and/or method applied in restoring or reestablishing corner:

FOUND PK NAIL PER WITNESSES FROM LCRC'S & COS'S  
MEASURED 2632.84' TO C-11 (REC 2633.33' L652 P340)

ACCEPTED AS THE BEST AVAILABLE EVIDENCE OF THE LOCATION OF THE ORIGINAL CORNER

C. Description of monument for corner and accessories established to perpetuate locating the position of the corner:

SET 5/8" RE-BAR W / BAY COUNTY REMON. BRASS CAP & NO. 26454 IN MONUMENT BOX  
N55W 48.14' N&T SW FCE PWR POLE (REC 48.14' LCRC'S AND I812 P238)  
S45E 74.93' SET NAIL NW FCE PWR POLE  
S45W 29.01' SET REBAR 6' OFF EDGE OF ROAD  
N45E 27.66' SET REBAR 6' OFF EDGE OF ROAD

Signed by Brian D Ferguson Date December 15, 1999  
Surveyor's Michigan License No. 26454

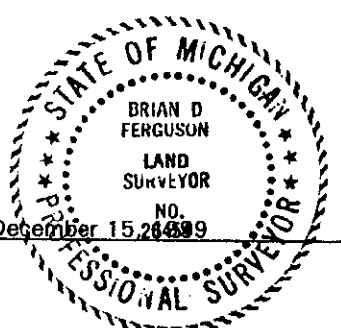

APPROVED LAND CORNER  
P.A. 345 OF 1990 - Bay County  
Date 6.24.99  
MM  
Michael MacDonald P.S.

FORM APPROVED BY MICHIGAN STATE BOARD OF PROFESSIONAL SURVEYORS, JAN. 28, 1971  
REVISED MAY 14, 1975  
REVISED JAN., 1983  
REVISED OCT., 1995

004 345