

SECTION

BAY COUNTY REMONUMENTATION  
LAND CORNER RECORDATION CERTIFICATE  
Filing Requirement of Act 74, Mich. P.A. 1970

For corners in

BAY COUNTY  
(County)

Located In:

Corner Code #

- 1. Public Land Survey      T 14N R 5E      E-7
- T \_\_\_\_\_ R \_\_\_\_\_
- T \_\_\_\_\_ R \_\_\_\_\_
- T \_\_\_\_\_ R \_\_\_\_\_
- 2. Property Controlling      S \_\_\_\_\_ T \_\_\_\_\_ R \_\_\_\_\_
- in Section                    S \_\_\_\_\_ T \_\_\_\_\_ R \_\_\_\_\_
- 3. Miscellaneous              S \_\_\_\_\_ T \_\_\_\_\_ R \_\_\_\_\_
- Property in Sec.            S \_\_\_\_\_ T \_\_\_\_\_ R \_\_\_\_\_

*Walter James MacFarlane*  
 REGISTER OF DEEDS  
 BAY COUNTY, MICHIGAN

2000 JAN -7 P 2:00

RECORDED

Register of Deeds Stamp & File Number

4. Lot No. \_\_\_\_\_, Recorded Plat \_\_\_\_\_

5. Private Claims \_\_\_\_\_

I, DALE L. WINIECKE, in a field survey on OCTOBER 29, 1999 do hereby state that under requirements of P.A. 74, Michigan P.A. of 1970, the corner points mentioned in lines 1 and 2 above were in conformance with regulations and rules therefore as required in the current manual of survey instructions of the United States Department of the Interior, Bureau of Land Management or by a decree of a Court of Law and /or that the corner points mentioned in lines 3, 4 and 5 above were in conformance with the rules of the Michigan Board of Land Surveyors or by a Decree of a Court of Law; established, re-established, monumented, recovered, found as expressed below:

NOTE: Not more than 2 corners, all in the same Town and Range, may be recorded on this certificate.

1	A	B	C	D	E	F	G	H	I	J	K	L	I
2		6		5		4		3		2		1	
3													
4		7		8		9		10		11		12	
5													
6		18		17		16		15		14		13	
7													
8		19		20		21		22		23		24	
9													
10		30		29		28		27		26		25	
11													
12		31		32		33		34		35		36	
13													

A. Description of original monument and accessories and/or subsequent restoration:

- E-7  
POST SET BY J. WAMPLER, 1821  
10" WHITE OAK N8°W 35 LINKS  
8" WHITE OAK N71°E 35 LINKS
- EDMANDS ENGINEERING SURVEY #533, 1958, NO WITNESSES
- CERTIFICATE OF SURVEY, L. 676, P. 477, 1972, L. MCGINNIS, PS#18999, NO WITNESSES
- PLAT OF THE CORBIN ADDITION TO WENONA, L. 1, P. 73, BAY COUNTY RECORDS
- PLAT OF THE KINGSBURGH, L. 1, P. 77, BAY COUNTY RECORDS
- PLAT OF MRS. E.P. BIRNEYS SUBDIVISION, L. 1, P. 79, BAY COUNTY RECORDS

B. Description of corner evidence found and/or method applied in restoring or reestablishing corner:

E-7  
SEARCHED THE APPARENT LOCATION OF THE CORNER AND FOUND A PK NAIL IN THE INTERSECTION OF STATE STREET AND NORTH UNION. NO INFORMATION AVAILABLE AS TO THE RECORD OF THE NAIL.

ESTABLISHED CORNER BY EXTENDING LINE FROM D-7 THROUGH 1/8 CORNER TO THE EAST AND DOUBLING DISTANCE. DISTANCES FROM EDMANDS ENGINEERING SURVEY #533 CHECKS ±0.1'. VERIFIED DISTANCE NORTH FROM L. 676, P. 477 CHECKS 653.86(M) 653.26'(R).

POSITION ACCEPTED AS THE BEST EVIDENCE OF THE POSITION OF THE ORIGINAL CORNER.

C. Description of monument for corner and accessories established to perpetuate locating the position of the corner:

E-7  
SET 5/8"X 24" REROD WITH BAY COUNTY REMONUMENTATION CAP IN MONUMENT BOX.  
N43°E 65.48' TO SW CORNER BLOCK FOUNDATION HSE #300 STATE STREET.  
S50°E 55.78' TO NW CORNER BRICK FACIA HSE #220 STATE STREET.  
S28°W 76.65' SET NAIL AND TAG IN NW FACE 18" CHESTNUT.  
N56°W 41.43' TO TOP CENTERLINE OF HYDRANT.  
N30°W 100.19 TO SE CORNER BLOCK FOUNDATION HOUSE, NO NUMBER  
WEST ±0.5 TO PHYSICAL CENTERLINE OF STATE STREET NORTH.  
ON THE PHYSICAL CENTERLINE OF NORTH UNION STREET WEST.

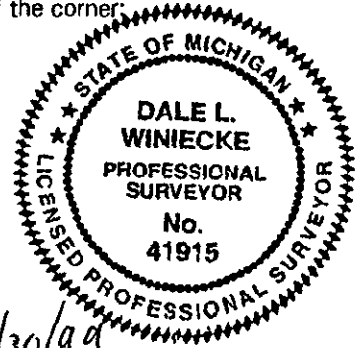

Signed by Dale Winiecke

Date 12/30/99

Surveyor's Michigan License No. 41915