

MAR 17 1999

LAND CORNER RECORDATION CERTIFICATE
Filing Requirement of Act 74, Mich. P.A. 1970

SECTION

For corners in

Bay
(County)

Located In:
Mt. Forest Twp.

Corner Code #

1. Public Land Survey

T 17 N R 3 E A-11

T _____ R _____

T _____ R _____

T _____ R _____

2. Property Controlling
in Section

S _____ T _____ R _____

S _____ T _____ R _____

3. Miscellaneous
Property in Sec.

S _____ T _____ R _____

S _____ T _____ R _____

4. Lot No. _____, Recorded Plat _____

5. Private Claims _____

I, Ronald C. Prevost, in a field survey on 6-23, 1998 do hereby state that under requirements of P.A. 74, Michigan P.A. of 1970, the corner points mentioned in lines 1 and 2 above were in conformance with regulations and rules therefore as required in the current manual of survey instructions of the United States Department of the Interior, Bureau of Land Management or by a decree of a Court of Law and /or that the corner points mentioned in lines 3, 4 and 5 above were in conformance with the rules of the Michigan Board of Land Surveyors or by a Decree of a Court of Law; established, re-established, monumented, recovered, found as expressed below:

NOTE: Not more than 2 corners, all in the same town and range, may be recorded on this certificate.

A. Description of original monument and accessories and/or subsequent restoration:

- A-11 Post set by H. Parke/Robert Clark Jr. D.S. 1831
Hemlock 12" S.57 1/2°W. 7 Lks.
Hemlock 8" N.19°W. 28 Lks.
3/4" pipe set by Martin #4699, after digging suspect area and finding nothing, 2-3-75, survey dwg no A-9659-1-2.
LCRC L2, P185 3/4" pipe set 2-3-75, J. Martin #4699, recorded 6-16-75.
LCRC L2, P421 iron set 1-75, L. McGinnis #18999, recorded 3-21-77.
LCRC #192 Gladwin Co. (M-11) common corner 3/4" pipe found J. Sedgman recorded 7-18-77.
Act 132 L001, P767 Gladwin Co. (M-11) common corner 3/4" pipe Sedgman 5-2-77.
Survey by John Meyers Section 36, T.17 N.-R.2 E., Gladwin Co. (M-11) common corner. 3/4" pipe, 1990
Survey by Wade Trim Section 31, T.17 N.-R.3 E., Bay Co. iron 11-13-90.
Poor copy of notes furnished by John Meyer: Shows 3/4" pipe and 3/8" rod 1.65N, 0.2 E.
Copy of Witnesses, furnished by John Meyers, Gladwin Co. (M-11) common corner. 1996/1997.
Project No. 94-13, Re: preservation and restoration of Gov't corners. 3/4" pipe.

B. Description of corner evidence found and/or method applied in restoring or reestablishing corner:

- A-11 Found 3/4" pipe, also found 1/2" re-bar 1.65± N. & 0.30± E.
From Martin survey notes 1975 and LCRC L2, P185 3/4" pipe.
N.E. 49.18 face tel. pole ok.
N.W. 73.01 face tel. pole ok.
From LCRC #192 Gladwin Co. & Act 132 L001, P767, Proj. #94-13 restoration & preservation 3/4" pipe.
N.50°E. 49.48 tel. pole. (49.50M).
N.25°W. 73.33 pow pole. (73.45M).
From copy of witnesses project No. 94-13 preservation & restoration of Gov't corner Gladwin Co. (M-11) 3/4" pipe.
S.45°E. 6" Poplar nail & tag 68.95 (68.95M).
From LCRC L002, P421, and wit survey job #ELS 2047.37.
NW 71.85 face 72.14 nail in U.P. ok for 1/2" rod.

Accepted as the best available evidence of the position of the original corner

C. Description of monument for corner and accessories established to perpetuate locating the position of the corner:

- A-11 Replaced 3/4" pipe with 5/8" rod, Bay Co. remon cap, mon box.
N.50°E. 49.50 nail & tag #18644 in tel pole, cut off.
N.20°W. 73.45 nail & tag #18644 in SW face P. pole.
S.37°E. 68.95 nail & tag in 8" Poplar.
S.21°E. 50.28 ctr. stop and St. sign post.
S.53°W 35.80 top ctr. S. end 16" C.M.P.

Signed by Ronald C. Prevost
Ronald C. Prevost

APPROVED LAND CORNER
P.A. 345 OF 1990 - Bay County
Date 24 Sept 98
MJM
Michael MacDonald P.S.
County Representative

Date 12-18-98

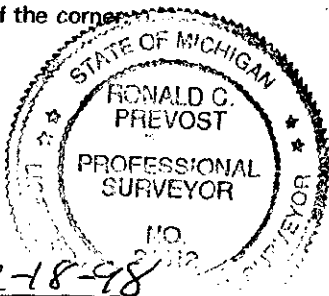

Surveyor's Michigan License No. 24612

REGISTER OF DEEDS
 BAY COUNTY, MICHIGAN
 1998 DEC 28 A 9:08
 Register of Deeds Stamp & File Number

RECORDED

| | | | | | | | | | | | | | |
|----|----|---|----|---|----|---|----|---|----|---|----|---|---|
| | A | B | C | D | E | F | G | H | I | J | K | L | M |
| 1 | | | | | | | | | | | | | |
| 2 | 6 | | 5 | | 4 | | 3 | | 2 | | 1 | | |
| 3 | | | | | | | | | | | | | |
| 4 | 7 | | 8 | | 9 | | 10 | | 11 | | 12 | | |
| 5 | | | | | | | | | | | | | |
| 6 | 18 | | 17 | | 16 | | 15 | | 14 | | 13 | | |
| 7 | | | | | | | | | | | | | |
| 8 | 19 | | 20 | | 21 | | 22 | | 23 | | 24 | | |
| 9 | | | | | | | | | | | | | |
| 10 | 30 | | 29 | | 28 | | 27 | | 26 | | 25 | | |
| 11 | | | | | | | | | | | | | |
| 12 | 31 | | 32 | | 33 | | 34 | | 35 | | 36 | | |
| 13 | | | | | | | | | | | | | |