

MAR 17 1999

LAND CORNER RECORDATION CERTIFICATE
Filing Requirement of Act 74, Mich. P.A. 1970

SECTION

For corners in

Table with columns: Bay (County), Located In: Mt. Forest Twp., Corner Code #. Rows include Public Land Survey, Property Controlling in Section, and Miscellaneous Property in Sec.

Barbara Towner
REGISTER OF DEEDS
BAY COUNTY, MICHIGAN

1998 DEC 28 A 9:08

RECORDED

Register of Deeds Stamp & File Number

4. Lot No. , Recorded Plat
5. Private Claims

I, Ronald C. Prevost, in a field survey on 6-23, 1998 do hereby state that under requirements of P.A. 74, Michigan P.A. of 1970, the corner points mentioned in lines 1 and 2 above were in conformance with regulations and rules therefore as required in the current manual of survey instructions of the United States Department of the Interior, Bureau of Land Management or by a decree of a Court of Law and for that the corner points mentioned in lines 3, 4 and 5 above were in conformance with the rules of the Michigan Board of Land Surveyors or by a Decree of a Court of Law; established, re-established, monumented, recovered, found as expressed below:

NOTE: Not more than 2 corners, all in the same town and range, may be recorded on this certificate.

Grid table with columns A-M and rows 1-13. Contains numbers 1-36 in a grid pattern.

A. Description of original monument and accessories and/or subsequent restoration:

A-12 Post set by D.S. H. Parke 1831. W Oak 26" S.73°W. 5 L. Hemlock 24" N.7°W. 35 L. Act 132 L1185, P65, McGinnis, 1991, 3/8" bar fnd. Act 132 L1185, P104, McGinnis, 1991, 3/8" bar fnd. LCRC recorded page 341, McGinnis 1992 3/8" bar fnd.

B. Description of corner evidence found and/or method applied in restoring or reestablishing corner:

A-12 Found 3/8" bar. From L1185, P65 & L1185, P104 & LCRC page 341 found & checked all 3 witnesses, all the same. West 34.5 nail W. side 24" Oak (ok). SW 34.25 nail in SE side 14" Elm. (34.27M). NW 46.4 nail in 4" Oak (46.45M).

Accepted as the best available evidence of the position of the original corner.

C. Description of monument for corner and accessories established to perpetuate locating the position of the corner:

A-12 Replaced 3/8" bar with 5/8" bar, with Bay Co. bronze remon cap. stamped #24612 set in mon horn. S.45°W. 34.27 nail in 16" Elm. N.83°W. 34.50 nail in 30" Oak. N.25°W. 46.45 nail in 6" Oak. N.85°E. 108.99 SW cor. metal pole barn.

APPROVED LAND CORNER
P.A. 345 OF 1990 - Bay County
Date 23 July 98
MJM
Michael MacDonald P.S.
County Representative

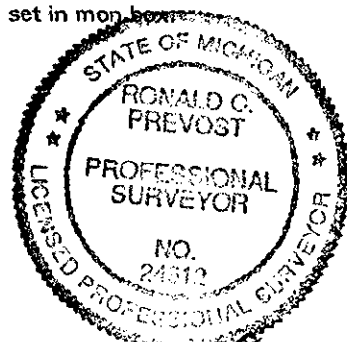

Signed by Ronald C. Prevost

Date 12-22-98

Surveyor's Michigan License No. 24612