

**BAY COUNTY REMONUMENTATION 1998  
LAND CORNER RECORDATION CERTIFICATE**  
Filing Requirement of Act 74, Mich. P.A. 1970

For corners in

<u>BAY</u> (County)	Located in:	Corner Code #
1. Public Land Survey	T <u>17N</u> R <u>3E</u>	<u>M-12</u> ✓
	T <u>17N</u> R <u>4E</u>	<u>A-12</u>
2. Property Controlling	S _____ T _____ R _____	_____
3. Miscellaneous	S _____ T _____ R _____	_____
Property in Sec.	S _____ T _____ R _____	_____

1999 JAN -5 A 9:06  
RECORDED  
BRIAN D FERGUSON  
REGISTER OF DEEDS  
BAY COUNTY, MICHIGAN  
Register of Deeds Stamp & File Number

4. Lot No. \_\_\_\_\_, Recorded Plat \_\_\_\_\_  
5. Private Claims \_\_\_\_\_

I, BRIAN D FERGUSON, in a field survey on OCTOBER, 19 98, do hereby state that under requirements of P.A. 74, Michigan P.A. of 1970, the corner points mentioned in lines 1 and 2 above were in conformance with regulations and rules therefore as required in the current manual of survey instructions of the United States Department of the Interior, Bureau of Land Management or by a decree of a Court of Law and/or that the corner points mentioned in lines 3, 4 and 5 above were in conformance with the rules of the Michigan Board of Land Surveyors or by a Decree of a Court of Law; established, re-established, monumented, recovered, found as expressed below:

NOTE: Not more than 2 corners, all in the same town and range, may be recorded on this certificate.

1	A	B	C	D	E	F	G	H	I	J	K	L	M
2	6	5	4	3	2								
3													
4	7	8	9	10	11	12							
5													
6	16	17	18	15	14	13							
7													
8	19	20	21	22	23	24							
9													
10	30	29	28	27	26	25							
11													
12	31	32	33	34	35	36							
13													

A. Description of original monument and accessories and/or subsequent restoration:

WOOD POST SET BY H. CLARKE IN 1831. NO EVIDENCE OF ORIGINAL CORNER REMAINS  
20" HEMLOCK N54W 32 LINKS AND 30" B. ASH SOUTH 28 LINKS  
COMMON WITH A-12, T17N-R4E  
LCRC (A-12) REC L 002, PG 521  
SURVEYS (M-12) REC L 740, PG 343 AND L 1150, PG 758

SURVEY &  
REMONUMENTATION  
MAR 17 1999  
SECTION

B. Description of corner evidence found and/or method applied in restoring or reestablishing corner:

FOUND 3/8" ROD NEXT TO PLOW POINT IN ROCK PILE  
AGREES WITH DISTANCE TO NORTH FROM SURVEY REC. AS 2637.30', MEA 2637.45'  
AGREES WITH DISTANCE TO SOUTH FROM SURVEY REC. AS 2633.62', MEA 2633.71'

ACCEPTED AS THE BEST AVAILABLE EVIDENCE OF THE LOCATION OF THE ORIGINAL CORNER

C. Description of monument for corner and accessories established to perpetuate locating the position of the corner:

SET 5/8" RE-BAR W / BAY COUNTY REMON. BRASS CAP & NO. 26454 IN MONUMENT BOX  
N90°E 31.89' TOP CTR TELE RISER - 32.5' REC  
N35°E 22.03' ROD W/CAP 26454  
S68°W 37.12' FCE STOP SIGN POST  
N40°W 67.95' NAIL & SHINNER SW FCE PWR POLE - 67.5' REC

APPROVED LAND CORNER  
P.A. 345 OF 1990 - Bay County  
Date 12 Nov 98  
MJM  
Michael MacDonald P.S.  
County Representative

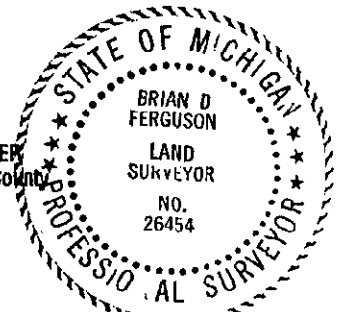

Signed by Brian D Ferguson  
Surveyor's Michigan License No. 16454

Date December 23, 1998