

3/27/09 2008

LAND CORNER RECORDATION CERTIFICATE

LIBER 2 PAGE 302

Filing Requirement of Act 74, Mich. PA 1970

SECTION

For Corners In:	Located In	Corner Code #
<u>BENZIE</u>		
(County)		
1. Public Land Survey	T <u>25N</u> R <u>14W</u>	<u>B-13</u>
	T _____ R _____	_____
2. Property Controlling in Section	S _____ T _____ R _____	_____
	S _____ T _____ R _____	_____
3. Miscellaneous Property in Section	S _____ T _____ R _____	_____
	S _____ T _____ R _____	_____
4. Lot No: _____	Recorded Plat: _____	
5. Private Claims: _____		

STATE OF MICHIGAN
BENZIE COUNTY
RECORDED

1 FEB 2000 1:52:26 PM
NICHELLE R. GRAY
REGISTER OF DEEDS
PAGES ONE

Register of Deeds Stamp & File Number

A	B	C	D	E	F	G	H	I	J	K	L	M
1												
2	6		6		4		3		2		1	
3												
4	7		8		9		10		11		12	
5												
6	18		17		16		15		14		13	
7												
8	19		20		21		22		23		24	
9												
10	30		29		28		27		26		25	
11												
12	31		32		33		34		35		36	
13												

I, John B. Smendzulk in a field survey on September 15, 1999 do hereby state that under requirements of PA 74, Michigan PA of 1970, the corner points mentioned in lines 1 and 2 above were in conformance with regulations and rules therefore as required in the current manual of survey instructions of the United States Department of the Interior, Bureau of Land Management or by a decree of a Court of Law and/or that the corner points mentioned in lines 3, 4 and 5 above were in conformance with the rules of the Michigan Board of Land Surveyors or by a Decree of a Court of Law; established, re-established, monumented, recovered, found as expressed below:

NOTE: Not more than 2 corners, all in the same town and range, may be recorded on this certificate.

A. Description of original monument and accessories and/or subsequent restoration:

1838: GLO set post and witnesses - 10" Beech N66°W 50 links and 7" Beech N70°E 23 links. 1911: Frank Haswell, Survey Record II, Page 116, shows break of East 1/2 of section 31 with numbers. Also shows he found old stake and drove 1" x 4' long iron pipe. 1964: BCRC records show they found a 1 1/4" iron pipe and their sketch shows that it is 6.7' North of centerline of road. Their records also showed that they had set a POT, a 3/4" iron south of the corner. This work was done prior to rebuilding the road in 1964 or 1965. 1969: Bill Batzer found the BCRC POT and used it for the section corner and witnessed it. 1974: Harold Bruning used BCRC POT. 1988 Max Harris did a section break of Section 31 and used the BCRC POT for the corner. 1996: Bruce Jenema, in a Certificate of Survey filed in Liber 76, page 2, shows he used BCRC POT.

B. Description of corner evidence found and/or method applies in restoring or re-establishing corner:

1999: Found the BCRC POT, a 3/4" iron rod which fits Batzer and Bruning witnesses. Also found railroad spike set 6.7' North of POT. After measuring to the railroad spike and checking with Max Harris section break and numbers from the Haswell work, we determined that if we held to the railroad spike, we would fit the Haswell distance to the Center of Section, which Haswell set and Max Harris found, within 0.15'. Max Harris measured 6.70' longer than Haswell to the 3/4" iron rod. Even though nobody has used the railroad spike as this position since 1969, the Benzie County Peer Group accepted the railroad spike as the perpetuation of the original GLO corner based on the records of Frank Haswell and findings of the BCRC.

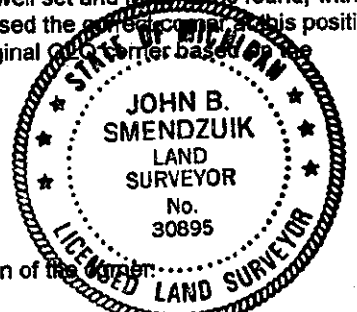

C. Description of monument for corner and accessories established to perpetuate locating the position of the corner:

Removed the railroad spike and set a standard 3" diameter Benzie County Remonumentation Program concrete monument with a brass cap in a monument box.

- 14" Maple N50°W 55.79' to a set new nail and BCRP tag.
- 4" Maple N48°E 47.05' to a found double headed nail and washer.
- 11" Aspen S03°W 70.21' to a found double headed nail and washer.
- 8" Ash S57°W 77.10' to a found double headed nail and washer.
- BCRC POT, 3/4" iron rod, is South 6.70'.

Ratified by Peer Group
In accordance with P.A. 345
Chairman [Signature]
Date 9/14/99

Corner is 6.5' North of the existing centerline of North Manistee County Line Road.

Signed by: [Signature]
Surveyor's Michigan License No.: 30895

Date: 1/31/2000