

MAY 7 5 1999

SECTION

LAND CORNER RECORDATION CERTIFICATE
Filing Requirement of Act 74, Mich. P.A. 1970

LIBER 2 PAGE 180

For corners in Almira Township

BENZIE _____ (County)	Located In:	Corner Code #
1. Public Land Survey	T27N R13W	E-9
	T _____ R _____	_____
	T _____ R _____	_____
2. Property Controlling in Section	S _____ T _____ R _____	_____
	S _____ T _____ R _____	_____
3. Miscellaneous Property in Sec.	S _____ T _____ R _____	_____
	S _____ T _____ R _____	_____
4. Lot No. _____, Recorded Plat _____		
5. Private Claims _____		

STATE OF MICHIGAN
BENZIE COUNTY
RECORDED

7 JAN 1999 4:05:17 PM
MICHELLE R. GRAY
REGISTER OF DEEDS
PAGES One

Register of Deeds Stamp & File Number

I, JOHN F. KORR, JR., in a field survey on December 11, 1998, do hereby certify that under requirements of P.A. 74, Michigan P.A. of 1970, the corner points mentioned in lines 1 and 2 above were in conformance with regulations and rules therefore as required in the current manual of survey instructions of the United States Department of the Interior, Bureau of Land Management or by a decree of a Court of Law and/or that the corner points mentioned in lines 3, 4 and 5 above were in conformance with the rules of the Michigan Board of Land Surveyors or by a Decree of a Court of Law, established, re-established, monumented, re-monumented, recovered, found as expressed below:

NOTE: Not more than 4 corners, all in the same town and range, may be recorded on this certificate.

A. Description of original monument and accessories and/or subsequent restoration:

July 1850 GLO - Survey - Set post for corner with two Witnesses: S44°W - 46.98' - W. Pine 14"; N40°E - 13.86' or 15.18' - Aspen 10".

July 1975 - Wm. B. Batzer (survey L. 1, P. 415) and (LCRC L. 1, P. 118) J# 7593, found a 3/8" iron rod for work in Section 20; 3 Witnesses: S28°E - 13.52' - Cherry 10"; S82°W - 42.75' - Maple 10"; N6°W - 60.41' - W. Pine 24".

June 1976 - Wm. B. Batzer J # 7593, found 3/8" iron rod, same witnesses as in LCRC from 1975;

1977 - Carl Roser (DNR) during a temporary survey found 1/2" iron 3' North of E-W road centerline and in Centerline of road to South, Survey not final or completed.

June 1978 - Wm. B. Batzer (survey L. 1, P. 611) J # 7851, found 3/8" iron rod, same witnesses as in LCRC from 1975; S82°W - 42.73' - Maple 6"; N6°W - 60.43' - W. Pine 24"; S25°E - 13.53' - Cherry 18"; also Found new iron rod N6°30'00"W - 9.42'.

December 1979 - Corey Hughes, found both the Batzer corner as per LCRC 1975 and Carl Roser iron per his 1977 notes. Survey was for work in Section 22 J. # 79547.

April 1988 - Max Harris J. # 88-4-1988, certificate of survey tied to corner No. I.D. stated, for work in Section 29.

B. Description of corner evidence found and/or method applied in restoring or reestablishing corner:

December 1998 - I found the 1/2" iron rod as recorded by Wm. B. Batzer 2.5 feet East of a fence line running to the North & 11.5 feet south of the E-W centerline of Fogg Road. This corner is also 2 feet West of the centerline of Hulbert Road running South. The other corner as called for by Batzer in 1978, the corner called for by Carl Roser was not present and no other evidence was found. I found 1 witness by Batzer: 26" W. Pine - N06°W - 60.43' and also witnesses: 14" Oak - S84°W - 42.73'; 20" W. Pine - N18°W - 54.97'; p.p. - S45°E - 72.34'. I Accepted this corner with lack of any other evidence as a locally used and accepted corner.

C. Description of monument for corner and accessories established to perpetuate locating the position of the corner:

At the position of E-9, I set a Standard Benzie Co. Remonumentation Monument, witnessed by the following:

- 26" W. Pine - N06°W - 60.43'
- 14" Oak - S84°W - 42.73'
- 20" W. Pine - N18°W - 54.97'
- p.p. - S45°E - 72.34'

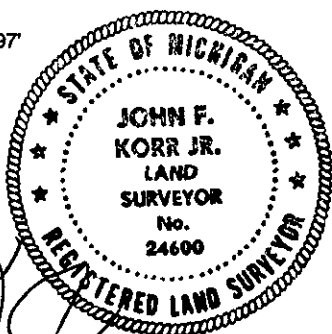

Ratified by Peer Group
In accordance with (P.A.) 345
Chairman: [Signature]
Date: 11/24/98

Signed by [Signature]
JOHN F. KORR, JR.
Surveyor's Michigan License No. 24600

Date 12/29/98

	A	B	C	D	E	F	G	H	I	J	K	L	M
1													
2	6		5		4		3		2		1		
3													
4	7		8		9		10		11		12		
5													
6	18		17		16		15		14		13		
7													
8	19		20		21		22		23		24		
9					●								
10	30		29		28		27		26		25		
11													
12	31		32		33		34		35		36		
13													