

LAND CORNER RECORDATION CERTIFICATE
Filing Requirement of Act 74, Mich. P.A. 1970

For corners in

<u>Benize</u> <small>(County)</small>	Located In:	Corner Code #
1. Public Land Survey	T <u>27N</u> R <u>14W</u>	<u>F10</u>
	T _____ R _____	_____
	T _____ R _____	_____
2. Property Controlling in Section	S <u>28</u> T <u>27N</u> R <u>14W</u>	<u>8</u>
	S _____ T _____ R _____	_____
3. Miscellaneous Property in Sec.	S _____ T _____ R _____	_____
	S _____ T _____ R _____	_____

Register of Deeds Stamp & File Number

4. Lot No. _____, Recorded Plat _____

5. Private Claims _____

I, Carl Kiiskila, in a field survey on July 19 96 do hereby state that under requirements of P.A. 74, Michigan P.A. of 1970, the corner points mentioned in lines 1 and 2 above were in conformance with regulations and rules therefore as required in the current manual of survey instructions of the United States Department of the Interior, Bureau of Land Management or by a decree of a Court of Law and /or that the corner points mentioned in lines 3, 4 and 5 above were in conformance with the rules of the Michigan Board of Land Surveyors or by a Decree of a Court of Law; established, re-established, monumented, recovered, found as expressed below:

A	B	C	D	E	F	G	H	I	J	K	L	M
1												
2	6		5		4		3		2		1	
3												
4	7		8		9		10		11		12	
5												
6	18		17		16		15		14		13	
7												
8	19		20		21		22		23		24	
9												
10	30		29		28		27		26		25	
11												
12	31		32		33		34		35		36	
13												

NOTE: Not more than 2 corners, all in the same town and range, may be recorded on this certificate.

A. Description of original monument and accessories and/or subsequent restoration:

F-10 - None. B - None.

B. Description of corner evidence found and/or method applied in restoring or reestablishing corner:

<u>F-10</u> - Center 1/4 Sec. 28 - Set 5/8" x 34" Rebar with PS cap and Carsonite Guard Post per Standard BLM procedure at inter. of 1/4 lines. Old fence remains s'ly is 36' ± 3' W.	<u>B</u> - C-W 1/16 Sec. 28 - Set 5/8" x 34" Rebar with PS Cap with Carsonite Guard Post per Standard BLM procedure.
---------------------------------------------------------------------------------------------------------------------------------------------------------------------------------------	----------------------------------------------------------------------------------------------------------------------

C. Description of monument for corner and accessories established to perpetuate locating the position of the corner:

<u>F-10</u> - Mon. per Part 'B' 11" S. Maple N10°W 3.5' 12" S. Maple N55°E 6.2' 8" S. Maple S 30°E 11.7' 12" S. Maple S30°W 16.2'	<u>B</u> - Mon. per Part 'B' 4" Ironwood N20°W 19.3' 5" Beech N15°E 6.5' 8" R. Pine S15°E 12.4' 7" Beech S75°W 18.9' FND. 3/4" Galv. Pipe N7° 03'E 15.15'
-----------------------------------------------------------------------------------------------------------------------------------------------	--------------------------------------------------------------------------------------------------------------------------------------------------------------------------

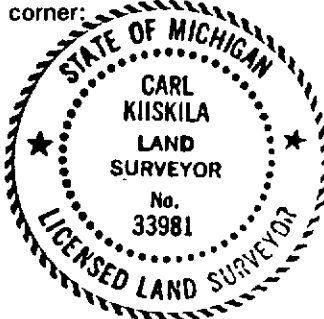

Signed by Carl T. Kiiskila
 Surveyor's Michigan License No. 33981

Date 9-17-98