

FEB 17 1994

COMMISSION

12/29/93
12/29/93

111#5225 A66
CORNER \$7.00
111#5225 A66
STATE REMON FEE \$2.00

BERRIEN CO. REMONUMENTATION
LAND CORNER RECORDATION CERTIFICATE
Filing Requirement of Act 74, Mich. P.A. 1970

RECORDED

For corners in
Berrien

(County)	Located In:	Corner Code #
1. Public Land Survey	T <u>3S</u> R <u>18W</u>	<u>I-6</u>
	T _____ R _____	_____
	T _____ R _____	_____
	T _____ R _____	_____
2. Property Controlling in Section	S _____ T _____ R _____	_____
	S _____ T _____ R _____	_____
3. Miscellaneous Property in Sec.	S _____ T _____ R _____	_____
	S _____ T _____ R _____	_____
4. Lot No. _____, Recorded Plat _____		
5. Private Claims _____		

DEC 29 12 30 PM '93

Benjamin Fralson
REGISTER OF DEEDS
BERRIEN COUNTY MICHIGAN

Register of Deeds Stamp & File Number

I, Donald R. Pitts, Jr. in a field survey on 8 December, 19 93, do hereby certify that under requirements of P.A. 74, Michigan P.A. of 1970, the corner points mentioned in lines 1 and 2 above were in conformance with regulations and rules therefore as required in the current manual of survey instructions of the United States Department of the Interior, Bureau of Land Management or by a decree of a Court of Law and/or that the corner points mentioned in lines 3, 4 and 5 above were in conformance with the rules of the Michigan Board of Land Surveyors or by a Decree of a Court of Law; established, re-established, monumented, re-monumented, recovered, found as expressed below:

	A	B	C	D	E	F	G	H	I	J	K	L	M
2	6	5	4	3	2	1							
3													
4	7	8	9	10	11	12							
5													
6	18	17	16	15	14								
7													
8	19	20	21	22	23	24							
9													
10	30	29	28	27	26	25							
11													
12	31	32	33	34	35	36							
13													

NOTE: Not more than 4 corners, all in the same town and range, may be recorded on this certificate.

- A. Description of original monument and accessories and/or subsequent restoration:
I-6 Center of Section 13, T3S, R18W
 1923 Notes from V.J. Strebs - Iron
 1948-1960 Berrien Co. Rd. Comm - Stone
 1953 Wightman & Assoc - Stone
 1973 A.W. Howard - Iron Pipe 1966, P715
 1986 Pierce & Assoc. - Stone, unrecorded Survey, Berrien Co. Land Desc. Office
 1987 J.G. Kamer, Wightman & Assocs. - Stone
 1992 D.R. Pitts, Jr. Abonmarche Consultants, Inc. - Stone

- B. Description of corner evidence found and/or method applied in restoring or reestablishing corner:
I-6 Center of Section 13, T3S, R18W
 Found Pointed Stone, This Position not established by original Government surveyors. This monument is accepted as the best available evidence of the position of the corner, and ratified by The Berrien County Remonumentation Program Peer Group on December 8, 1993.

- C. Description of monument for corner and accessories established to perpetuate locating the position of the corner:
I-6 Center of Section 13, T3S, R18W
 4" Dia X 36" Long Concrete Monument with Berrien Co. Remon Brass Cap.
 Nail & Wit Tag N. Side 18" Twin Maple S80°W 11.39'
 Nail & Wit Tag E. Side 10" Apple N5°W 39.13'
 Nail & Wit Tag E. Side 14" Maple S30°W 41.08'
 Nail & Wit Tag N. Side 6" Ash S34°E 32.64'

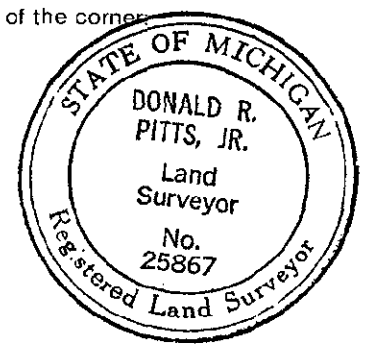

Signed by Donald R. Pitts, Jr. Date 20 December 1993
Surveyor's Michigan License No. 25867