

RECORDED

RAITIED BY THE BERRIEN COUNTY SURVEY PEER GROUP AS THE OFFICIAL CORNER UNDER MICHIGAN PUBLIC ACT 345 OF 1990

Berrien County Remonumentation Program LAND CORNER RECORDATION CERTIFICATE

00 NOV -8 PM 12: 51

BRADICE TRETNEYWAY REGISTER OF DEEDS BERRIEN COUNTY, MICHIGAN

Handwritten signature and amount \$22.00

Filing Requirement of Act 74, Mich. P.A. 1970

For corners in

Table with columns: Berrien (County), Located In:, Corner Code #. Rows include Public Land Survey, Property Controlling in Section, and Miscellaneous Property in Sec.

11/08/00 111#6048 A66 CORNER \$7.00 11/08/00 111#6048 A66 STATE REMON FEE \$2.00

Register of Deeds Stamp & File Number

4. Lot No. _____, Recorded Plat _____ 5. Private Claims _____

Grid table with columns A-M and rows 1-13. A dot is marked in cell C-1.

I, Alan K. Bartlett, in a field survey on March 29, 2000, do hereby state that under requirements of P.A. 74, Michigan P.A. of 1970, the corner points mentioned in lines 1 and 2 above were in conformance with regulations and rules therefore as required in the current manual of survey instructions of the United States Department of the Interior, Bureau of Land Management or by a decree of a Court of Law and /or that the corner points mentioned in lines 3, 4 and 5 above were in conformance with the rules of the Michigan Board of Land Surveyors or by a Decree of a Court of Law; established, re-established, monumented, recovered, found as expressed below:

NOTE: Not more than 2 corners, all in the same town and range, may be recorded on this certificate.

A. Description of original monument and accessories and/or subsequent restoration:

- GLO- JOHN MULLETT: NORTH BETWEEN SECTIONS 5 AND 6 79.63 CHAINS FROM THE INTERSECTION OF THE NORTH BOUNDARY 27 CHAINS WEST OF POST SET POST CORNER TO SECTIONS 5 AND 6. S17°W 10 LINKS 7" BEECH, S58°E 37 LINKS 7" WHITE ASH
1972- ALTON HOWARD RLS #2382; RECORDED SURVEY LIBER 925, PAGE 522 1/4" REROD. WITNESSES: S85°E 28.35' PK NAIL IN 8" POLE, S45°W 51.0' PK NAIL IN 8" POLE, N45°W 27.28' PK NAIL IN 8" PEAR TREE
1973- 1972- ALTON HOWARD RLS #2382; RECORDED SURVEY, LIBER 936, PAGE 570 MEASURED 2615.30' FOR 1/2 MILE DISTANCE FROM C-1 TO B-1. WITNESSES: : S85°E 28.35' PK NAIL IN 8" POLE, S45°W 51.0' PK NAIL IN 8" POLE, N45°W 27.28' PK NAIL IN 8" PEAR TREE
1980- E.R. STEFAN RLS #13599; PK NAIL FROM UNRECORDED SURVEY. WITNESSES: N85°E 27.82' FACE OF POWER POLE, EAST 17.82' STONE (SE CORNER OF SECTION 31-T4S-R17W), S30°W 51.05' FACE OF POWER POLE.
1981- V.J. STREBS RLS #26469; P.K. NAIL ESTABLISHED FROM EXISTING SE CORNER OF SECTION 31-T4S-R17W. WITNESSES: STONE (SE CORNER OF SECTION 31-T4S-R17W), S30°W 51.05' FACE OF POWER POLE.
1997- JOHN KAMER RLS #27449; FOUND REBAR FROM UNRECORDED SURVEY. WITNESSES: S32°W 28.35' PK IN POWER POLE, N60°W 27.26' PK IN 13" PEAR; FOUND 1/2" IRON OVER STONE (SW CORNER OF SECTION 32-T4S-R17W) WITNESSESEAST 18.13' TO IRON, EAST 17.94' TO STONE. 1/2 MILE DISTANCE OF 2607.29' FROM C-1 TO C-2.

B. Description of corner evidence found and/or method applied in restoring or reestablishing corner: FOUND IRON PIPE IN PAVEMENT, 5' WEST OF CENTERLINE. THIS CORNER APPROVED BY THE BERRIEN COUNTY REMONUMENTATION PEER GROUP OF SURVEYORS

C. Description of monument for corner and accessories established to perpetuate locating the position of the corner: SET 3' STEEL PIPE WITH BERRIEN COUNTY BRASS CAP (MARKED 2000 & 35988) IN MON BOX. THIS POSITION IS ACCEPTED AS A CAREFUL AND FAITHFUL PERPETUATION OF THE POSITION OF THE ORIGINAL CORNER.

Witnesses: N80°E 28.37' POWER POLE EAST 17.82' C-13 SE CORNER OF SECTION 31-T5S-R17W. S75°W 55.15' POWER POLE WEST 14.84' REBAR WITH CAP WEST 20.35' TELEPHONE RISER

Signed by Alan K. Bartlett Date 11/02/2000

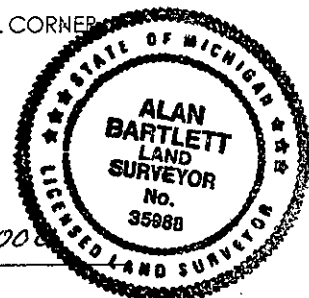

Surveyor's Michigan License No. 35988

SURVEY & REMONUMENTATION

FORM APPROVED BY MICHIGAN STATE BOARD OF PROFESSIONAL SURVEYORS, JAN. 28, 1971 REVISED MAY 14, 1975 REVISED JAN., 1983 REVISED OCT. 1988

JAN 31 2001

LIBER 4 PAGE 242

SECTION