

**SURVEY &
REMONUMENTATION**

APR 26 1995

RECORDED

RATIFIED BY THE BERRIEN COUNTY
SURVEY PEER GROUP AS THE
OFFICIAL CORNER UNDER MICHIGAN
PUBLIC ACT 345 OF 1990

**COMMISSION
REMONUMENTATION
LAND CORNER RECORDATION CERTIFICATE**
Filing Requirement of Act 74, Mich. P.A. 1970

NOV 23 3 06 PM '94

Bernice Trahaney
REGISTER OF DEEDS
BERRIEN COUNTY MICHIGAN

For corners in
BERRIEN
(County)

Located In: _____ Corner Code =# _____

1. Public Land Survey	T <u>5S</u> R <u>17W</u>	<u>K-1</u>
	T _____ R _____	_____
	T _____ R _____	_____
	T _____ R _____	_____
2. Property Controlling in Section	S _____ T _____ R _____	_____
	S _____ T _____ R _____	_____
3. Miscellaneous Property in Sec.	S _____ T _____ R _____	_____
	S _____ T _____ R _____	_____

Register of Deeds Stamp & File Number

4. Lot No. _____, Recorded Plat _____
5. Private Claims _____

	A	B	C	D	E	F	G	H	I	J	K	L	M
2	6	5	4	3	2	1							
3													
4	7	8	9	10	11	12							
5													
6	18	17	16	15	14	13							
7													
8	19	20	21	22	23	24							
9													
10	30	29	28	27	26	25							
11													
12	31	32	33	34	35	36							
13													

I, V.J. Strebs, in a field survey on November 15, 19 94, do hereby certify that under requirements of P.A. 74, Michigan P.A. of 1970, the corner points mentioned in lines 1 and 2 above were in conformance with regulations and rules therefore as required in the current manual of survey instructions of the United States Department of the Interior, Bureau of Land Management, or by a decree of a Court of Law and/or that the corner points mentioned in lines 3, 4 and 5 above were in conformance with the rules of the Michigan Board of Land Surveyors or by a Decree of a Court of Law; established, re-established, monumented, re-monumented, recovered, found as expressed below:

NOTE: Not more than 4 corners, all in the same town and range, may be recorded on this certificate.

A. Description of original monument and accessories and/or subsequent restoration:

1830 - William Brookfield (set post)
30 Links East of Corner for
Secs. 35 & 36 - 4-17
Beech 7 - S46°W - 10 links
Beech 6 - S70½°E - 27 links
1976 - E.R. Stefan (iron rod)

Wightman & Associates
(1" iron rod in mon. box)
P.K. nail in fence post - north - 27.92
P.K. nail in fence post - N45°E - 50.03
N.W. corner of Barn - S15°E - 85.60

B. Description of corner evidence found and/or method applied in restoring or reestablishing corner:

Fnd 3/4" Bar in monument box corner on Township line

11/23/94	111#7594	A66
	CORNER	\$7.00
11/23/94	111#7594	A66
	STATE REMON FEE	\$2.00

C. Description of monument for corner and accessories established to perpetuate locating the position of the corner:

This monument is accepted as a careful and faithful perpetuation of the position of the original corner.

Set 1"x3 ft. Iron pipe w/B.C.R.P. Brass cap in monument box
Nail & Witness tag in fence post - N02°E - 27.95'
Nail & Witness tag in fence post - N30°W - 31.91'
Nail & Witness tag in 8" Maple - S10°W - 26.02'
B.C.R.P. Brass cap in mon. box (S.E. Cor. Sec 35-4-17)-West - 19.75'

Signed by *V.J. Strebs*
Surveyor's Michigan License No. 26469

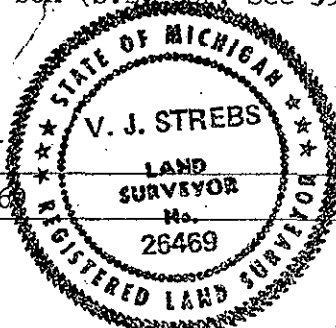

Date 21 NOVEMBER 1994