

MAINTAINED BY THE BERRIEN COUNTY
SURVEY SEER GROUP AS THE
OFFICIAL CORNER UNDER MICHIGAN
PUBLIC ACT 145 OF 1990

RECORDED

**REMONUMENTATION
LAND CORNER RECORDATION CERTIFICATE**
Filing Requirement of Act 74, Mich. P.A. 1970

Dec 26 11 46 AM '96

Daniel B. Zwar
10-24-96

Berrien County
REGISTER OF DEEDS
BERRIEN COUNTY, MICHIGAN

For corners in

BERRIEN Located In: _____ Corner Code # _____
(County) NW corner, Section 2 - Sodus Township

1. Public Land Survey T 5S R 18W I-1
T _____ R _____
T _____ R _____
T _____ R _____
2. Property Controlling S _____ T _____ R _____
in Section S _____ T _____ R _____
3. Miscellaneous S _____ T _____ R _____
Property in Sec. S _____ T _____ R _____
4. Lot No. _____, Recorded Plat _____
5. Private Claims _____

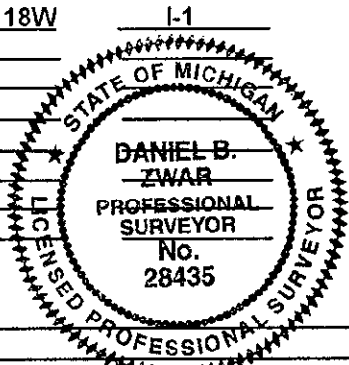

12/26/96 111#9870 A99
Register of Deeds Stamp & File Number \$7.00
12/26/96 111#9870 A99
STATE REMON FEE \$2.00

I, DANIEL B. ZWAR, in a field survey on NOVEMBER 19, 19 96, do hereby state that under requirements of P.A. 74, Michigan P.A. of 1970, the corner points mentioned in lines 1 and 2 above were in conformance with regulations and rules therefore as required in the current manual of survey instructions of the United States Department of the Interior, Bureau of Land Management or by a decree of a Court of Law and /or that the corner points mentioned in lines 3, 4 and 5 above were in conformance with the rules of the Michigan Board of Land Surveyors or by a Decree of a Court of Law; established, re-established, monumented, recovered, found as expressed below:

NOTE: Not more than 2 corners, all in the same town and range, may be recorded on this certificate.

	A	B	C	D	E	F	G	H	I	J	K	L	M
1													
2	6		5		4		3		2		1		
3													
4	7		8		9		10		11		12		
5													
6	13		17		16		15		14		13		
7													
8	19		20		21		22		23		24		
9													
10	30		29		28		27		26		25		
11													
12	31		32		33		34		35		36		
13													

A. Description of original monument and accessories and/or subsequent restoration:

- 1830 - JOHN MULLET, D.S. - BOOK 1, PAGE 438; NORTH BETWEEN SECTIONS 2 & 3, 40.00 CHAINS; SET POST 1/4 SECTION CORNER - 80.21 CHAINS; INTERSECTED NORTH BOUNDARY - 26 LINKS EAST OF POST (SW CORN SEC 35 - 4 - 18); SET POST CORNER TO SECTIONS 2 & 3 - 8" BEECH S 45° W - 35 LNKS & 7" BEECH S 70° E 36 LNKS
- ±1900 - ?; STONE
- 1952 - J. DEWEY?; IRON; SHOWS 17.16' JOG
- 1977 - WIGHTMAN & ASSOC.; 1" IRON ROD IN MON BOX; MON BOX WEST 17.14'; GRAPE POST SOUTH 52.33; CORNER GRAPE POST S45°W 53.99'
- 1981 - J. KAMER; L.C.R.C. L 2 / P 373; 1" IRON ROD IN MON BOX; MON BOX WEST 17.14'; GRAPE POST SOUTH 52.33; CORNER GRAPE POST S45°W 53.99'
- 1981 - V.J. STREBS; L.C.R.C. L.1 / P 357; 3/4" IRON BAR IN MON BOX; NE CORN SEC 3 - 5 - 18 EAST 17.15'; NAIL IN POST S25°W 47.6'; NAIL IN POST S20°E 54.5'
- 1986 - J. KAMER; 1" IP IN MON BOX; IP IN MON BOX WEST 17.12'; PK IN 12" BIRCH N30°W 30.73'; PK IN GRAPE POST S 51.80'
- 1993 - D. PITTS; 1" IRON BAR IN MON BOX

B. Description of corner evidence found and/or method applied in restoring or reestablishing corner:

ORIGINAL WITNESSES ARE GONE. FOUND 3/4" IRON BAR IN MON BOX. SW CORN SEC 35 - 4 - 18 PRESENT 17.18' WEST. STRADDLED BAR AND PULLED IT, FOUND IT TO BE 36" LONG. FURTHER EXCAVATION FOR STONE YIELDED NOTHING. THE LOCATION OF THIS BAR IS ACCEPTED AS THE BEST AVAILABLE EVIDENCE OF THE POSITION OF THE ORIGINAL CORNER.

C. Description of monument for corner and accessories established to perpetuate locating the position of the corner:

PLACED STANDARD 36" X 1" IRON PIPE WITH B.C.R.P. BRASS CAP IN MON BOX TO STRADDLES OF BAR. WITNESSES: S.W. CORNER BLOCK BLDG. N 50° W 77.35'; NAIL W/ TAG IN 15" MAPLE N 75° W 56.28'; 3/4" IRON PIPE W/ KAMER CAP N 05° E 33.34'; SW CORNER SECTION 35 - 4 - 18 W 17.18' (LIKE CONSTITUTION)

Signed by *Daniel B. Zwar*
Surveyor's Michigan License No. 28435

Date *Dec 18, 1996*

REMONUMENTATION

FORM APPROVED BY MICHIGAN STATE BOARD OF PROFESSIONAL SURVEYORS, JAN 28, 1971
REVISED MAY 14, 1975
REVISED JAN, 1983
REVISED OCT., 1996

MAY 20 1997

COMMISSION

11RFR

3 PAGE 406